

BTNX COVID-19 Rapid Test

YOUR TESTING KIT CONTAINS:

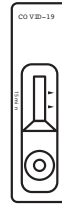
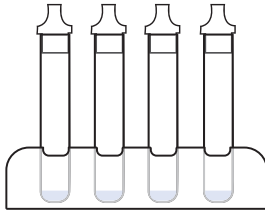

Nasal Swab

Test Tube

Buffer Liquid

Tube Stand

Test Cartridge

YOU WILL NEED:

- A clean, level surface
- Hand sanitizer
- A timer or clock

For better accuracy of the test, we recommend swabbing the throat, cheeks AND nostrils using the same swab. If you are unable to follow these instructions, only swab your nostril (throat or cheek swabs alone will not give accurate results).

BEFORE YOU START

- Bring all testing materials to room temperature (18-30°C) before use.
- Wash your hands.
- Clean your work surface.
- Open the contents of your testing kit.
- Remove the test cartridge from the wrapper.
- Write your name on the cartridge if testing more than one person.

STEP 1

- Place the collection tube into the tube stand so it stands upright.
- Add entire contents of 1 single use testing buffer solution into the test tube.

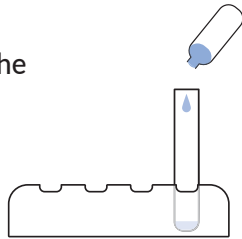

STEP 2

- Open your mouth.
- Without touching your teeth, rub the swab between your cheeks and lower gums on one side and then the other (at least 5 times on each side).
- Then, tilt your head back and use the same swab to rub the back of your throat 5 times back and forth (this may cause some people to gag; this is not harmful).

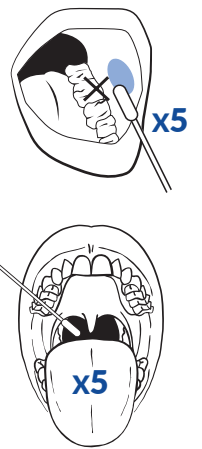

STEP 3

- Using the same swab, insert the swab into your nostril approximately 2 cm.
- Rub and rotate the swab 5 times around and repeat for the other nostril using the same swab.

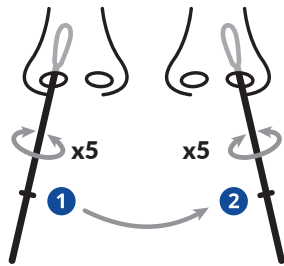

STEP 4

- Immerse swab tip into liquid in the test tube, swirling and stirring the swab for 10 seconds.
- Squeeze the swab 10-15 times by pinching the tube against the swab.
- Keep swab immersed in the liquid and let stand for 2 minutes in the tube stand.

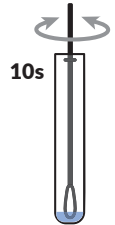

STEP 5

- Remove swab from test tube while squeezing out remaining liquid.
- Attach nozzle to the test tube and gently squeeze 3 drops into the round well of the test cartridge.

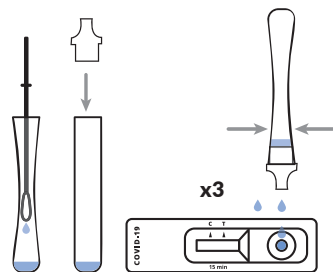

STEP 6

- Set a timer for 15 minutes. After 15 minutes, a coloured line will show in the result window.
- When finished, properly dispose of the testing supplies, sanitize your hands, and clean your testing space.

NEGATIVE RESULT

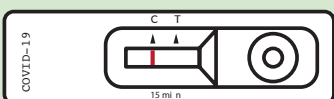

One line at the C mark. No line at the T mark. Continue your testing schedule.

POSITIVE RESULT

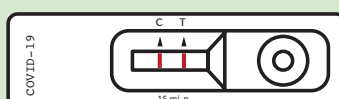

Two lines. One line at the C mark and one line at the T mark. Immediately self-isolate and visit the COVID-19 Referral and Assessment application to determine if you need a lab-based test and to report your positive result. Do not contact 811 unless you do not have internet access.

INVALID RESULT

If your test result does not match either the **Negative or Positive** examples, the test may not have worked. Re-test until you receive a positive or negative test result.