



THE NEWFOUNDLAND AND LABRADOR GAZETTE

PART I

PUBLISHED BY AUTHORITY

Vol. 82

ST. JOHN'S, FRIDAY, September 28, 2007

No. 39

MENTAL HEALTH CARE AND TREATMENT ACT

ORDER

Order of the Minister of Health and Community Services

Designation of Facilities under subsection 4(1) of the *Mental Health Care and Treatment Act*, SNL 2006, c. M-9.1.

Under the authority of subsection 4(1) of the *Mental Health Care and Treatment Act*, SNL 2006, c. M-9.1, I designate the following facilities as psychiatric units for the purposes of the Act:

Western Memorial Regional Hospital, Corner Brook

Central Newfoundland Regional Health Centre,
Grand-Falls Windsor

Waterford Hospital, St. John's

General Hospital, Health Sciences Center, St. John's

Dated at St. John's this 25th day of September, 2007.

ROSS WISEMAN
Minister

Sept 28

QUIETING OF TITLES ACT

2007 06T 0106

IN THE SUPREME COURT OF NEWFOUNDLAND AND LABRADOR TRIAL DIVISION

Notice of Application under the *Quieting of Titles Act*, c. Q-3, RSNL 1990

Notice is hereby given to all parties that Stacy Gerald MacDonald of the Town of Clarenville, in the District of Trinity North, in the Province of Newfoundland and Labrador, has applied to the Supreme Court, Trial Division, Grand Bank, to have title to all that piece or parcel of property situate at Tickle Cove, in the Province of Newfoundland and Labrador, which property is more particularly described in Schedule "A" hereto annexed and shown in Schedule "B" hereto annexed.

ALL BEARINGS aforementioned for which Stacy Gerald MacDonald claims to be the owner investigated and for a Declaration that he is the absolute owner in fee simple in possession and the said Stacy Gerald MacDonald has been ordered to public Notice of Application as required by the above named Act.

All persons having title adverse to the said title claimed by the said Stacy Gerald MacDonald shall file in the Registry of the Supreme Court of Newfoundland and Labrador, Trial Division, Grand Bank, particulars of such adverse claim and

serve the same together with an Affidavit verifying same on the undersigned Solicitors for the Petitioner on or before the 15th day of October, 2007, after which date no party having any claim shall be permitted to file the same or to be heard except by special leave of the Court and subject to such conditions as the Court may deem just.

All such adverse claims shall be investigated then in such manner as the Supreme Court of Newfoundland and Labrador, Trial Division, Grand Bank, may direct.

DATED AT Clarenville, in the Province of Newfoundland and Labrador, this 17th day of September, 2007.

HUGHES AND BRANNAN
Solicitors for the Applicant
Per: James Hughes

ADDRESS FOR SERVICE:
357 Memorial Drive
Clarenville, NL
A5A 1R8

Tel: 709-466-3106
Fax: 709-466-4383

Sept 28

SCHEDULE "A"

Stacy MacDonald
Tickle Cove, NL
Job No. 07-026-1

ALL THAT piece or parcel of land situate at Tickel Cove, in the Electoral District of Bonavista South, in the Province of Newfoundland and Labrador, abutted and bounded as follows, that is to say:

BEGINNING at a point, the said point being distant (426.077) metres, as measured on a bearing of north (15) degrees (02) minutes (17) seconds east from Coordinate Monument No. 86G6042;

THENCE running by Crown land, south (70) degrees (54) minutes (09) seconds west, a distance of (58.424) meters;

THENCE running by a Local Road, following a curve with a radius of (67.954) metres, for an arc distance of (22.468) meters to a point being distant (22.366) metres, as measured on a bearing of north (00) degrees (59) minutes (12) seconds east from the previously described point;

THENCE following a curve with a radius of (20.000) meters, for an arc distance of (15.620) metres to a point being distant (15.226) meters, as measured on a bearing of north (30) degrees (51) minutes (35) seconds west from the previously described point;

THENCE north (53) degrees (14) minutes (03) seconds west, a distance of (12.708) meters;

THENCE running by an old path, north (61) degrees (34) minutes (09) seconds east, a distance of (12.785) meters;

THENCE north (76) degrees (02) minutes (57) seconds east, a distance of (64.502) metres;

THENCE running by Crown land, south (01) degrees (17) minutes (39) seconds west, a distance of (45.573) metres, more or less, to the point of beginning and being more particularly shown and on the attached plan;

CONTAINING an area of (0.286) Hectares, more or less;

ALL BEARINGS being referred to the meridian of (53) degrees west longitude of the Three Degree Transverse Mercator Projection. (NAD83)

SCHEDULE "B"

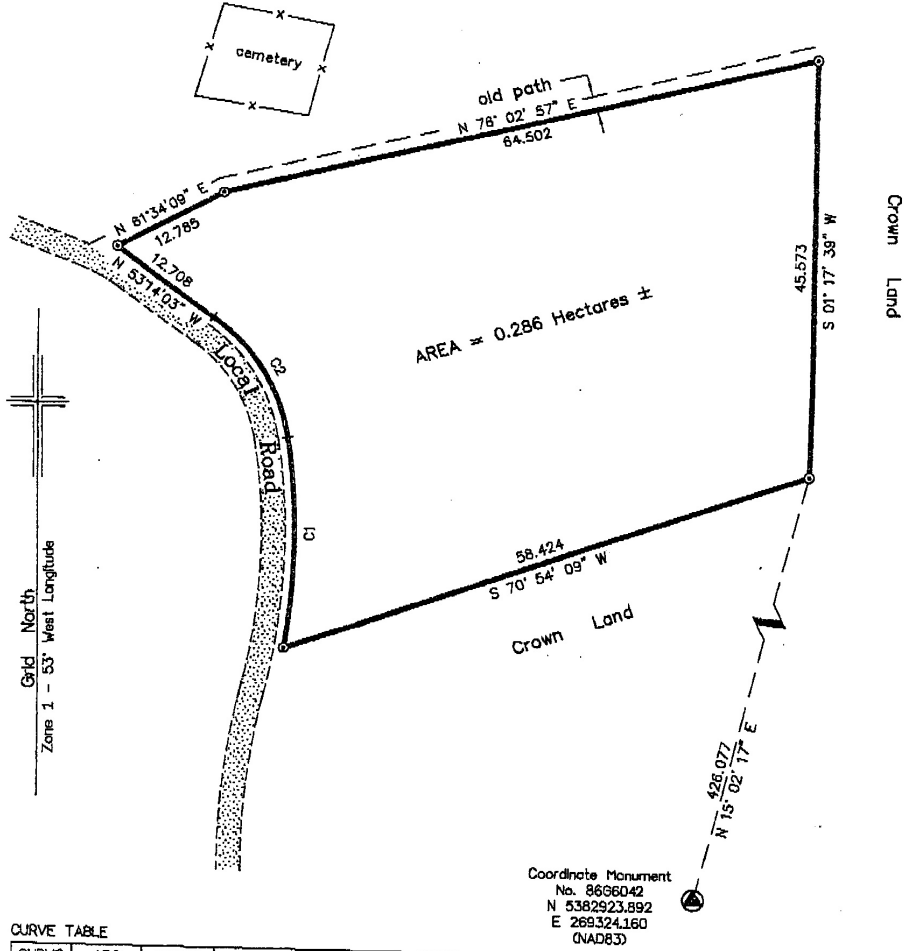

Grid North
Zone 1 - 53° West Longitude

CURVE TABLE

CURVE	ARC	RADIUS	CHORD BEARING	CHORD DIST.
C1	22.468	67.954	N 00° 59' 12\" E	22.366
C2	15.620	20.000	N 30° 51' 35\" W	15.226

- Note:
- 1. fd = Found
 - = Iron Pin
 - ⊙ = Capped Iron Pin

2. Copyright 2007, A. C. Barrow, NLS
Barrow & Hodder Surveys Ltd.

Coordinate Monument
No. 8696042
N 6362923.892
E 269324.160
(NAD83)



Barrow & Hodder
Surveys Ltd.

PLAN SHOWING LAND SURVEYED FOR
Stacy G. MacDonald
Tickle Cove, NL

Scale - 1 : 500
[Handwritten initials]

Job No. 07-026-1

Date - April 25, 2007

CHANGE OF NAME ACT

C-8 RSNL 1990

**NOTICE OF APPLICATION
FOR CHANGE OF NAME**

NOTICE is hereby given that an application will be made to the Minister of Government Services for a change of name, pursuant to the provisions of the *Change of Name Act*, by me:-

MERDIAN JOY VINCENT

of Musgrave Harbour, in the Electoral District of Bonavista North, in the Province of Newfoundland and Labrador, as follows:

To change my name from

MERDIAN JOY VINCENT
to
Merdina Joy Moulant

To change my minor unmarried child's name from

RAINE RICHARD VINCENT
to
RAINE RICHARD MOULANT

DATED this 4th day of September, 2007.

MERDIAN JOY VINCENT
(Signature of Applicant)

Sept 28

**NOTICE OF APPLICATION
FOR CHANGE OF NAME**

NOTICE is hereby given that an application will be made to the Minister of Government Services for a change of name, pursuant to the provisions of the *Change of Name Act*, by me:-

GLENN THOMAS FOWLER

of 85A Canada Drive, St. John's, in the Province of Newfoundland and Labrador, as follows:

To change my name from

GLENN THOMAS FOWLER
to
GLENN THOMAS SOMERTON

DATED this 20th day of September, 2007.

GLENN FOWLER
(Signature of Applicant)

Sept 28

**NOTICE OF APPLICATION
FOR CHANGE OF NAME**

NOTICE is hereby given that an application will be made to the Minister of Government Services for a change of name, pursuant to the provisions of the *Change of Name Act*, by me:-

JAMES LUKANG ORACH

of 25 Sulva St., St. John's, NL, A1C 4Z2 in the Province of Newfoundland and Labrador, as follows:

To change my minor unmarried child's name from

ISABEL ATIM
to
ISABEL ATIM ORACH

DATED this 20th day of September, 2007.

JAMES ORACH
(Signature of Applicant)

Sept 28

**NOTICE OF APPLICATION
FOR CHANGE OF NAME**

NOTICE is hereby given that an application will be made to the Minister of Government Services for a change of name, pursuant to the provisions of the *Change of Name Act*, by me:-

MARY GERALDINE TOUROUT

of Box 1 Site 10 RR#2, Port au Port, NL, A0N 1T0, in the Electoral District of Stephenville, in the Province of Newfoundland and Labrador, as follows:

To change my name from

MARY GERALDINE GODEAU
to
MARY GERALDINE GAUDON

DATED this 14th day of September, 2007.

MARY TOUROUT
(Signature of Applicant)

Sept 28



THE NEWFOUNDLAND AND LABRADOR GAZETTE

PART II

SUBORDINATE LEGISLATION FILED UNDER THE STATUTES AND SUBORDINATE LEGISLATION ACT

Vol. 82

ST. JOHN'S, FRIDAY, SEPTEMBER 28, 2007

No. 39

NEWFOUNDLAND AND LABRADOR REGULATIONS

NLR 97/07
NLR 103/07

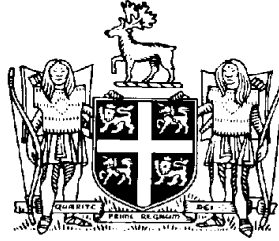

**NEWFOUNDLAND AND LABRADOR
REGULATION 97/07**

*Open Season Small Game Hunting and Snaring
Order, 2007-2008*
under the
Wild Life Regulations
and the
Wild Life Act

(Filed September 26, 2007)

Under the authority of sections 73, 80, 92 and 114 of the *Wild Life Regulations* and the *Wild Life Act*, I make the following Order.

Dated at St. John's, September 12, 2007.

Clyde Jackman
Minister of Environment and Conservation

ORDER

Analysis

- | | |
|--|-----------------------------------|
| 1. Short title | 8. Field possession limit |
| 2. Areas defined | 9. Prohibition |
| 3. Open season, hunting and shooting | 10. Prohibition |
| 4. Open season, snaring | 11. Modified snaring requirements |
| 5. Hunting, shooting, and snaring prohibited | 12. Approved snaring devices |
| 6. Bag limits | 13. Repeal |
| 7. Small game licence | Schedule |

Short title

1. This Order may be cited as the *Open Season Small Game Hunting and Snaring Order, 2007-2008*.

Areas defined

2. For the purpose of the various small game hunting, shooting, and snaring seasons the applicable areas are defined in the Schedule.

Open season,
hunting and shoot-
ing

3. The open seasons for hunting, shooting small game shall be

(a) for artic hare

(i) no open season throughout the province excluding Labrador and the islands adjacent to Labrador, and

(ii) for October 1, 2007 to April 20, 2008 throughout Labrador and the islands adjacent to Labrador;

(b) for snowshoe or varying hare

(i) October 13, 2007 to February 24, 2008, throughout the province excluding Labrador, the islands adjacent to Labrador, Great Island, Little Bay Islands, and Bell Island in Conception Bay,

(ii) October 13, 2007 to December 29, 2007, Great Island,

(iii) October 13, 2007 to November 4, 2007, Little Bay Islands,

(iv) October 1, 2007 to April 20, 2008 throughout Labrador and the islands adjacent to Labrador, and

(v) no open season, Bell Island, Conception Bay;

(c) for ptarmigan

(i) September 22, 2007 to November 4, 2007 in the Burin Area and the Avalon/Swift Current Area, excluding the Fair Haven Area,

(ii) no open season, Fair Haven Area,

(iii) September 22, 2007 to November 25, 2007 in the Topsails Area,

(iv) September 22, 2007 to December 15, 2007 throughout the remainder of the province excluding Labrador, the

island adjacent to Labrador, the Avalon/Swift Current Area, the Burin Area, and the Topsails Area, and

(v) October 1, 2007 to April 20, 2008 throughout Labrador and the islands adjacent to Labrador;

(d) for ruffed grouse and spruce grouse

(i) September 15, 2007 to December 29, 2007 throughout the province excluding Labrador and the islands adjacent to Labrador, and

(ii) October 1, 2007 to April 20, 2008 throughout Labrador and the islands adjacent to Labrador; and

(e) for porcupine, October 1, 2007 to March 31, 2008 throughout Labrador and the islands adjacent to Labrador.

Open season,
snaring

4. The open season for snaring small game shall be

(a) for artic hare

(i) no open season throughout the province excluding Labrador and the islands adjacent to Labrador, and

(ii) October 1, 2007 to March 31, 2008 throughout Labrador and the islands adjacent to Labrador;

(b) for snowshoe or varying hare

(i) October 13, 2007 to December 29, 2007, Great Island,

(ii) October 13, 2007 to November 4, 2007 Little Bay Islands,

(iii) no open season, Bell Island, Glover Island in Grand Lake, the Pine Marten Study Area and the Main River Study Area,

(iv) October 13, 2007 to February 24, 2008 throughout the province excluding Labrador, the islands adjacent to Labrador, Great Island, Little Bay Islands, Bell Island in

Conception Bay, Glover Island in Grand Lake, the Pine Marten Study Area and the Main River Study Area, and

(v) October 1, 2007 to March 31, 2008 throughout Labrador and the islands adjacent to Labrador;

(c) for ptarmigan

(i) no open season, Glover Island in Grand Lake, the Pine Marten Study Area, the Fair Haven Area, the Burin Area and the Mail River Study Area,

(ii) October 13, 2007 to February 24, 2008 throughout the province excluding Labrador, the islands adjacent to Labrador, Glover Island in Grand Lake, the Pine Marten Study Area, the Fair Haven Area, the Burin Area and the Main River Study Area, and

(iii) October 1, 2007 to March 31, 2008 throughout Labrador and the islands adjacent to Labrador;

(d) for ruffed grouse and spruce grouse

(i) no open season, Glover Island in Grand Lake, the Pine Marten study Area, and the Main River Study Area,

(ii) October 13, 2007 to February 24, 2008 throughout the province excluding Labrador, the islands adjacent to Labrador, Glover Island in Grand Lake, the Pine Marten Study Area and the Main River Study Area, and

(iii) October 1, 2007 to March 31, 2008 throughout Labrador and the islands adjacent to Labrador.

Hunting, shooting,
and snaring prohib-
ited

5. Notwithstanding the open seasons described in sections 3 and 4 all small game hunting, shooting, and snaring is prohibited on the following islands:

(a) Kelly's Island, Conception Bay; and

(b) Brunette Island, Fortune Bay.

Bag limits

6. (1) The bag limits shall be

(a) for the province, excluding Labrador and the islands adjacent to Labrador, for shooting and snaring

(i) arctic hare, not applicable, no open season,

(ii) snowshoe or varying hare, a possession limit of 40 rabbits,

(iii) ptarmigan

(A) a daily limit of 12 birds and field possession limit of 24 birds except as provided below, and

(B) in the Avalon/Swift Current, Burin and Topsails Areas as described in the Schedule A a daily limit of 6 birds and field possession limit of 12 birds, and

(iv) ruffed grouse and spruce grouse, a daily bag limit of 20 birds with a field possession limit of 40 birds, ruffed and spruce grouse combined; and

(b) for Labrador, and the islands adjacent to Labrador, for shooting or snaring

(i) arctic hare, no limit,

(ii) snowshoe or varying hare, no limit,

(iii) ptarmigan, daily bag limit of 25 birds with a field possession limit of 50 birds,

(iv) ruffed and spruce grouse

(A) Northern Labrador, no limit, and

(B) Southern Labrador, daily bag limit of 20 with field possession limit of 40 birds, spruce and ruffed grouse combined, and

(v) porcupine, a possession limit of one porcupine.

(2) Notwithstanding subparagraph (1)(a)(ii), the possession limit does not apply to persons licensed under the *Food and Drug Act* (Can-

ada), who may exceed the bag limit for snowshoe hare on their business premises for commercial purposes.

Small game licence	<p>7. A resident who has resided permanently in the Torngat Mountains Electoral District for a period of not less than 6 consecutive months immediately prior to applying for the licence, may be issued a small game licence free of charge.</p>
Field possession limit	<p>8. Field possession limit refers to the number of birds a small game licence holder may carry while hunting or travelling in the country.</p>
Prohibition	<p>9. A person shall not transport or possess any firearm under the authority of a valid hunting licence without being in possession of an outdoor identification card, or non-resident equivalent, issued to the person.</p>
Prohibition	<p>10. Hunting with a firearm on Sundays shall be permitted across the entire province, beginning November 4, 2007 and ending April 30, 2008, for the species and during the seasons as described in this Order, including any prescribed season for wild geese, wild ducks and snipe.</p>
Modified snaring requirements	<p>11. A person shall not snare small game in the Northwest Grand Lake Area, the Terra Nova Area, the Charlottetown Enclave Area and the Red Indian Lake Area as described in Schedule A except with a modified snaring device acceptable to the minister.</p>
Approved snaring devices	<p>12. Approved snaring devices include</p> <ul style="list-style-type: none">(a) brass wire not larger than 22 gauge attached to a firm anchor;(b) picture cord not exceeding 6 strands attached to a firm anchor; and(c) snare set using other wire types, but attached to modified coil.
Repeal	<p>13. <i>The Open Season Small Game Hunting and Snaring Order, 2005-2006, Newfoundland and Labrador Regulation 81/05, is repealed.</i></p>

Schedule

(a) Avalon/Swift Current Area

All that area of the Island of Newfoundland bounded by a line beginning at Friar Head in Fortune Bay;

Then northward following the eastern shoreline of Long Harbour and the Long Harbour River a distance of approximately 40 kilometres to the location where the Bay d'Espoir transmission line crosses the Long Harbour River;

Then following straight lines to the Tolt and the northern extremity of Whitehead Pond;

Then following the north shore of Whitehead Pond and the eastern shore of Pipers Hole River to Route 210;

Then following Route 210 to Goobies on the Trans Canada Highway;

Then following the Trans Canada Highway in a southerly direction to its junction with the local road providing access to the community of Sunnyside;

Then following the local road providing access to the Town of Sunnyside to the shoreline of Trinity Bay;

Then following the shorelines of Trinity, Conception, St. Mary's and Placentia Bays to the point where the shoreline meets the Piper's Hole River, thence following the eastern shoreline of the Piper's Hole River in a general northerly direction to the bridge that crosses the Burin Peninsula Highway, Route 210;

Then following Route 210 in a generally southerly direction to its intersection with the Terrenceville Highway;

Then following the north side of the Terrenceville highway to the shoreline of Fortune Bay;

Then following the shoreline of Fortune Bay to the point of commencement, including all offshore islands lying counter-clockwise from Friar Head, Fortune Bay, to the community of Sunnyside, Trinity Bay.

(b) Burin Area

All that area of the Island of Newfoundland bounded by a line beginning at the community of Terrenceville;

Then following the Terrenceville Highway to its intersection with the Burin Peninsula Highway Route 210;

Then following Route 210 in a generally northerly direction to where it crosses the bridge on the Piper's Hole River;

Then following the eastern shore of Piper's Hole River in a southerly direction to its mouth in Placentia Bay;

Then following the shoreline of Placentia and Fortune Bay to the point of commencement, excluding all offshore islands.

(c) Fair Haven Area

All that area of the Avalon Peninsula of the Island of Newfoundland bounded by a line beginning at the Chance Cove intersection with the Trans Canada Highway;

Then following a straight line in a southerly direction for approximately 50 metres to the northern shore of Gull Pond;

Then following the northern and western shore of Gull Pond to its southern extremity;

Then following a straight line for a distance of approximately 300 metres to the eastern shore of Big Gull Pond;

Then following the eastern shore of Big Gull Pond to its south eastern extremity;

Then following the eastern shores of the string of brooks and ponds leading southwest to where they empty into Placentia Bay near Little Pinchgut Cove;

Then following the coastline in a generally southerly direction to the mouth of Maturin Brook near the community of Long Harbour;

Then following the eastern shores of Maturin Brook and Maturin Ponds to the headwaters where it intersects the railway line;

Then following the railway line in a southerly direction to its intersection with the transmission line, a distance of approximately 2 kilometres;

Then following the transmission line in a northeasterly direction to the Trans Canada Highway;

Then following the Trans Canada Highway to the point of commencement.

(d) The Topsails

All that area of the Island of Newfoundland bounded by a line beginning at the mouth of Hinds Brook in Grand Lake;

Then following the southeastern shoreline of Grand Lake, Sandy Lake and Birchy Lake to the eastern end of Birchy Lake;

Then following a straight line to the closest point on the Trans Canada Highway;

Then following the Trans Canada Highway in a generally easterly and southerly direction to Badger;

Then following a straight line to the closest point on the south bank of the Exploits River;

Then following the Exploits River to Exploits Dam;

Then following the shoreline of Red Indian Lake in first, a generally northerly direction and then, a westerly direction to the mouth of Buchan's Brook;

Then following Buchan's Brook to Buchan's Lake;

Then following the western shoreline of Buchan's Lake to its northwestern extremity;

Then following a straight line to the southeastern extremity of Hind's Lake;

Then following the eastern shoreline of Hind's Lake to its outlet in Hind's Brook;

Then following the south bank of Hind's Brook to the point of commencement.

(e) Northern Labrador Zone

All that portion of Labrador, including adjacent islands, north of a line commencing at a point on the Labrador coast at 54° north latitude;

Then following the westerly line of 54° north latitude to a point where this line intersects with 62° west longitude;

Then following a northerly direction along the 62° west longitude line to a point where it intersects with the 55° north latitude line;

Then following the 55° north latitude line in a westerly direction to a point where it intersects with the Quebec/Labrador border;

Then following the Labrador-Quebec Boundary in a northerly and easterly direction to a point where this boundary intersects 58° 26' 37.8" north latitude;

Then following a straight line in a south-easterly direction for 11941 meters to a point located at 58° 22' 14.2" north latitude and 63° 42' 2.3" west longitude;

Then following a straight line in a north-easterly direction for 15097 meters to a point located at 58° 25' 31.5" north latitude and 63° 27' 51.9" west longitude;

Then following a straight line for 8960 meters in a north-easterly direction to a point where this boundary intersects 58° 28' 12.5" north latitude and coast line of mainland Labrador.

(f) Southern Labrador Zone

All that portion of Labrador, including adjacent islands, lying to the south of a line commencing at a point on the Labrador coast at 54° north latitude;

Then following the westerly line of 54° north latitude to a point where this line intersects with 62° west longitude;

Then following a northerly direction along the 62° west longitude line to a point where it intersects with the 55° north latitude line;

Then following the 55° north latitude line in a westerly direction to a point where it intersects with the Quebec/Labrador border.

(g) Pine Marten Study Area

All that part of the Island of Newfoundland bounded by a line beginning at the intersection of the Trans Canada Highway, Route 1, and the Camp 33 Road;

Then following the Camp 33 Road to the southwestern extremity of Grand Lake;

Then following the shoreline of Grand Lake to the mouth of Red Indian Brook;

Then following the southern bank of Red Indian Brook a distance of approximately 15 kilometres to a small lake on its headwaters;

Then following a straight line in a generally southeasterly direction to the southeastern extremity of Lake of the Hills;

Then following the western bank of the brook flowing out of Lake of the Hills to Otter Pond;

Then following the western shore of Otter Pond and the western bank of the brook flowing out of Otter Pond into Lloyds River;

Then following the northern bank of Lloyds River and the northern shore of Lloyds Lake and the northern bank of Lloyds River, west of Lloyds Lake, to the mouth of the brook flowing out of Cormacks Lake;

Then following the eastern or northern bank of this brook to Cormacks Lake;

Then following a straight line in a generally northerly direction approximately 8 kilometres to a point on the headwaters of Little Barachois Brook;

Then following the northern bank of Little Barachois Brook to its intersection with the eastern boundary of the Barachois Pond Provincial Park;

Then following the eastern and northern boundaries of the park to the Trans Canada Highway;

Then following the Trans Canada Highway to the point of commencement.

(h) Main River Study Area

All that area of the Island of Newfoundland, commencing at a tributary on Main River UTM 481,975 metres east 5,522,600 metres north;

Then following this tributary in a generally northerly direction to UTM 483,840 metres east 5,528,225 metres north;

Then following a straight line in a southeasterly direction to UTM 488,460 metres east 5,525,000 metres north;

Then following a straight line in an easterly direction to the eastern extremity of a small pond at UTM 498,485 metres east 5,525,000 metres north;

Then following the eastern shoreline of the pond to its outlet;

Then following a chain of brooks in a southerly direction to UTM 498,771 metres east 5,522,615 metres north;

Then following a straight line in a generally southeasterly direction to UTM 502,332 metres east 5,518,590 metres north;

Then following a straight line in a generally southwesterly direction to UTM 499,538 metres east 5,516,260 metres north;

Then following a straight line in a southerly direction to the outlet of a small pond at UTM 499,615 metres east 5,513,620 metres north;

Then following a stream that flows in a southerly direction to Main River;

Then following Main River in a westerly direction to a small tributary at UTM 495,570 metres east 5,510,540 metres north;

Then following the tributary and a chain of ponds in a generally westerly direction to where a small stream is intersected by the Upper Humber Forest Access Road at UTM 480,650 metres east 5,509,735 metres north;

Then following a straight line in a westerly direction to the east shore of a small pond at UTM 469,023 metres east 5,510,070 metres north;

Then following the north side of the pond and a connecting tributary in a northwesterly direction to its intersection with the eastern boundary of Gros Morne National Park at UTM 466,335 metres east 5,510,602 metres north;

Then following the boundary of the park in a northerly direction to where it intersects a lake at UTM 461,750 metres east 5,529,000 metres north;

Then following the south shoreline of the lake in an easterly direction to its most eastern extremity;

Then following a straight line in an easterly direction to UTM 466,087 metres east 5,528,540 metres north;

Then following the southern shore of Parsons Pond River in an easterly direction to the point of commencement.

(i) Northwest Grand Lake Area

All that area of the Island of Newfoundland bounded by a line beginning at the intersection of the Trans Canada Highway, TCH, Route 1 and Camp 33 Road;

Then following Camp 33 Road to the southwest extremity of Grand Lake;

Then following the north shoreline of Grand Lake in a northeasterly direction to the Humber Canal;

Then following the south bank of the Humber Canal to its intersection with the TCH at Deer Lake;

Then following the TCH in a southwesterly direction to the point of commencement.

(j) Terra Nova Area

All that area of the Island of Newfoundland bounded by a line beginning at the intersection of North West River and the Terra Nova National Park, TNNP, boundary at UTM coordinates 706,250 metres east and 5,365,250 metres north;

Then following the north bank of the said river in a westerly direction to UTM coordinates 664,125 metres east and 5,346,625 metres north;

Then following a straight line in a northwesterly direction to UTM coordinates 663,750 metres east and 5,353,125 metres north;

Then following a straight line in a westerly direction to the northeastern extremity of Kepenkeck Lake;

Then following a straight line in a northwesterly direction to the eastern extremity of Newton's Lake;

Then following a straight line in a northerly direction to the eastern extremity of South West Pond;

Then following a straight line in a northeasterly direction to the western extremity of Dead Wolf Pond;

Then following the southern shoreline of Dead Wolf Pond to the mouth of a small stream entering the pond at its eastern extremity;

Then following this stream to its headwaters pond;

Then following a straight line for approximately 500 metres due east to an unnamed pond;

Then following a stream exiting this pond at its southeastern extremity;

Then following this stream in a southeasterly direction to its outflow in Riverhead Brook;

Then following this brook in an easterly direction to its mouth in Gambo Pond;

Then following the north shore of Gambo Pond to Gambo Brook;

Then following the west bank of Gambo Brook to its intersection with the Trans Canada Highway, TCH, Route 1;

Then following the TCH in an easterly direction to its intersection with the TNNP boundary;

Then following the western boundary of TNNP in a southerly direction to the point of commencement.

(k) Charlottetown Enclave Area

All that area of the island of Newfoundland bounded by a line beginning at the intersection of the Terra Nova National Park, TNNP, boundary and the north shoreline of Clode Sound, Bonavista Bay at UTM coordinates 720,554 metres east and 5,367,279 metres north;

Then following the TNNP boundary in a northerly direction to UTM coordinates 720,507 metres east and 5,370,209 metres north;

Then following the TNNP boundary in a northeasterly direction to UTM coordinates 721,554 metres east and 5,371,792 metres north;

Then following the TNNP boundary in a southeasterly direction to its intersection with the north shoreline of Clode Sound, Bonavista Bay at UTM coordinates 722,550 metres east and 5,369,850 metres north;

Then following the shoreline of Clode Sound, Bonavista Bay in a southwesterly direction to the point of commencement.

(l) Red Indian Lake Area

All that area of the Island of Newfoundland bounded by a line beginning at the mouth of Victoria River and Red Indian Lake;

Then following the north bank of Victoria River in a southwesterly direction to Victoria Lake;

Then following a mid-way line between the north and south shorelines of Victoria Lake to the mouth of a small river entering Victoria Lake at its southwestern extremity;

Then following the north bank of the Victoria River to a point opposite the mouth of a brook flowing from Peter Strides Pond;

Then following a straight line in a northerly direction to the intersection of the Pine Marten Study Area and Lloyds River at the mouth of the brook flowing from Cormack Lake;

Then following the Pine Marten Study Area boundary along Lloyds River in a northeasterly direction to the mouth of Otter Pond Brook;

Then following the western bank of Otter Pond Brook, the western shore of Otter Pond and the west bank of Otter Pond Brook to Lake of the Hills;

Then following a straight line in a northwesterly direction to UTM co-ordinates 471,250 metres east and 5,379,000 metres north;

Then following a straight line in a northeasterly direction to its intersection with Clench Brook at UTM co-ordinates 500,875 metres east and 5,401,000 metres north;

Then following the south bank of Clench Brook to its mouth on Red Indian Lake;

Then following a straight line in an easterly direction to the point of commencement.

©Earl G. Tucker, Queen's Printer

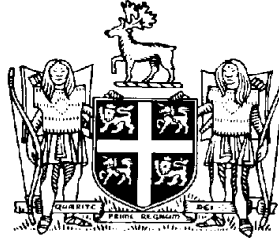

**NEWFOUNDLAND AND LABRADOR
REGULATION 103/07**

Furbearing Animals Trapping Order, 2007-2008
under the
Wild Life Regulations
and the
Wild Life Act

(Filed September 26, 2007)

Under the authority of sections 16, 25, 27 and 114 of the *Wild Life Regulations* and the *Wild Life Act*, I make the following Order.

Dated at St. John's, September 12, 2007.

Clyde Jackman
Minister of Environment and Conservation

ORDER

Analysis

- | | |
|--------------------------------|------------|
| 1. Short title | Schedule A |
| 2. Open season trapping | |
| 3. Prohibitions | |
| 4. Neck snares | Schedule B |
| 5. Foot hold restraining traps | |
| 6. Killing traps | Schedule C |
| 7. Live holding devices | |
| 8. Rate of beaver harvest | Schedule D |
| 9. Lynx | |
| 10. Wolves | |
| 11. Repeal | Schedule E |

Short title

1. This Order may be cited as the *Furbearing Animals Trapping Order, 2007-2008*.

Open season trapping

2. (1) The open season for trapping on the Island of Newfoundland, except as provided for in specific management areas described in Schedule A, shall be

Beaver	Oct. 20, 2007 - Mar. 15, 2008
Coyote	Oct. 20, 2007 - Feb. 1, 2008
Ermine, weasel	Oct. 20, 2007 - Feb. 28, 2008
Fox, coloured	Oct. 20, 2007 - Feb. 1, 2008
Fox, white	Oct. 20, 2007 - Feb. 1, 2008
Lynx	Nov. 1, 2007 - December 31, 2007
Mink	Nov. 1, 2007 - Feb. 28, 2008
Muskrat	Oct. 20, 2007 - March 15, 2008
Otter	Oct. 20, 2007 - March 15, 2008
Squirrel	Oct. 20, 2007 - February 28, 2008

(2) The open seasons for trapping within Labrador fur management zones as described in Schedule B shall be

(a) Northern Labrador Zone:

Beaver	Oct. 15, 2007 - May 31, 2008
Coyote	Oct. 15, 2007 - March 31, 2008
Ermine, weasel	Oct. 15, 2007 - March 31, 2008
Fox, coloured	Oct. 15, 2007 - March 31, 2008
Fox, white	Oct. 15, 2007 - May 31, 2008
Lynx	Oct. 15, 2007 - March 31, 2008
Marten	Oct. 15, 2007 - March 31, 2008
Mink	Nov. 1, 2007 - March 31, 2008
Muskrat	Oct. 5, 2007 - May 31, 2008

Otter	Oct. 15, 2007 - March 31, 2008
Squirrel	Oct. 15, 2007 - March 31, 2008
Wolf	Oct. 15, 2007 - April 30, 2008
Wolverine	No open season.
Fisher	No open season.

(b) Eastern Labrador Zone:

Beaver	Oct. 15, 2007 - May 31, 2008
Coyote	Oct. 15, 2007 - March 20, 2008
Ermine, weasel	Oct. 15, 2007 - March 20, 2008
Fox, coloured	Oct. 15, 2007 - March 20, 2008
Fox, white	Oct. 15, 2007 - March 20, 2008
Lynx	Oct. 15, 2007- March 20, 2008
Marten	Oct. 15, 2007 - March 20, 2008
Mink	Nov.1, 2007- March 20, 2008
Muskrat	Oct. 15, 2007 - May 31, 2008
Otter	Oct. 15, 2007 - March 20, 2008
Squirrel	Oct. 15, 2007 - March 20, 2008
Wolf	Oct. 25, 2007 - April 30, 2008
Wolverine	No open season.
Fisher	No open season.

(c) Western Labrador Zone:

Beaver	Oct. 15, 2007 - May 31, 2008
Coyote	Nov. 1, 2007 - March 20, 2008
Ermine, weasel	Nov. 1, 2007 - March 20, 2008
Fox, coloured	Nov.1, 2007 - March 20, 2008

Fox, white	Nov. 1, 2007 - March 20, 2008
Lynx	Nov. 1, 2007- March 20, 2008
Marten	Nov. 1, 2007 - March 20, 2008
Mink	Nov.1, 2007- March 20, 2008
Muskrat	Oct. 15, 2007 - May 31, 2008
Otter	Oct. 15, 2007 - March 20, 2008
Squirrel	Nov. 1, 2007 - March 20, 2008
Wolf	Nov. 1, 2007 - April 30, 2008
Wolverine	No open season.
Fisher	No open season.

Prohibitions

3. (1) Notwithstanding section 2,

- (a) the trapping of lynx is prohibited in areas outside Zone A, known as Zone B, as described in Schedule A; and
- (b) the trapping of all furbearing animals is prohibited in the following areas:
 - (i) Brunette Island, Fortune Bay, and
 - (ii) Great Southern Harbour.

(2) A person shall not use a killing trap for beaver, muskrat or marten unless the trap is a killing trap described in Schedule C for that wildlife species and the trap is used in accordance with the conditions prescribed in Schedule C.

(3) A person shall not use a trap in the following areas described in Schedule A:

- (a) the Pine Marten Study Area, excluding the Little Grand Lake Ecological Reserve;
- (b) the Main River/ Upper Humber Study Area;

(c) the Little Grand Lake Wildlife Reserve; and

(d) the Glover Island Public Reserve, Glover Island

unless the trap is a trap described in Schedule D for each furbearing species and the trap is used in accordance with the requirements of Schedule D.

(4) A person shall not use a trap in the following areas described in Schedule A:

(a) the North West Grand Lake Area;

(b) the Charlottetown Enclave Area;

(c) the Terra Nova Area; and

(d) the Red Indian Lake Area

unless the trap is a trap described in Schedule E for each furbearing species and the trap is used in accordance with the requirements of Schedule E.

Neck snares

4. (1) Killing neck snares which are set on land for the purpose of taking furbearing animals shall be equipped with a noose locking device which shall be set in a manner so that the noose, once closed, is prevented from expanding.

(2) Subsection (1) shall not apply to the taking of squirrel.

Foot hold restraining traps

5. (1) Foot hold restraining traps set for beaver, muskrat, otter and mink shall be set in a manner which allows the animal to submerge and prevent it from resurfacing.

(2) Coyote and wolf may be taken with a foot holding restraining trap providing the device has a minimum space of 5 millimetres between the jaws when closed, or the device has pads of a rubber-like substance fastened to the trap jaws or the device is equipped with trap jaws of 9 millimetres or greater in thickness.

(3) A person shall not use a foot hold restraining trap for lynx unless it is a foot hold restraining trap as described in Schedule C for

lynx and the trap is used in accordance with the conditions prescribed in Schedule C.

Killing traps

6. (1) Furbearing animals shall be taken only by means of a killing trap set in a manner as to kill the animal quickly.

(2) Subsection (1) shall not apply to the taking of fox, coyote, wolf or lynx.

(3) A person shall not trap, take or kill any furbearing animal by means of a trap or other device equipped with metal teeth, metal serrated edges, hooks or sharp devices.

(4) A person shall not use spring poles or foot hold traps in trees or poles, unless the trap is set as a killing trap.

Live holding devices

7. Live holding devices set on land for the taking of furbearing animals shall be checked daily.

Rate of beaver harvest

8. (1) On the Island of Newfoundland, the holder of a beaver trapline licence shall harvest beaver at a rate of one beaver per active lodge on the trapline area identified in the licence.

(2) In Labrador, there is no limit on the number of beaver which may be taken by the holder of a trappers beaver licence.

Lynx

9. (1) Lynx caught during the open season for lynx shall be registered for tagging before the close of business hours on Friday, January 11, 2008.

(2) Lynx carcasses shall be surrendered to the Wild Life Division at the time of registration for tagging prescribed under subsection (1).

(3) A person shall not have in his or her possession any lynx pelt or any lynx parts, unless that person holds a valid trappers licence and the pelt or pelt parts are registered as required in subsections (1) and (2).

(4) A licensed trapper who takes lynx accidentally during the trapping seasons for other species, other than those trapping periods prescribed for lynx, shall within 7 days of the taking the lynx, surrender it to the Wild Life Division.

(5) This section shall not apply to the taking of lynx in Labrador.

Wolves

10. A person who takes a wolf shall surrender the lower jawbone or complete skull of each wolf taken to the Wild Life Division by May 11, 2008.

Repeal

11. The *Furbearing Animals Trapping Order, 2005-2006*, Newfoundland and Labrador Regulation 74/05, is repealed.

Schedule A

(a) Pine Marten Study Area

That part of the Island of Newfoundland bounded by a line beginning at the intersection of the Trans Canada Highway, Route 1, and the Camp 33 Road;

Then following the Camp 33 Road to the southwestern extremity of Grand Lake;

Then following the shoreline of Grand Lake to the mouth of Red Indian Brook a distance of approximately 15 kilometres to a small lake on its headwaters;

Then following a straight line in a generally southeasterly direction to the southeastern extremity of the Lake of the Hills;

Then following the western bank of the brook flowing out of Lake of the Hills to Otter Pond;

Then following the western shore of Otter Pond and the western bank of the brook flowing out of Otter Pond into Lloyds River;

Then following the northern bank of Lloyds River and the northern shore of Lloyds Lake and the northern bank of Lloyds River, west of Lloyds Lake, to the mouth of the brook flowing out of Cormacks Lake;

Then following the eastern or northern bank of this brook to Cormacks Lake;

Then following a straight line in a generally northerly direction approximately 8 kilometres to a point on the headwaters of Little Barachois Brook;

Then following the northern bank of Little Barachois Brook to its intersection with the eastern boundary of the Barachois Pond Provincial Park;

Then following the eastern and northern boundaries of the park to the Trans Canada Highway;

Then following the Trans Canada Highway to the point of commencement.

Excluding the Little Grand Lake Provisional Ecological Reserve established by the *Little Grand Lake Provisional Ecological Reserve Regulations*, Newfoundland Regulation 84/02 as described in the *Little Grand Provisional Ecological Reserve Order*, Newfoundland and Labrador Regulation 83/02, made under the authority of the *Wilderness and Ecological Reserves Act*.

(b) Main River/Upper Humber Area

All that area of the Island of Newfoundland, commencing at a tributary on Main River UTM 481,975 metres east 5,522,600 metres north;

Then following this tributary in a generally northerly direction to UTM 483,840 metres east 5,528,225 metres north;

Then following a straight line in a southeasterly direction to UTM 488,460 metres east 5,525,000 metres north;

Then following a straight line in an easterly direction to the eastern extremity of a small pond at UTM 498,485 metres east 5,525,000 metres north;

Then following the eastern shoreline of the pond to its outlet;

Then following a chain of brooks in a southerly direction to UTM 498,771 metres east 5,522,615 metres north;

Then following a straight line in a generally southeasterly direction to UTM 502,332 metres east 5,518,590 metres north;

Then following a straight line in a generally southwesterly direction to UTM 499,538 metres east 5,516,260 metres north;

Then following a straight line in a southerly direction to the outlet of a small pond at UTM 499,615 metres east 5,513,620 metres north;

Then following a stream that flows in a southerly direction to Main River;

Then following Main River in a westerly direction to a small tributary at UTM 495,570 metres east 5,510,540 metres north;

Then following that tributary and a chain of ponds in a generally westerly direction to where a small stream is intersected by the Upper Humber Forest Access Road at UTM 480,650 metres east 5,509,735 metres north;

Then following a straight line in a westerly direction to the east shore of a small pond at UTM 469,023 metres east 5,510,070 metres north;

Then following the north side of that pond and a connected tributary in a northwesterly direction to its intersection with the eastern boundary of Gros Morne National Park at UTM 466,335 metres east 5,510,602 metres north;

Then following the boundary of the park in a northerly direction to where it intersects a lake at UTM 461,750 metres east 5,529,000 metres north;

Then following the south shoreline of that lake in an easterly direction to its most eastern extremity;

Then following a straight line in an easterly direction to UTM 466,087 metres east 5,528,540 metres north;

Then following the southern shore of Parsons Pond River in an easterly direction to the point of commencement.

(c) Northwest Grand Lake Area

All that area of the Island of Newfoundland bounded by a line beginning at the intersection of the Trans Canada Highway, Route 1, and Camp 33 Road;

Then following Camp 33 Road to the southwest extremity of Grand Lake;

Then following the north shoreline of Grand Lake in a northeasterly direction to the Humber Canal;

Then following the south bank of the Humber Canal to its intersection with the TCH at Deer Lake;

Then following the TCH in a southwesterly direction to the point of commencement.

(d) Terra Nova Area

All that area of the Island of Newfoundland bounded by a line beginning at the intersection of North West River and the Terra Nova National Park, TNNP, boundary at UTM coordinates 706,250 metres east and 5,365,250 metres north;

Then following the north bank of the said river in a westerly direction to UTM coordinates 664,125 metres east and 5,346,625 metres north;

Then following a straight line in a northwesterly direction to UTM coordinates 663,750 metres east and 5,353,125 metres north;

Then following a straight line in a westerly direction to the northeastern extremity of Kepenkeck Lake;

Then following a straight line in a northwesterly direction to the eastern extremity of Newton's Lake;

Then following a straight line in a northerly direction to the eastern extremity of South West Pond;

Then following a straight line in a northeasterly direction to the western extremity of Dead Wolf Pond;

Then following the southern shoreline of Dead Wolf Pond to the mouth of a small stream entering the pond at its eastern extremity;

Then following this stream to its headwaters pond;

Then following a straight line for approximately 500 metres due east to an unnamed pond;

Then following a stream exiting this pond at its southeastern extremity;

Then following this stream in a southeasterly direction to its outflow in Riverhead Brook;

Then following this brook in an easterly direction to its mouth in Gambo Pond;

Then following the north shore of Gambo Pond to Gambo Brook;

Then following the west bank of Gambo Brook to its intersection with the Trans Canada Highway, TCH, Route 1;

Then following the TCH in an easterly direction to its intersection with the TNNP boundary;

Then following the western boundary of TNNP in a southerly direction to the point of commencement.

(e) Charlottetown Enclave Area

All that area of the Island of Newfoundland bounded by a line beginning at the intersection of the Terra Nova National Park, TNNP, boundary and the north shoreline of Clode Sound, Bonavista Bay at UTM coordinates 720,554 metres east and 5,367,279 metres north;

Then following the TNNP boundary in a northerly direction to UTM coordinates 720,507 metres east and 5,370,209 metres north;

Then following the TNNP boundary in a northeasterly direction to UTM coordinates 721,554 metres east and 5,371,792 metres north;

Then following the TNNP boundary in a southeasterly direction to its intersection with the north shoreline of Clode Sound, Bonavista Bay at UTM coordinates 722,550 metres east and 5,369,850 metres north;

Then following the shoreline of Clode Sound, Bonavista Bay in a southwesterly direction to the point of commencement.

(f) Red Indian Lake Area

All that area of the Island of Newfoundland bounded by a line beginning at the mouth of Victoria River and Red Indian Lake;

Then following the north bank of Victoria River in a southwesterly direction to Victoria Lake;

Then following a mid-way line between the north and south shorelines of Victoria Lake to the mouth of a small river entering Victoria Lake at its southwestern extremity;

Then following the north bank of the Victoria River to a point opposite the mouth of a brook flowing from Peter Strides Pond;

Then following a straight line in a northerly direction to the intersection of the Pine Marten Study Area and Lloyds River at the mouth of the brook flowing from Cormack Lake;

Then following the Pine Marten Study Area boundary along Lloyds River in a northeasterly direction to the mouth of Otter Pond Brook;

Then following the western bank of Otter Pond Brook, the western shore of Otter Pond and the west bank of Otter Pond Brook to Lake of the Hills;

Then following a straight line in a northwesterly direction to U.T.M. co-ordinates 471,250 metres east and 5,379,000 metres north;

Then following a straight line in a northeasterly direction to its intersection with Clench Brook at U.T.M. co-ordinates 500,875 metres east and 5,401,000 metres north;

Then following the south bank of Clench Brook to its mouth on Red Indian Lake;

Then following a straight line in an easterly direction to the point of commencement.

(g) Lynx Zone A: NORTHERN REGION

All that area of the Island of Newfoundland bounded by a line beginning at a point known as Main Gut at the mouth of the St. George's River in St. Georges Bay;

Then following the northern shoreline of St. George's River in a easterly direction to the Trans Canada Highway;

Then following the Trans Canada Highway in a southerly direction to the Burgeo Highway;

Then following the Burgeo Highway in a easterly direction to the its intersection with the south bank of the Lloyds River;

Then following a straight line in an easterly direction to the southern extremity of Mollyguajack Lake where a small stream enters the lake;

Then following the southern shoreline of Mollyguajack Lake to Terra Nova River;

Then following the southern bank of the Terra Nova River to Terra Nova Lake;

Then following the southern shoreline of Terra Nova Lake to Terra Nova River;

Then following the southern bank of the Terra Nova River to its mouth (outflow) at Glovertown South;

Thence following the coastline of insular Newfoundland including all offshore islands and excluding all areas within National Park jurisdiction in a northerly direction to the point of commencement.

(h) Lynx Zone B: SOUTHERN REGION

All that area of the Island of Newfoundland bounded by a line beginning at a point known as Main Gut at the mouth of the St. George's River in St. Georges Bay;

Then following the southern shoreline of St. George's River in an easterly direction to the Trans Canada Highway;

Then following the Trans Canada Highway in a southerly direction to the Burgeo Highway;

Then following the Burgeo Highway in an easterly direction to the its intersection with the south bank of the Llyods River;

Then following a straight line in an easterly direction to the southern extremity of Mollyguajack Lake where a small stream enters the lake;

Then following the southern shoreline of Mollyguajack Lake to Terra Nova River;

Then following the southern bank of the Terra Nova River to Terra Nova Lake;

Then following the southern shoreline of Terra Nova Lake to Terra Nova River;

Then following the southern bank of the Terra Nova River to its mouth (outflow) at Glovertown South;

Then following the coastline of insular Newfoundland including all offshore islands and excluding all areas within National Park jurisdiction in a southerly direction to the point of commencement.

(i) Little Grand Lake Wild Life Reserve

The Little Grand Lake Wild Life Reserve established by the *Little Grand Lake Wild Life Reserve Regulations*, Newfoundland Regulation 85/02.

(j) Glover Island

The Glover Island Public Reserve established by the *Glover Island Public Reserve Regulations*, Newfoundland and Labrador Regulation 87/02 as described in the *Glover Island Public Reserve Order*, Newfoundland and Labrador Regulation 86/02 made under the authority of the *Lands Act*.

Schedule B

(a) Labrador North Fur Zone

All that area of Labrador, including offshore islands, lying north of a line commencing at a point on the coast at 54° north latitude;

Then west along 54° north latitude to its intersection with 62° west longitude;

Then north along 62° west longitude to 55° north latitude;

Then west along 55° north latitude to its intersection with the Labrador - Quebec border;

Then following the Labrador-Quebec Boundary in a northerly and easterly direction to a point where this boundary intersects 58° 26' 37.8" north latitude;

Then following a straight line in a south-easterly direction for 11941 meters to a point located at 58° 22' 14.2" north latitude and 63° 42' 2.3" west longitude;

Then following a straight line in a north-easterly direction for 15097 meters to a point located at 58° 25' 31.5" north latitude and 63° 27' 51.9" west longitude;

Then following a straight line for 8960 meters in a north-easterly direction to a point where this boundary intersects 58° 28' 12.5" north latitude and coast line of mainland Labrador.

(b) Labrador East Fur Zone

All that area of Labrador, including offshore islands, lying south of a line commencing at a point on the coast at 54° north latitude, then west along 54° north latitude to its intersection with 62° west longitude, then south along 62° west longitude to its intersection with the Goose River, then in a generally south-westerly direction to a pond at the headwaters of the Cache River, then following the Cache River to

its intersection with 62° west longitude, then following 62° west longitude south to its intersection with the Quebec Labrador border.

(c) Labrador West Fur Zone

All the remainder of Labrador not described in the Labrador North and Labrador East Fur Zones.

Schedule C

List of Killing traps certified for use by species under certain stated conditions:

When trapping beaver either underwater and on land:

Belisle Classic 330

LDL C 280

Belisle Super X 280

LDL C 330

Belisle Super X 330

Rudy 280

B.M.I. 330 Body Gripper

Rudy 330

Bridger 330

Sauvageau 2001-11

Species specific 330 Dislocator Half Magnum

Species specific 440 Dislocator Half Magnum

Woodstream Oneida Victor Conibear 280

Woodstream Oneida Victor Conibear 330

When trapping beaver on land only:

Sauvageau 1000 -11F

LDL C330 Magnum

When trapping beaver underwater only:

Duke 330

B.M.I 280 Body Gripper

Sauvageau 2001-8

LDL C280 Magnum

When trapping marten:

Belisle Super X 120

Rudy 120 Magnum

Belisle Super X 160

Rudy 160 Plus

B.M.I. 126 Magnum Body Gripper

Sauvageau C120 Magnum

LDL B120 Magnum

Sauvageau 2001-5

Sauvageau 2001-6

When trapping muskrat on land:

Belisle Super X 120

Bridger 120

Sauvageau 2001-5

B.M.I. 120

LDL B120 Magnum

Triple M

B.M.I. 120 Magnum

Rudy 120 Magnum

Duke 120

B.M.I.126 Magnum

Sauvageau C120 Magnum

Koro Muskrat

Woodstream Oneida Victor Conibear 110

Sauvageau C120 "Reverse Bend"

Woodstream Oneida Victor Conibear 120

When trapping muskrat underwater:

Any jaw type trap (body gripping or leghold) set as a submersion set that exerts clamping force on a muskrat and maintains a muskrat underwater.

List of foot hold restraining traps certified for use for lynx under specific stated conditions.

When trapping lynx:

Belisle Footsnare

Oneida Victor #3 Soft Catch equipped with two coil springs.

Oneida Victor #3 Coil Spring equipped with 4 coil springs

Oneida Victor # 3 equipped with a minimum 8mm thick, non-offset steel jaw, 4 coil springs and an anchoring swivel centre mounted on a base plate.

Schedule D

Trapping and setting requirements by species approved for use in the Main River/Upper Humber Study Area, Pine Marten Study Area (Excluding the Little Grand Lake Provisional Ecological Reserve), the Little Grand Lake Wild Life Reserve and the Glover Island Public Reserve.

Target Species and Approved Trap	Setting Requirements
Beaver Conibear	Trap jaws shall be completely submerged requiring target species to dive.
Beaver Submarine Cage	Cage shall be completely submerged.
Beaver Snare Pole	Snares shall be completely submerged.
Ermine (weasel) or Squirrel Rat Trap	Victor rat trap, whether baited or not, shall be completely enclosed inside a wooden box with a 1.5" hole at one end.
Fox , Coyote or Lynx Restraining Neck Snare	<ul style="list-style-type: none"> - Wire shall be 3/32 " or greater - 360° swivel required at the attachment point -The stop on the snare loop shall be fastened so that the loop will close to a minimum 8" circumference. -The snare shall be fastened to an immovable object with no drags. -The snare may be set with or without the use of bait.
Mink Conibear	The floating mink box-trap shall be set in the entrance of a floating wooden box, whether or not the trap is baited, and the entrance to the box shall be completely submerged.
Otter, Mink or Muskrat Submarine Cage	The cage shall be completely submerged.

Otter, Mink or Muskrat Coni-bear	Trap jaws shall be completely submerged requiring target species to dive.
Beaver, Otter, Muskrat or Mink Slide-lock Drowner	<ul style="list-style-type: none">-The trap shall be a foot hold type with a slide lock attached.- The trap shall be placed at least 5' from the shoreline or on a semi-submerged log with no land-based access.-The snare may be set with or without the use of bait.-The water shall be sufficiently deep so as to ensure drowning.
Squirrel Pole	Snares shall use 16 pound test snare wire attached to a horizontal or leaning pole, snares 3/4"-1" up off the pole and having 1.5"-1.75" diameter loop. No bait shall be used.

Schedule E

Traps and setting requirements by species approved for use in the North West Grand Lake Area, the Charlottetown Enclave Area, the Terra Nova Area and the Red Indian Lake Area.

All those trap and setting requirements as described in Schedule D, and in addition, those outlined below:

Target Species and Approved Trap	Setting Requirements
Fox Coyote or Lynx Killing Neck Snare	The snare shall be equipped with a lock

©Earl G. Tucker, Queen's Printer

Index

PART I

Change of Name Act – Applications	328
Mental Health Care and Treatment Act – Notice	325
Quieting of Titles Act – Notice	325

PART II

CONTINUING INDEX OF SUBORDINATE LEGISLATION

Title of Act and Subordinate Legislation made thereunder	CNLR or NL Reg.	Amendment	NL Gazette Date & Page No.
Wild Life Regulations and the Wild Life Act			
Open Season Small Game Hunting and Snaring Order 2007-2008	NLR 97/07	R&S NLR 81/05	Sept 28/07, p. 741
Furbearing Animals Trapping Order, 2007-2008	NLR 103/07	R&S NLR 74/05	Sept 28/07, p. 759

The Newfoundland and Labrador Gazette is published from the office of Earl G. Tucker, Queen's Printer.

Copy for publication must be received before **Friday, 4:30 p.m.**, seven days before publication, to ensure inclusion in next issue. Advertisements should be typewritten or printed legibly, separate from covering letter. Number of insertions required must be stated and the names of all signing officers typewritten or printed.

Advertising rates are available upon request. Subscription rate for *The Newfoundland and Labrador Gazette* is \$125.00 for 52 weeks plus applicable tax (\$132.50). Weekly issues of \$3.00 per copy, plus tax payable in advance.

All cheques, money orders, etc., should be made payable to THE NEWFOUNDLAND EXCHEQUER ACCOUNT and all correspondence should be addressed to: Office of the Queen's Printer, P. O. Box 8700, Ground Floor, East Block, Confederation Building, St. John's, NL A1B 4J6. Telephone (709) 729-3649. Fax: (709) 729-1900.

Web Site: www.gov.nl.ca/queensprinter

**Place your order by contacting:
Office of The Queen's Printer
Confederation Building, East Block
St. John's, NL A1B 4J6
Telephone: (709) 729-3649 Fax: (709) 729-1900
email: queensprinter@gov.nl.ca**

**Government Information Product
Publication Rate Mail
G.S.T. # R107442683**

All requests for Subscription and Legislation MUST be prepaid.