



THE NEWFOUNDLAND AND LABRADOR GAZETTE

PART I

PUBLISHED BY AUTHORITY

Vol. 88

ST. JOHN'S, FRIDAY, APRIL 26, 2013

No. 17

CORPORATIONS ACT

CORRECTION NOTICE

Inadvertently omitted from publication on page 212 of Volume 85, Number 23, June 11, 2010 edition of *The Newfoundland and Labrador Gazette*, was notice of an Extra-Provincial Registration for Amalgamation (*Corporations Act* – Section 294) for the Month of April 2010 that Prime Restaurants Inc., NL Registration # 62412 was a result of an amalgamation through articles of arrangement in its home jurisdiction that included Prime Restaurants of Canada Inc., NL Registration # 6299F.

SERVICE NL
Dean Doyle, Registrar of Companies

Apr 26

LANDS ACT

NOTICE OF INTENT

Lands Act, c36, SNL 1991, as amended

NOTICE IS HEREBY given that VICTOR KIVEN HANN of Summerside-Irishtown, NL intends to apply to the Department of Environment and Conservation, two months from the publication of this notice, to acquire title, pursuant to Section 7(2) of the said Act, to that piece of Crown land situated within fifteen (15) metres of the waters of Bay of

Islands in the Electoral District of Bay of Islands for the purpose of a wharf. The land is described as follows:

*Bounded on the North by Highway 440
for a distance of 112.67 metres;
Bounded on the East by Private Property
for a distance of 63.62 metres;
Bounded on the South by Humber Arm
for a distance of 125.43 metres;
Bounded on the West by Crown land
for a distance of 21.93 metres;
and containing an area of
approximately 500 square metres.*

Any person wishing to object to the application must file the objection, in writing, within one month from the publication of this Notice, with reasons for it, to the Minister of Environment and Conservation, and mail to the nearest Regional Lands Office:

c/o Eastern Regional Lands Office, P.O. Box 8700, 5 Mews Place, St. John's, NL, A1B 4J6.

c/o Central Regional Lands Office, P.O. Box 2222, Gander, NL, A1V 1L7.

c/o Western Regional Lands Office, P.O. Box 2006, Noton Building, Corner Brook, NL, A2H 6J8.

c/o Labrador Regional Lands Office, P.O. Box 3014, Station "B", Happy Valley-Goose Bay, NL, A0P 1E0.

For further information on the proposed application, please contact: VICTOR KIVEN HANN. Telephone number: (709) 783-3178.

Apr 26

NOTICE OF INTENT
Lands Act, c36, SNL 1991, as amended

NOTICE IS HEREBY given that NALCOR ENERGY of St. John's, NL intends to apply to the Department of Environment and Conservation, two months from the publication of this Notice, to acquire title, pursuant to Subsection 7(2)(a) of the Act, to that piece of Crown land situated within fifteen (15) metres of the waters of Conception Bay at Dowdens Point in Seal Cove in the Town of Conception Bay South in the Electoral District of Harbour Main for the purpose of a shoreline electrode site. The land is described as follows:

All that land along the southeasterly shoreline of the waters of Conception Bay at Dowdens Point in Seal Cove;

Beginning at coordinates of North 5259775 metres and East 343201 metres and ending at coordinates of North 5260192 metres and East 343785 metres;
Bounded on the northwest by the southeasterly shoreline of the waters of Conception Bay for a distance of 720 metres;
Bounded on the northeast by the shoreline reservation for a distance of 15 metres;
Bounded on the southeast by Crown land

for a distance of 720 metres;
Bounded on the southwest by the shoreline reservation for a distance of 15 metres;
and containing an area of approximately 1.1 hectares.

All coordinates are UTM Zone 22 NAD83 and are approximate as scaled from map NTS: 1N06.

Any person wishing to object to the application must file the objection, in writing, within one month from the publication of this Notice, with reasons for it, to the Minister of Environment and Conservation, and mail to the nearest Regional Lands Office:

c/o Eastern Regional Lands Office, P.O. Box 8700, 5 Mews Place, St. John's, NL, A1B 4J6.

c/o Central Regional Lands Office, P.O. Box 2222, Gander, NL, A1V 1L7.

c/o Western Regional Lands Office, P.O. Box 2006, Noton Building, Corner Brook, NL, A2H 6J8.

c/o Labrador Regional Lands Office, P.O. Box 3014, Station "B", Happy Valley-Goose Bay, NL, A0P 1E0.

For further information on the proposed application, please contact: John Cooper at NALCOR ENERGY. Telephone number: (709) 737-1944.

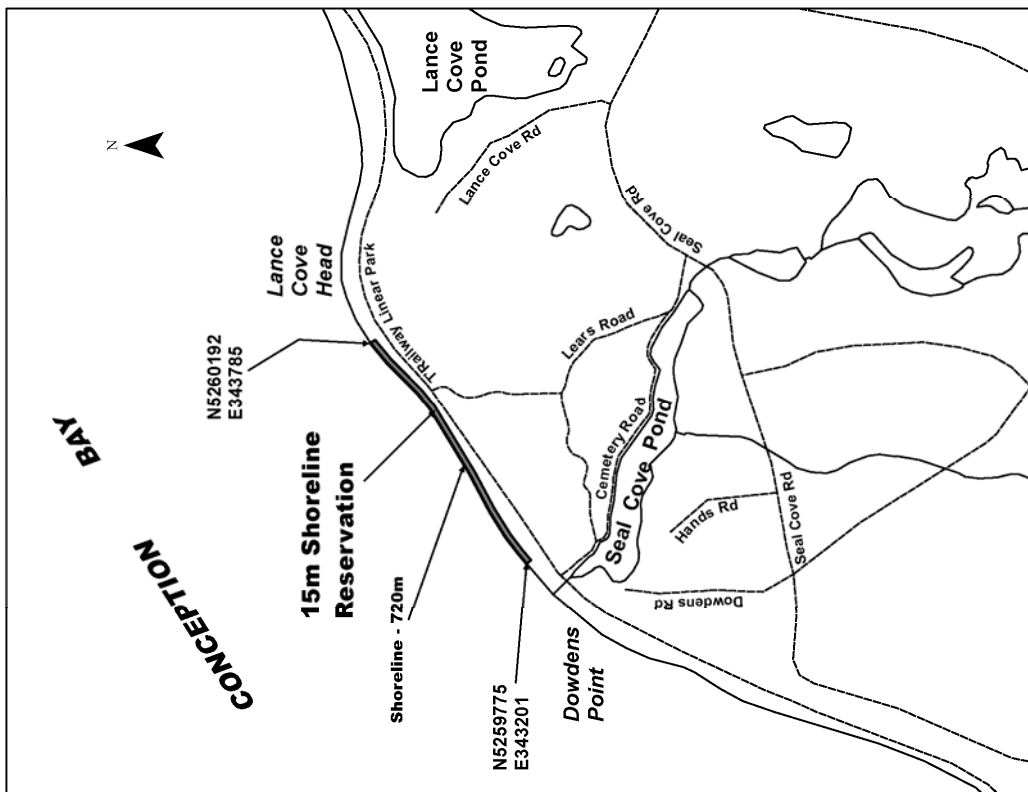

Apr 26

NOTICE OF INTENT
Lands Act, c36, SNL 1991, as amended

NOTICE IS HEREBY given that NALCOR ENERGY of St. John's, NL intends to apply to the Department of Environment and Conservation, two months from the publication of this Notice, to acquire title, pursuant to Subsection 7(2)(a) of the Act, to that piece of Crown land situated within fifteen (15) metres of the waters of Strait of Belle Isle at L'Anse au Diable in the Electoral District of Cartwright-L'Anse au Clair for the purpose of a shoreline electrode site. The land is described as follows:

All that land along the northerly shoreline of the waters of Strait of Belle Isle at L'Anse au Diable;

Beginning at coordinates of North 5712079 metres and East 517066 metres and ending at coordinates of North 5712293 metres and East 517590 metres;
Bounded on the north by Crown land for a distance of 1175 metres;
Bounded on the east by the shoreline reservation for a distance of 15 metres;
Bounded on the south by the northerly shoreline of the waters of Strait of Belle Isle for a distance of 1175 metres; Bounded on the west by the shoreline reservation for a distance of 15 metres;

Also including the small island located immediately to the south of the said shoreline; and containing an area of approximately 1.9 hectares.

All coordinates are UTM Zone 21 NAD83 and are approximate as scaled from map NTS: 12P10.

Any person wishing to object to the application must file the objection, in writing, within one month from the publication of this Notice, with reasons for it, to the Minister of Environment and Conservation, and mail to the nearest Regional Lands Office:

c/o Eastern Regional Lands Office, P.O. Box 8700, 5 Mews Place, St. John's, NL, A1B 4J6.

c/o Central Regional Lands Office, P.O. Box 2222, Gander, NL, A1V 1L7.

c/o Western Regional Lands Office, P.O. Box 2006, Noton Building, Corner Brook, NL, A2H 6J8.

c/o Labrador Regional Lands Office, P.O. Box 3014, Station "B", Happy Valley-Goose Bay, NL, A0P 1E0.

For further information on the proposed application, please contact: John Cooper at NALCOR ENERGY. Telephone number: (709) 737-1944.

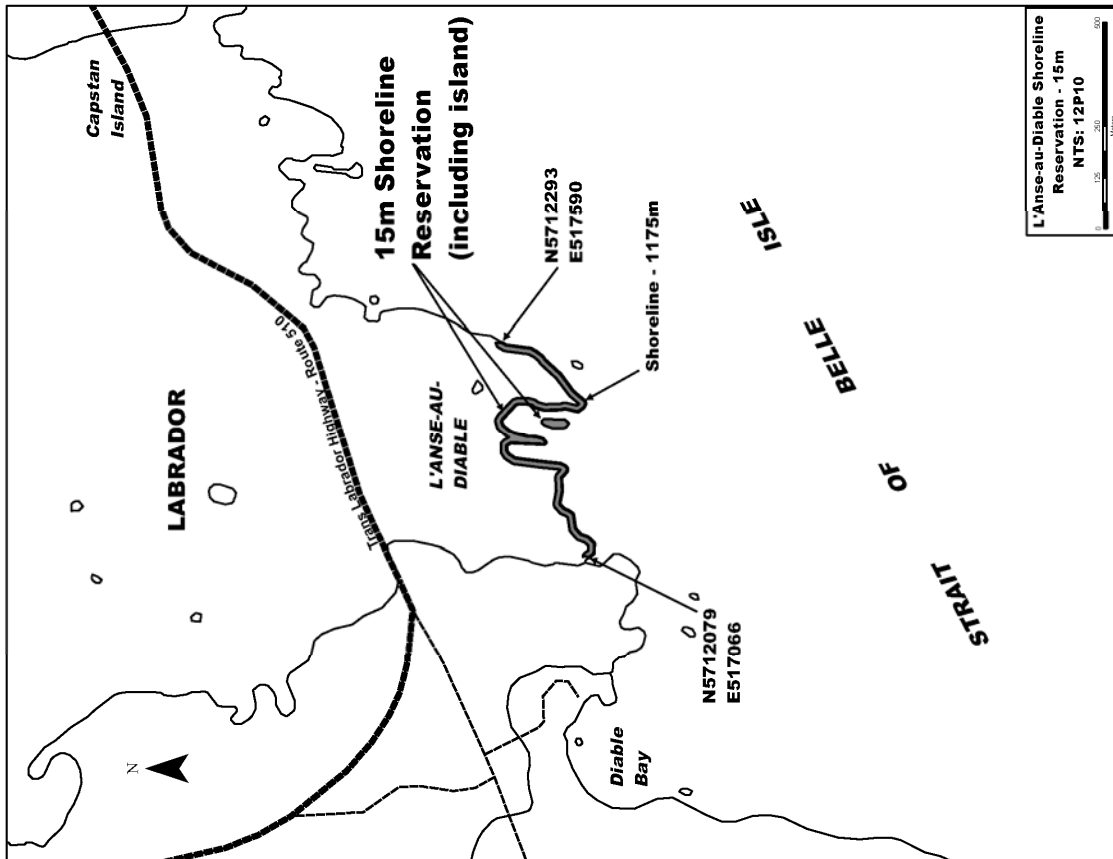

NOTICE OF INTENT
Lands Act, c36, SNL 1991, as amended

*and containing an area of
approximately 46 hectares.*

NOTICE IS HEREBY given that NALCOR ENERGY of St. John's, NL intends to apply to the Department of Environment and Conservation, two months from the publication of this Notice, to acquire title, pursuant to Subsection 7(2)(a) of the Act, to the shoreline reservations, fifteen (15) metres wide, of any and all ponds and streams contained within the hereinafter described parcel of Crown land located to the north of Soldiers Pond and to the east of the Trans Canada Highway in the Electoral District of Ferryland for the purpose of a converter station site. The land is described as follows:

*Bounded on the north by Crown land
for a distance of 745 metres;
Bounded on the east by Crown land
for a distance of 695 metres;
Bounded on the south by an overhead transmission line
for a distance of 775 metres;
Bounded on the west by Crown land
for a distance of 490 metres;*

Any person wishing to object to the application must file the objection, in writing, within one month from the publication of this Notice, with reasons for it, to the Minister of Environment and Conservation, and mail to the nearest Regional Lands Office:

c/o Eastern Regional Lands Office, P.O. Box 8700, 5 Mews Place, St. John's, NL, A1B 4J6.

c/o Central Regional Lands Office, P.O. Box 2222, Gander, NL, A1V 1L7.

c/o Western Regional Lands Office, P.O. Box 2006, Noton Building, Corner Brook, NL, A2H 6J8.

c/o Labrador Regional Lands Office, P.O. Box 3014, Station "B", Happy Valley-Goose Bay, NL, A0P 1E0.

For further information on the proposed application, please contact: John Cooper at NALCOR ENERGY. Telephone number: (709) 737-1944.

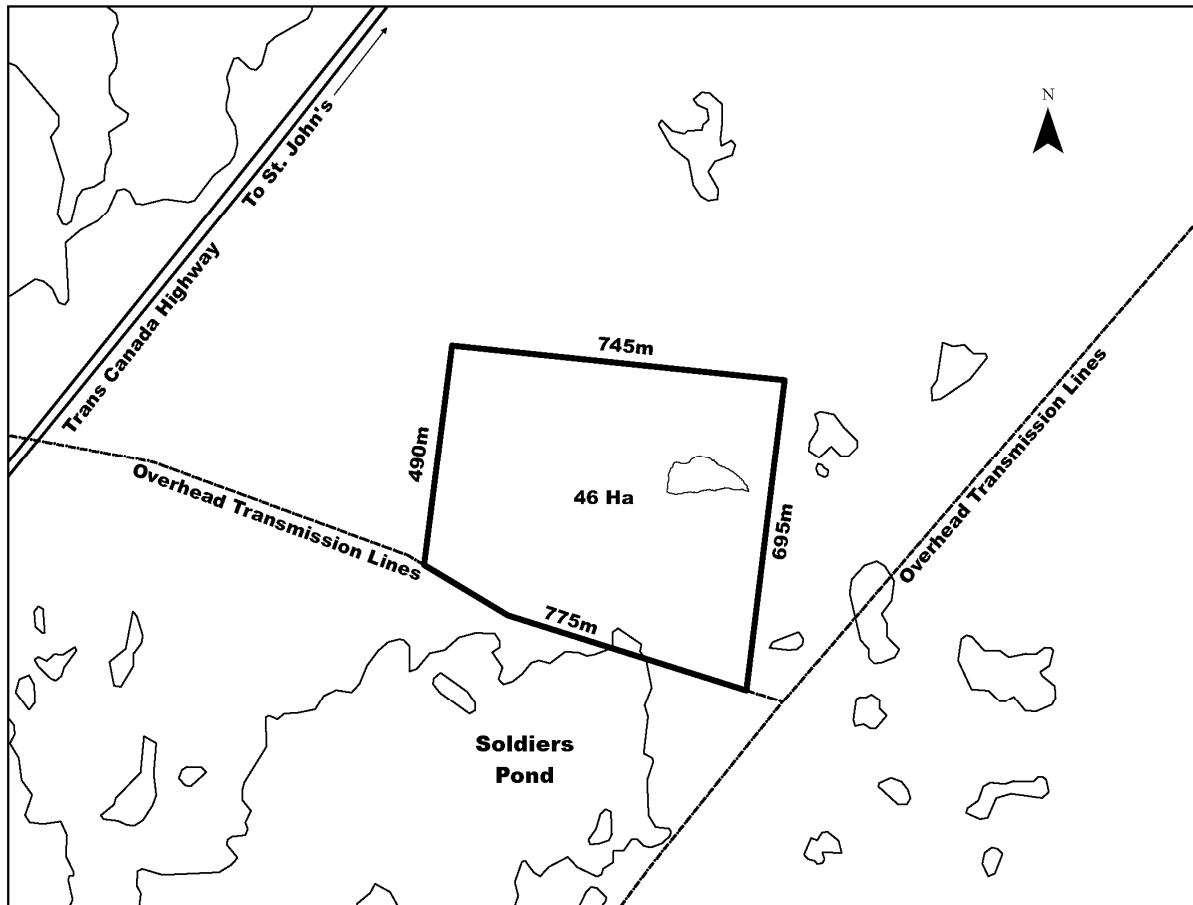

NOTICE OF INTENT
Lands Act , c36, SNL 1991, as amended

NOTICE IS HEREBY given that ROBIN SMITH of Port Saunders, NL, intends to apply to the Department of Environment and Conservation, two months from the publication of this notice, to acquire title, pursuant to Section 7(2)(e) of the said Act, to that piece of Crown land situated within fifteen (15) metres of the waters of Port Saunders in the Electoral District of St. Barbe for the purpose of a dock and boathouse. The land is described as follows:

*Bounded on the North by residential land
for a distance of 50 metres;*
*Bounded on the East by industrial/commercial land
for a distance of 35 metres;*
*Bounded on the South by Port Saunders Harbour
for a distance of 0 metres;*
*Bounded on the West by industrial/commercial land
for a distance of 15 metres;*
*and containing an area of
approximately 1500 square metres.*

Any person wishing to object to the application must file the objection, in writing, within one month from the publication of this Notice, with reasons for it, to the Minister of Environment and Conservation, and mail to the nearest Regional Lands Office:

c/o Eastern Regional Lands Office, P.O. Box 8700, 5 Mews Place, St. John's, NL, A1B 4J6.

c/o Central Regional Lands Office, P.O. Box 2222, Gander, NL, A1V 1L7.

c/o Western Regional Lands Office, P.O. Box 2006, Noton Building, Corner Brook, NL, A2H 6J8.

c/o Labrador Regional Lands Office, P.O. Box 3014, Station "B", Happy Valley-Goose Bay, NL, A0P 1E0.

For further information on the proposed application, please contact: ROBIN SMITH. Telephone number: (709) 861-3339.

Apr 26

NOTICE OF INTENT
Lands Act , c36, SNL 1991, as amended

NOTICE IS HEREBY given that CLUNEY VINCENT of Triton, NL intends to apply to the Department of Environment and Conservation, two months from the publication of this notice, to acquire title, pursuant to Section 7(2) of the said Act, to that piece of Crown land situated within fifteen (15) metres of the waters of Jim's Cove/Triton, NL in the Electoral District of Grand Falls Windsor-Green Bay South for the purpose of residential. The land is described as follows:

*Bounded on the North by S 69° 34' W
for a distance of 18.55 metres;*

*Bounded on the East by Crown land reservation
for a distance of 15 metres;*
*Bounded on the South by Crown land reservation
for a distance of 18.55 metres;*
*Bounded on the West by Crown land reservation
for a distance of 15 metres;*
*and containing an area of
approximately 271 square metres.*

Any person wishing to object to the application must file the objection, in writing, within one month from the publication of this Notice, with reasons for it, to the Minister of Environment and Conservation, and mail to the nearest Regional Lands Office:

c/o Eastern Regional Lands Office, P.O. Box 8700, 5 Mews Place, St. John's, NL, A1B 4J6.

c/o Central Regional Lands Office, P.O. Box 2222, Gander, NL, A1V 1L7.

c/o Western Regional Lands Office, P.O. Box 2006, Noton Building, Corner Brook, NL, A2H 6J8.

c/o Labrador Regional Lands Office, P.O. Box 3014, Station "B", Happy Valley-Goose Bay, NL, A0P 1E0.

For further information on the proposed application, please contact: CLUNEY VINCENT. Telephone number: (709) 263-6154.

Apr 26

NOTICE OF INTENT
Lands Act , c36, SNL 1991, as amended

NOTICE IS HEREBY given that WALSH BROTHERS of Southern Harbour, NL intends to apply to the Department of Environment and Conservation, two months from the publication of this notice, to acquire title, pursuant to Section 7(2)(e) of the said Act, to that piece of Crown land situated within fifteen (15) metres of the waters of Southern Harbour, Placentia Bay, NL in the Electoral District of Bellevue for the purpose of constructing a boathouse. The land is described as follows:

*Bounded on the North by former farm road
used by Best family of Southern Harbour
for a distance of 38 metres;*
*Bounded on the Department of
Transportation and Works turnaround
for a distance of 14 metres;*
*Bounded on the South by high water mark
for a distance of 38 metres;*
*Bounded on the West by Walsh's Stage
for a distance of 10 metres;*
*and containing an area of
approximately 456 square metres.*

Any person wishing to object to the application must file the objection, in writing, within one month from the publication of this Notice, with reasons for it, to the

Minister of Environment and Conservation, and mail to the nearest Regional Lands Office:

c/o Eastern Regional Lands Office, P.O. Box 8700, 5 Mews Place, St. John's, NL, A1B 4J6.

c/o Central Regional Lands Office, P.O. Box 2222, Gander, NL, A1V 1L7.

c/o Western Regional Lands Office, P.O. Box 2006, Noton Building, Corner Brook, NL, A2H 6J8.

c/o Labrador Regional Lands Office, P.O. Box 3014, Station "B", Happy Valley-Goose Bay, NL, A0P 1E0.

For further information on the proposed application, please contact: BRIAN WALSH, Telephone number: (709) 463-2123, or PETER WALSH, Telephone number: (709) 463-8585.

Apr 26

NOTICE OF INTENT
Lands Act , c36, SNL 1991, as amended

NOTICE IS HEREBY given that the TOWN OF SANDY COVE, Bonavista Bay, NL intends to apply to the Department of Environment and Conservation, two months from the publication of this notice, to acquire a "License to Occupy" (LTO) Crown Land around Sandy Cove Pond, for the purpose of a walking trail. The said property would be 6 metres wide and 3 km long.

Any person wishing to object to the application must file the objection, in writing, within one month from the publication of this Notice, with reasons for it, to the Minister of Environment and Conservation, and mail to the nearest Regional Lands Office:

c/o Eastern Regional Lands Office, P.O. Box 8700, 5 Mews Place, St. John's, NL, A1B 4J6.

c/o Central Regional Lands Office, P.O. Box 2222, Gander, NL, A1V 1L7.

c/o Western Regional Lands Office, P.O. Box 2006, Noton Building, Corner Brook, NL, A2H 6J8.

c/o Labrador Regional Lands Office, P.O. Box 3014, Station "B", Happy Valley-Goose Bay, NL, A0P 1E0.

For further information on the proposed application, please contact: TOWN OF SANDY COVE. Telephone number: (709) 677-2731.

Apr 26

TRUSTEE ACT

ESTATE NOTICE

IN THE MATTER of the Estate of FRANCIS PATRICK BARRON, late of St. John's, in the Province of Newfoundland and Labrador, deceased.

All persons claiming to be creditors of or who have any claims or demands either as beneficiaries or next of kin (by blood, legal adoption or marriage) upon or affecting the Estate of FRANCIS PATRICK BARRON, Gentleman, who died at St. John's, NL on or about February 27th, 2010 are hereby requested to send the particulars of the same in writing, duly attested, to the Office of the Public Trustee, 401-136 Crosbie Road, St. John's, NL, A1B 3K3, Administrator of the Estate of FRANCIS PATRICK BARRON, on or before the May 31st, 2013, after which date the said Administrator will proceed to distribute the Estate having regard only to the claims of which he then shall have had notice.

DATED at St. John's, Newfoundland and Labrador, this 26th day of April, 2013.

OFFICE OF THE PUBLIC TRUSTEE
Administrator of the Estate of
FRANCIS PATRICK BARRON

ADDRESS FOR SERVICE:
Suite 401, 136 Crosbie Road
St. John's , NL A1B 3K3

Tel: (709) 729-1025
Fax: (709) 729-3063

Apr 26

ESTATE NOTICE

IN THE MATTER OF the Estate of FLORENCE CECELIA GABRIEL, late of Halifax, in the Province of Nova Scotia, formerly of St. George's, Newfoundland and Labrador, Widow, Housewife, Deceased.

All persons claiming to be creditors of or who have any claims or demands upon or affecting the Estate of FLORENCE CECLIA GABRIEL, late of the City of Halifax, Nova Scotia, formerly of St. George's Newfoundland and Labrador deceased, are hereby requested to send particulars of the same in writing, duly attested, to the undersigned Solicitor for the Executrix of the Estate on or before the 27th day of May, 2013, after which date the said Executrix will proceed to distribute the said Estate having regard only to the claims of which notice shall have been received.

DATED at Stephenville, Newfoundland and Labrador, this 19th day of April, 2013.

MILLS & GALLANT
Solicitors for the Executrix
PER: Susan H. Gallant

ADDRESS FOR SERVICE:
P.O. Box 447
87 Gallant Street
Stephenville, NL A2N 3A3

Tel: (709) 643-5688
Fax: (709) 643-2906

Apr 26

ESTATE NOTICE

IN THE MATTER of the Estate of LEONARD JAMES PELLEY, late of the City of Corner Brook, in the Province of Newfoundland and Labrador, Retired Meter Reader, Deceased.

All persons claiming to be creditors of or who have any claims or demands upon or affecting the Estate of LEONARD JAMES PELLEY, late of the City of Corner Brook, in the Province of Newfoundland and Labrador, deceased, are hereby requested to send particulars of the same in writing, duly attested to the undersigned Solicitors for the Administrator of the Estate on or before the 17th day of May, 2013, after which date the said Administrator will proceed to distribute the said Estate having regard only to the claims of which he shall then have had notice.

DATED at Corner Brook, Newfoundland and Labrador, this 19th day of April, 2013.

POOLE ALTHOUSE
Solicitors for the Administrator
PER: J. Annette Bennett

ADDRESS FOR SERVICE:
49-51 Park Street
Corner Brook, NL A2H 2X1

Tel: (709) 634-3136
Fax: (709) 634-8247

Apr 26



THE NEWFOUNDLAND AND LABRADOR GAZETTE

PART II

SUBORDINATE LEGISLATION FILED UNDER THE STATUTES AND SUBORDINATE LEGISLATION ACT

Vol. 88

ST. JOHN'S, FRIDAY, APRIL 26, 2013

No. 17

NEWFOUNDLAND AND LABRADOR REGULATION

NLR 44/13



**NEWFOUNDLAND AND LABRADOR
REGULATION 44/13**

*Members' Resources and Allowances Rules
(Amendment)
under the
House of Assembly Accountability, Integrity
and Administration Act*

(Filed April 25, 2013)

Under the authority of subsections 15(5) and 20(7) and section 64 of the *House of Assembly Accountability, Integrity and Administration Act*, as tabled before the House of Assembly Management Commission on March 20, 2013 and tabled in the House of Assembly on March 27, 2013, and further to a resolution adopted by the House of Assembly on April 18, 2013 and as approved by the House of Assembly Management Commission on April 23, 2013, the House of Assembly Management Commission makes the following rules.

Dated at St. John's, April 24, 2013.

Ross Wiseman
Chairperson, House of Assembly Management Commission
and Speaker of the House of Assembly

REGULATIONS

Analysis

- | | |
|--|---|
| 1. S.10 Amdt.
Monthly reports | 3. S.19 Amdt.
Eligibility for constituency
office accommodation |
| 2. S.18 Amdt.
Eligibility for office expenses | 4. S.20 Amdt.
Nature and location |

*Members' Resources and Allowances Rules
(Amendment)*

44/13

- | | |
|---|--|
| 5. S.33.1 Added
Commuting from outside
capital region | 8. S.46 Amdt
Expenses related to constitu-
ency work |
| 6. S.38 Amdt.
Intra-constituency travel al-
lowance | 9. Sch. R&S
Schedule A
Schedule B |
| 7. S.38.1 Added
Helicopter travel | |

SNL2007 cH-10.01
Sch. as amended

1. Section 10 of the *Members' Resources and Allowances Rules* is amended by adding immediately after subsection (2) the following:

(2.1) Subsection (2) does not apply to an allowance claimed under subsection 19(4).

2. (1) Subsections 18(2) and (3) of the Rules are repealed and the following substituted:

(2) A member is entitled to the constituency office accommodation expenses described in subsection 19(1).

(3) The maximum allowance available to a member for office operations and supplies is \$12,000.

(2) Subsection 18(4) of the Rules is repealed.

3. Subsection 19(1) of the Rules is amended by deleting the words and reference "allowance referred to in paragraph 18(2)(a)" and substituting the words and reference "expenses referred to in subsection 18(2)".

4. Subsection 20(7) of the Rules is repealed.

5. The Rules are amended by adding immediately after section 33 the following:

Commuting from
outside capital
region

33.1 (1) Notwithstanding sections 31 and 33, a member whose permanent residence is outside the capital region at a distance greater than commuting distance may opt to travel between that residence and the capital region each day that the House of Assembly is in session and sitting and may claim the actual transportation cost of each daily return trip.

(2) A member who opts to claim an actual transportation cost for a day under subsection (1) cannot claim for costs described in paragraphs 31(1)(b) and (c) and 33(b) and (c).

(3) This section shall apply only to members who represent the districts of

- (a) Bellevue;
- (b) Carbonear - Harbour Grace;
- (c) Ferryland;
- (d) Harbour Main;
- (e) Placentia - St. Mary's;
- (f) Port de Grave; and
- (g) Trinity - Bay de Verde.

6. Subsection 38(3) of the Rules is repealed and the following substituted:

(3) The maximum amount in respect of an electoral district for which a member who represents that district may claim in a fiscal year for intra-constituency travel is the amount set out in Schedule A.

7. The Rules are amended by adding immediately after section 38 the following:

Helicopter travel

38.1 (1) Where less expensive travel is not available, a member from a district listed in Schedule B may, with the prior approval of the Speaker, be reimbursed for the cost of helicopter travel while acting on constituency business within his or her constituency.

(2) The maximum amount which a member may claim in a fiscal year for intra-constituency travel under this section is the amount set out in Schedule B.

8. Subsection 46(3) of the Rules is amended by adding immediately after paragraph (e.1) the following:

(e.2) the expenses of renting short term accommodation in one or more locations in the member's constituency to facilitate travel of the member throughout the district to meet with residents on constituency issues;

9. The Schedule to the Rules is repealed and the following substituted:

Schedule A

House Operations
Estimates of Intra-constituency Costs

District No.	Electoral District	Total
1	Baie Verte - Springdale	\$10,100
2	Bay of Islands	12,500
3	Bellevue	13,100
4	Bonavista North	10,100
5	Bonavista South	10,100
6	Burgeo - LaPoile	11,300
7	Burin - Placentia West	8,200
8	Cape St. Francis	7,200
9	Carbonear - Harbour Grace	7,700
10	Cartwright - L'Anse au Clair	25,600
11	Conception Bay East - Bell Island	7,700
12	Conception Bay South	7,200
13	Exploits	10,100
14	Ferryland	10,100
15	Fortune Bay - Cape La Hune	16,300
16	Gander	7,100
17	Grand Bank	12,000
18	Grand Falls-Windsor - Buchans	9,100
19	Grand Falls-Windsor - Green Bay South	7,200
20	Harbour Main	6,900
21	Humber East	6,300
22	Humber Valley	12,000
23	Humber West	8,200
24	Kilbride	7,200
25	Labrador West	7,700
26	Lake Melville	8,000
27	Lewisporte	9,200
28	Mount Pearl North	6,000

*Members' Resources and Allowances Rules
(Amendment)*

44/13

District No.	Electoral District	Total
29	Mount Pearl South	6,000
30	Placentia - St. Mary's	11,500
31	Port au Port	6,800
32	Port de Grave	7,700
33	Signal Hill - Quidi Vidi	6,000
34	St. Barbe	11,900
35	St. George's - Stephenville East	7,700
36	St. John's Centre	6,000
37	St. John's East	6,000
38	St. John's North	6,000
39	St. John's South	6,000
40	St. John's West	6,000
41	Terra Nova	10,200
42	The Isle of Notre Dame	9,800
43	The Straits - White Bay North	10,100
44	Topsail	6,000
45	Tornгат Mountains	20,700
46	Trinity - Bay de Verde	8,600
47	Trinity North	8,200
48	Virginia Waters	6,000
	Total	<u>\$442,000</u>

Schedule B

Helicopter Allocation

Electoral District	Total
Burgeo - LaPoile	\$21,000
Cartwright - L'Anse au Clair	21,000
Fortune Bay - Cape La Hune	24,600
Torngat Mountains	10,500

©Queen's Printer

Index

PART I

Corporations Act – Notice	151
Lands Act – Notices	151
Trustee Act – Notices	125

PART II

CONTINUING INDEX OF SUBORDINATE LEGISLATION

Title of Act and Subordinate Legislation made thereunder	CNLR or NL Reg.	Amendment	NL Gazette Date & Page No.
House of Assembly Accountability, Integrity and Administration Act			
Members' Resources, and Allowances Rules (Amdt.)	NLR 44/13	Amends SNL 2007 cH-10.10 Sch. S.10 Amdt. Ss.18, 19, & 20 Amdt. S.33.1 Added S.46 Amdt. Sch. R&S	Apr 26/13 p. 219

The Newfoundland and Labrador Gazette is published from the Office of Queen's Printer.

Copy for publication must be received by **Friday, 4:30 p.m.**, seven days before publication date to ensure inclusion in next issue.

Advertisements must be submitted in either PDF format or as a MSWord file. When this is not possible, advertisements must be either typewritten or printed legibly, separate from covering letter. Number of insertions required must be stated and the names of all signing officers typewritten or printed.

Copy may be mailed to the address below, faxed to (709) 729-1900 or emailed to queensprinter@gov.nl.ca.

Advertising rates are available upon request. Subscription rate for *The Newfoundland and Labrador Gazette* is \$125.00 for 52 weeks plus applicable tax (\$131.25). Weekly issues of \$3.00 per copy, plus tax payable in advance.

All cheques, money orders, etc., should be made payable to THE NEWFOUNDLAND EXCHEQUER ACCOUNT and all correspondence should be addressed to: Office of the Queen's Printer, P. O. Box 8700, Ground Floor, East Block, Confederation Building, St. John's, NL A1B 4J6. Telephone (709) 729-3649. Fax: (709) 729-1900.

Web Site: <http://www.servicenl.gov.nl.ca/printer/index.html>

**Place your order by contacting:
Office of The Queen's Printer
Confederation Building, East Block
St. John's, NL A1B 4J6
Telephone: (709) 729-3649 Fax: (709) 729-1900
email: queensprinter@gov.nl.ca**

**Government Information Product
Publication Rate Mail
G.S.T. # R107442683**

All requests for Subscription and Legislation MUST be prepaid.