

THE NEWFOUNDLAND AND LABRADOR GAZETTE

PART I

PUBLISHED BY AUTHORITY

Vol. 88

ST. JOHN'S, FRIDAY, OCTOBER 4, 2013

No. 40

MINERAL ACT

NOTICE

Published in accordance with section 62 of CNLR 1143/96 under the *Mineral Act*, RSNL1990 cM-12, as amended.

Mineral rights to the following mineral licenses have reverted to the Crown:

Mineral License 011550M
Held by Courtney, Stephen
Situate near Charles Brook, Central NL
On map sheet 02E/06

A portion of license 011224M
Held by Paragon Minerals Corporation
Situate near Snooks Arm, Baie Verte Peninsula
On map sheet 02E/13
more particularly described in an application on file at Department of Natural Resources.

Mineral License 020377M
Held by Quest Rare Minerals Ltd.
Situate near Fraser River
On map sheet 24A/08

Mineral License 013596M
Held by Hicks, Darrin
Situate near St. Patricks, Central NL
On map sheet 02E/12

A portion of license 020970M
Held by Newfoundland Fluorspar Exploration Ltd.
Situate near St. Lawrence, Burin Peninsula
On map sheet 01L/14
more particularly described in an application on file at Department of Natural Resources.

Mineral License 020725M
Held by Rose, Shawn
Situate near Southwest Brook, West - Central NL
On map sheet 12A/05

Mineral License 017760M
Held by Silver Spruce Resources Inc.
Situate near Barge Bay Area
On map sheet 03D/04

Mineral License 017762M
Held by Silver Spruce Resources Inc.
Situate near Barge Bay Area
On map sheet 13A/01

Mineral License 017763M
Held by Silver Spruce Resources Inc.
Situate near Barge Bay
On map sheet 12P/16

Mineral License 018881M
Held by Noel, E. Michele
Situate near Ten Mile Pond, Burin Peninsula
On map sheet 01M/09, 01M/10

THE NEWFOUNDLAND AND LABRADOR GAZETTE

October 4, 2013

Mineral License Held by Situates near On map sheet	019100M Turpin, Alec Clanceys Pond, Burin Peninsula 01M/03	Mineral License Held by Situates near On map sheet	020282M Humby, Eli Gander Lake Area, Central NL 02D/15
Mineral License Held by Situates near On map sheet	019102M Stone, Albert Red Harbour Area, Burin Peninsula 01M/06	Mineral License Held by Situates near On map sheet	020283M Humby, Eli Gander Lake Area, Central NL 02D/15
Mineral License Held by Situates near On map sheet	019104M Hurley, Wayne Indian Pond, Central NL 12H/08, 12H/07	Mineral License Held by Situates near On map sheet	020284M Humby, Eli Gander Lake Area, Central NL 02D/15
Mineral License Held by Situates near On map sheet	020049M Noel, Nathaniel Rocky Pond Area, Central NL 02E/02	Mineral License Held by Situates near On map sheet	020285M Stares, Shane Frenchman Cove, Southern NL 01M/12
Mineral License Held by Situates near On map sheet	020258M Altius Resources Inc. Great Gull River, Central NL 02D/11, 02D/12	Mineral License Held by Situates near On map sheet	020286M Stone, Albert Red Harbour Area, Burin Peninsula 01M/06
Mineral License Held by Situates near On map sheet	020259M Morgan, Allan Strouds Pond Area, Burin Peninsula 01M/03	Mineral License Held by Situates near On map sheet	020287M P. Walsh Jr., Joseph Red Harbour Area, Burin Peninsula 01M/03, 01M/06
Mineral License Held by Situates near On map sheet	020260M Quinlan, Tony Isabella Falls 13L/02	Mineral License Held by Situates near On map sheet	020288M Puddle Pond Resources Inc. Red Harbour Area, Burin Peninsula 01M/03, 01M/06
Mineral License Held by Situates near On map sheet	020261M Quinlan, Tony Isabella Falls 13L/02	Mineral License Held by Situates near On map sheet	020289M Puddle Pond Resources Inc. Red Harbour Area, Burin Peninsula 01M/06
Mineral License Held by Situates near On map sheet	020262M Stares, Shane Olive Cove, Southern NL 01M/12	Mineral License Held by Situates near On map sheet	020290M Puddle Pond Resources Inc. Red Harbour Area, Burin Peninsula 01M/06
Mineral License Held by Situates near On map sheet	020263M McFtridge, Heather Fischells Area, Western NL 12B/07	Mineral License Held by Situates near On map sheet	020291M Byrne, Patrick Wet Tilt Hill, Burin Peninsula 01M/03
Mineral License Held by Situates near On map sheet	020264M Budden, Andy Dead Wolf Brook, Central NL 02D/10	Mineral License Held by Situates near On map sheet	020292M Byrne, Debbie Wet Tilt Hill, Burin Peninsula 01M/03
Mineral License Held by Situates near On map sheet	020267M McFtridge, Heather Fischells Area, Western NL 12B/07	Mineral License Held by Situates near On map sheet	020300M Denty, Paul Culls Harbour, Eastern NL 02C/12
Mineral License Held by Situates near On map sheet	020269M Budden, Andy Dead Wolf Brook, Central NL 02D/10	Mineral License Held by Situates near On map sheet	020309M Turpin, Alec Clattice Harbour, Burin Peninsula 01M/08, 01M/09
Mineral License Held by Situates near On map sheet	020270M McFtridge, Heather Fischells Area, Western NL 12B/07	Mineral License Held by Situates near On map sheet	020310M Turpin, Alec Monkstown, Burin Peninsula 01M/09

Mineral License 020311M
Held by Turpin, Alec
Situate near South East Bight, Burin Peninsula
On map sheet 01M/07

Mineral License 020312M
Held by Lannon, George
Situate near Great Rattling Brook, Central NL
On map sheet 02D/13

A portion of license 020511M
Held by Paragon Minerals Corporation
Situate near Snooks Arm, Baie Verte Peninsula
On map sheet 02E/13
more particularly described in an application on file at Department
of Natural Resources

The lands covered by this notice except for the lands within
Exempt Mineral Lands, the Exempt Mineral Lands being
described in CNLR 1143/96 and NLR 71/98, 104/98,
97/00, 36/01, 31/04, 78/06, 8/08, 28/09 and 5/13 and
outlined on 1:50 000 scale digital maps maintained by the
Department of Natural Resources, will be open for staking
after the hour of 9:00 a.m. on the 32nd clear day after the
date of this publication.

DEPARTMENT OF NATURAL RESOURCES
JUSTIN LAKE
Manager - Mineral Rights

File #s 774: 5295, 5683, 6309, 7177, 8424;
775: 0732, 1185, 1187, 1189, 1190, 2191, 2380,
2382, 2384, 3105, 3242, 3248, 3249, 3250,
3251, 3252, 3253, 3254, 3257, 3259, 3260,
3264, 3265, 3266, 3267, 3268, 3269, 3270,
3271, 3272, 3273, 3274, 3275, 3277, 3278,
3279, 3280, 3435

Oct 4

MUNICIPALITIES ACT, 1999

**NOTICE OF INTENT
RESPECTING A FEASIBILITY STUDY**

I, KEVIN O'BRIEN, MINISTER OF MUNICIPAL
AFFAIRS, pursuant to Section 10 of the *Municipalities Act,
1999*, hereby give Notice of my intent to order a Feasibility
Study to be prepared into the Town of Carbonear's
proposal to extend the Carbonear municipal boundary to
include an unincorporated area north of the Town of
Carbonear including developed land on the north side of
Columbus Drive, opposite English Hill, and an area north
of Hoyles Road towards a pond called Lily Pond.

Dated at St. John's, Newfoundland and Labrador, this 12th
day of September, 2013.

DEPARTMENT OF MUNICIPAL AFFAIRS
Kevin O'Brien, Minister

Oct 4

CITY OF ST. JOHN'S ACT



**ST. JOHN'S MUNICIPAL COUNCIL
NOTICE
ST. JOHN'S COMMERCIAL PROPERTY TAX
(AMENDMENT NO. 1-2013) BY-LAW**

TAKE NOTICE that the ST. JOHN'S MUNICIPAL
COUNCIL has enacted the St. John's Commercial Property
Tax (Amendment No. 1 - 2013) By-Law.

The said By-Law was passed by Council on the 23rd day of
September, 2013, so as to provide for vacancy relief where
the tenant of leased premises is exempt from municipal
taxation by virtue of provincial or federal legislation.

All persons are hereby required to take notice that any
person who wishes to view such Regulations may view
same at the Office of the City Solicitor of the ST. JOHN'S
MUNICIPAL COUNCIL at City Hall, and that any person
who wishes to obtain a copy thereof may obtain it at the
said office upon the payment of a reasonable charge as
established by the St. John's Municipal Council for such
copy.

Dated this 23rd day of September, 2013.

CITY OF ST. JOHN'S
Neil Martin - City Clerk

Oct 4

**ST. JOHN'S MUNICIPAL COUNCIL
NOTICE
ST. JOHN'S PROPERTY TAX EXEMPTION
O'BRIEN FARM FOUNDATION
INCORPORATED BY-LAW**

TAKE NOTICE that the ST. JOHN'S MUNICIPAL
COUNCIL has enacted the St. John's Property Tax
Exemption O'Brien Farm Foundation Incorporated By-
Law.

The said By-Law was passed by Council on the 23rd day of
September, 2013, so as to exempt property held by the
O'Brien Farm Foundation Incorporated and situate in the
area of Mount Scio Road and Oxen Pond Road from the
real property tax.

All persons are hereby required to take notice that any
person who wishes to view such Regulations may view
same at the Office of the City Solicitor of the ST. JOHN'S
MUNICIPAL COUNCIL at City Hall, and that any person
who wishes to obtain a copy thereof may obtain it at the

said office upon the payment of a reasonable charge as established by the ST. JOHN'S MUNICIPAL COUNCIL for such copy.

Dated this 23rd day of September, 2013.

CITY OF ST. JOHN'S
Neil Martin - City Clerk

Oct 4

URBAN AND RURAL PLANNING ACT, 2000
NOTICE OF REGISTRATION
ST. JOHN'S DEVELOPMENT REGULATIONS
AMENDMENT NO. 582, 2013

TAKE NOTICE that the ST. JOHN'S Development Regulations Amendment Number 582, 2013 adopted on the 12th day of September, 2013, has been registered by the Minister of Municipal Affairs.

In general terms, the purpose of Development Regulations Amendment Number 582, 2013 is to rezone land at 163 Blackhead Road from the Apartment Low Density (A1) Zone to the Residential Medium Density (R2) Zone.

This amendment comes into effect on the date that this notice is printed in *The Newfoundland and Labrador Gazette*. Anyone who wishes to inspect a copy of the amendment may do so at the Department of Planning, Development and Engineering, 3rd Floor, St. John's City Hall during regular business hours.

CITY OF ST. JOHN'S
Ken O'Brien, MCIP – Chief Municipal Planner

Oct 4

NOTICE OF REGISTRATION
TOWN OF MARYSTOWN
MUNICIPAL PLAN
AMENDMENT NO. 23, 2013
AND
DEVELOPMENT REGULATIONS
AMENDMENT NO. 31, 2013

TAKE NOTICE that the TOWN OF MARYSTOWN Municipal Plan Amendment No. 23, 2013 and Development Regulations Amendment No. 31, 2013 as adopted on the 18th day of June, 2013 and approved on the 16th day of July, 2013, have been registered by the Minister of Municipal Affairs.

In general terms the purpose of the Municipal Plan Amendment No. 23 and Development Regulations Amendment No. 31 is to accommodate residential development off Dunphy's Road in the Marine Drive area by redesignating and rezoning this area from Rural to Residential.

The Municipal Plan Amendment No. 23, 2013 and Development Regulations Amendment No. 31, 2013 come into effect on the day that this notice is published in *The Newfoundland and Labrador Gazette*.

Anyone who wishes to inspect a copy of the Marystown Municipal Plan Amendment No. 23, 2013 and

Development Regulations Amendment No. 31, 2013 may do so at the Marystown Town Office during normal working hours.

TOWN OF MARYSTOWN
Dennis Kelly, Town Clerk

Oct 4

NOTICE OF REGISTRATION
TOWN OF PARADISE
MUNICIPAL PLAN
AMENDMENT No. 27, 2012
DEVELOPMENT REGULATIONS
AMENDMENT No. 68, 2012

TAKE NOTICE that the TOWN OF PARADISE Municipal Plan Amendment No. 27, 2012 and Development Regulations Amendment No. 68, 2012, adopted on the 6th day of August, 2013 and approved on the 3rd day of September, 2013, have been registered by the Minister of Municipal Affairs.

In general terms, the Municipal Plan Amendment re-designates land bordering the eastern side of Adams Pond from Public Use to Residential. The Development Regulation Amendment rezones this property from Public Use (PU) to Residential High Density (RHD), and a portion from Residential Medium Density (RMD) to Residential High Density (RHD). The purpose of the amendments is to facilitate a thirty-four (34) unit condominium development.

The amendments come into effect on the day that this notice is published in *The Newfoundland and Labrador Gazette*. Anyone wishing to inspect a copy of Municipal Plan Amendment No. 27, 2012 and Development Regulations Amendment No. 68, 2012 may do so at the Paradise Town Hall, 28 McNamara Drive, during normal hours of operation.

TOWN OF PARADISE
Terrilynn Smith, Town Clerk

P. O. #36223

Oct 4

NOTICE OF REGISTRATION
TOWN OF SUNNYSIDE
DEVELOPMENT REGULATIONS
AMENDMENT NO. 2, 2013

TAKE NOTICE that the TOWN OF SUNNYSIDE Development Regulations Amendment No. 2, 2013 as adopted on the 19th day of June, 2013 has been registered by the Minister of Municipal Affairs.

In general terms the purpose of this Development Regulations amendment is to accommodate campground as a discretionary use class in the Town Zone.

The Development Regulations Amendment No. 2, 2013 comes into effect on the day that this notice is published in *The Newfoundland and Labrador Gazette*.

Anyone who wishes to inspect a copy of the Sunnyside Development Regulations Amendment No. 2, 2013 may do

so at the Sunnyside Town Office during normal working hours.

TOWN OF SUNNYSIDE
Philip Smith, Town Clerk-Manager

Oct 4

LANDS ACT

NOTICE OF INTENT

Lands Act, c36, SNL 1991, as amended (the "Act")

Notice is hereby given that NSP MARITIME LINK INCORPORATED, a body corporate duly incorporated under the laws of the Province of Newfoundland and Labrador, intends to apply to the Department of Environment and Conservation, two months from the publication of this Notice, to acquire title, pursuant to Section 7(2)(a) of the said Act, to that piece of Crown land situated at Indian Head within fifteen (15) metres of the waters of St. Georges Bay, in the Electoral District of St. Georges – Stephenville East for the purpose of a Grounding Site.

Beginning at coordinates of North 5372860m and East 388543m and ending at coordinates of North 5373126m and East 388923m; and the land is described as follows:

*Bounded on the West by lands
now or formerly of Elizabeth Ingraham
for a distance of fifteen (15) metres;
Bounded on the North by lands
now or formerly of Elizabeth Ingraham
and by lands now or formerly of Wallace Farnell*

*for a distance of five hundred and fifty nine (559) metres;
Bounded on the East by the shoreline reservation
for a distance of fifteen (15) metres;
Bounded on the South by the waters of St. Georges Bay
for a distance of five hundred and seventy six (576) metres;
and containing an area of approximately
eight thousand five hundred and twelve
(8512) square metres.*

All coordinates are UTM NAD83 CSRS Zone 21 and are approximate.

Any person wishing to object to the application must file the objection, in writing, within one month from the publication of this Notice, with reasons for it, to the Minister of Environment and Conservation, and mail to the nearest Regional Lands Office:

c/o Eastern Regional Lands Office, P.O. Box 8700, Howley Building, Higgins Line, St. John's, NL, A1B 4J6.

c/o Central Regional Lands Office, P.O. Box 2222, Gander, NL, A1V 1L7.

c/o Western Regional Lands Office, P.O. Box 2006, Sir Richard Squires Building, Corner Brook, NL, A2H 6J8.

c/o Labrador Regional Lands Office, P.O. Box 3014, Station "B", Happy Valley-Goose Bay, NL, A0P 1E0.

For further information on the proposed application, please contact: JEFF MYRICK, Senior Communications Advisor, at NSP MARITIME LINK INCORPORATED, Telephone number: 1-855-722-3373.

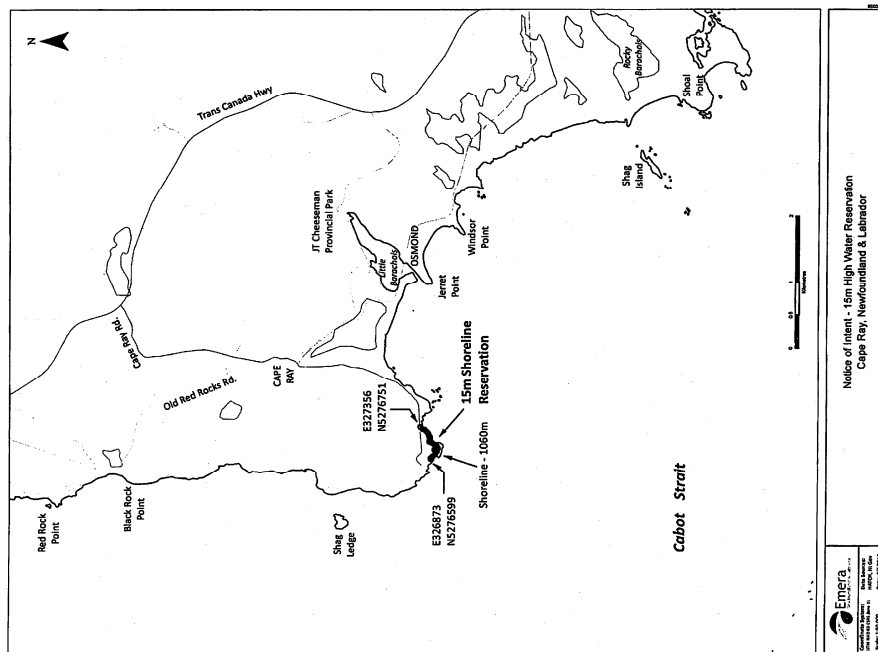

Oct 4

NOTICE OF INTENT
Lands Act, c36, SNL 1991, as amended

NOTICE IS HEREBY given that ROBERT SPENCE PATEY of Port Saunders, NL intends to apply to the Department of Environment and Conservation, two months from the publication of this notice, to acquire title, pursuant to Section 7(2)(e) of the said Act, to that piece of Crown land situated within fifteen (15) metres of the waters of Port Saunders Harbour in the Electoral District of St. Barbe for the purpose of a shed and wharf and being more particularly described as follows:

*Bounded on the North by Residential
for a distance of 20 metres;
Bounded on the East by Industrial Commercial
for a distance of 2 metres;
Bounded on the South by Port Saunders Harbour
for a distance of 0 metres;
Bounded on the West by Industrial Commercial
for a distance of 25 metres;
and containing an area of
approximately 1000 square metres.*

Any person wishing to object to the application must file the objection, in writing, within one month from the publication of this Notice, with reasons for it, to the Minister of Environment and Conservation, and mail to the nearest Regional Lands Office:

c/o Eastern Regional Lands Office, P.O. Box 8700, Howley Building, Higgins Line, St. John's, NL, A1B 4J6.

c/o Central Regional Lands Office, P.O. Box 2222, Gander, NL, A1V 1L7.

c/o Western Regional Lands Office, P.O. Box 2006, Sir Richard Squires Building, Corner Brook, NL, A2H 6J8.

c/o Labrador Regional Lands Office, P.O. Box 3014, Station "B", Happy Valley-Goose Bay, NL, A0P 1E0.

For further information on the proposed application, please contact: JUDY QUINLAN, Town Clerk, Telephone Number: (709) 861-3105.

Oct 4

QUIETING OF TITLES ACT

2013 01G 4050
IN THE SUPREME COURT OF
NEWFOUNDLAND AND LABRADOR
TRIAL DIVISION

NOTICE OF APPLICATION UNDER THE *QUIETING OF TITLES ACT*, RSNL1990, cQ-3, AS AMENDED.

NOTICE IS HEREBY GIVEN to all parties that the estate of ALICE LANNON pursuant to the said Act have applied to the Supreme Court of Newfoundland and Labrador, Trial Division, in the Judicial Centre of St. John's, to have the title to ALL THAT piece or parcel of land situate and being Lot 91-97 Southeast Road, Southeast Placentia, Electoral District of Placentia - St. Mary's, in the Province of

Newfoundland and Labrador, and being more particularly described in the Schedule hereto annexed and marked "A", hereto annexed, of which the said Applicants claim on their own behalf to be the owners, investigated and for a declaration that the said Applicant is the absolute owner thereof, free from those exceptions or qualifications contained in Section 22(1)(c) and (d) of the *Quieting of Titles Act*.

All persons having title adverse to the title claimed by the estate of ALICE LANNON shall file in the Registry of the Supreme Court of Newfoundland and Labrador particulars of such adverse claim and serve the same together with an Affidavit verifying the same on the undersigned solicitors for the Applicants on or before the 18th day of October, 2013, after which date no party having any claim shall be permitted to file the same or to be heard except by special leave of the Court and subject to such conditions as the Court may deem just.

All such adverse claims shall then be investigated in such manner as the said Supreme Court may direct.

DATED at St. John's, in the Province of Newfoundland and Labrador, this 12th day of September, 2013.

STEWART McKELVEY
Solicitors for the Applicants
PER: Stephanie S. Tiller

ADDRESS FOR SERVICE:

Suite 1100, Cabot Place
100 New Gower Street
St. John's, NL A1C 6K3

Tel: (709) 722-4270

Fax: (709) 722-4565

SCHEDULE "A"

Estate of ALICE LANNON
Lot 91-97 Southeast Road, Southeast Placentia

ALL THAT piece or parcel of land situate and being on the northern side of Southeast Road, in the Town of Placentia, in the Provincial Electoral District of Placentia - St. Mary's, in the Province of Newfoundland and Labrador, Canada, abutted and bounded as follows, that is to say:

Beginning at a point, said point being a capped iron bar set in the northeastern corner of the land and having grid coordinates of North 5,231,410.255 metres and East 233,462.896 metres;

THENCE running along land of Francis and Sylvia Barry registered in the Provincial Registry Of Deeds on Roll 434 Frame 313, North seventy six degrees eighteen minutes thirty four seconds West (N76°18'34"W) a distance of sixty decimal nine six one metres (60.961m), to a capped iron bar;

Thence running along land of Clarence Lannon, North seventy six degrees sixteen minutes thirty seconds West (N76°16'30"W) a distance of ninety six decimal zero seven nine metres (96.079m), to a capped iron bar;

THENCE running along a Reservation along the Waters of Southeast Ann, ten (10) metres wide, South thirty five degrees zero nine minutes thirty three seconds West (S35°09'33"W) a distance of thirty seven decimal three two two metres (37.322m), to a capped iron bar;

THENCE running along land of the Town of Placentia, Sewage Treatment Plant, South seventy six degrees thirty one minutes fifty one seconds East (S76°31'51"E) a distance of ninety six decimal seven nine five metres (96.795m), to a found iron bar;

THENCE running along land of NLHC, Survey by WJTS Limited Job No. 208253, South seventy six degrees thirty two minutes fifty two seconds East (S76°32'152"E) a distance of twenty four decimal three nine zero metres (24.390m), to a found iron bar;

THENCE South eighteen degrees seventeen minutes sixteen seconds West (S18°17'16"W). a distance of forty two decimal five seven zero metres (42.570m), to a found capped iron bar;

THENCE running along the northern limit of the aforementioned Southeast Road, twenty (20) metres wide, South seventy six degrees thirteen minutes zero six seconds

East (S76°13'06"E) a distance of fifty four decimal three five seven metres (54.357m), to a capped iron bar;

THENCE running along the western limit of Morrisey's Lane, North twelve degrees thirteen minutes twenty one seconds East (N12°37'21"E) a distance of seventy six decimal seven three three metres (76.733m), more or less, to the point of beginning.

The above described parcel being subject to a Pole Line Easement, five decimal four (5.4) metres wide, running along the eastern boundary and also partially along the southern boundary of the land;

The above described parcel contains an area of zero decimal seven eight six (0.786) hectares, more or less, and being more particularly shown on the drawing annexed hereto.

All bearings are referred to the meridian of fifty three degrees West Longitude of the Modified Three Degree Transverse Mercator Projection for Newfoundland with NAD83, Zone 1 reference datum.

W.J. Thorne Surveys Limited April 17, 2013

NUM	BEARING	DISTANCE
L1	S76°32'52"E	24.390
L2	S76°13'06"E	54.357
L3	N12°37'21"E	76.733

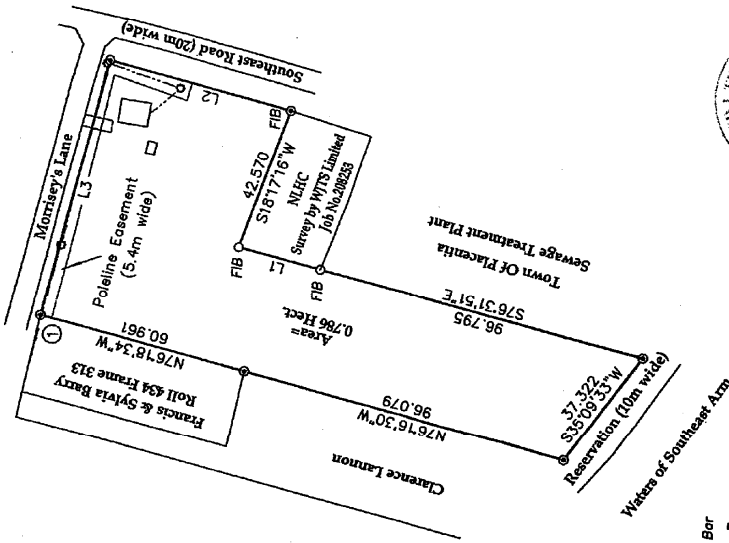

W.J. Thorne Surveys Limited 298 River Road, Blacktown, NL
Plan Of Land Surveyed For Estate of Alice Lannon Lot 91-97, Southeast Road, Southeast Placentia
Scale: 1 : 1250 Survey By : WJ/TM/SG Job No. 213062 Date : April 17, 2013

LEGEND

- FIB Found Iron Bar
- Capped Iron Bar
- Iron Bar
- Power Pole
- Power Line
- x- Fence Line

Linear Measurement Horizontal Ground Distances.

All Boundary Lines Cut or Open.

NAD 83 Reference Datum.

Co-ordinates derived by RTK GPS.

Control Monument 6262363 used in Control Tie.

① N5,231,410.255

E 233,462.896

© W.J. Thorne, Newfoundland Land Surveyor, 2013. Unauthorized use, alteration or reproduction of this Survey Plan is prohibited by law as outlined in the Copyright Act. However, use and reproduction thereof by or on behalf of the person to whom this Survey Plan was prepared is permitted, provided that no alterations whatsoever are made thereto.

CHANGE OF NAME ACT, 2009

Legal name changes processed during the period – August, 2013.

Name Former Surname	Name Former Given Name	Child Surname	Child Given Names	Community
LEMPRIERE	TYLER JOHN CYRIL	GREENE	TYLER JOHN CYRIL	Comer Brook
STAPLETON	CLAIRE MARIE	BROPHY	CLAIRE MARIE	Wabush
NOFTALL	RILEY WILLIAM	MURPHY	RILEY WILLIAM	St. John's
SU	DAN DAN	SULLIVAN	DANI	St. John's
CHAFE	SYLVIA CHRISTINE	DAY	MARY CHRISTINE	St. John's
TUGLAVINA	DANIEL HANK PAULUS	KALLEO	DANIEL HANK PAULUS	Happy Valley-Goose Bay
CAINES	KAITLYN YVETTE	SAUNDERS	KAITLYN YVETTE	Torbay
CAINES	NOAH MICHAEL	SAUNDERS	NOAH MICHAEL	Torbay
BARFITT	DANIEL ARMANDO	VILLAMIL	DANIEL ARMANDO	St. John's
MARSH	SHYBLI JOY	BAKER	SHYBLI JOY	Hillview
WILLIAMS-GRIFFIN	NOLAN ROBERT	GRIFFIN	NOLAN ROBERT	Paradise
ANSTEY	HAYLEY ANGEL BETTY TAMMY	ROBERTS	HAYLEY ANGEL BETTY TAMMY	Springdale
HAYWARD	JACOB PATRICK	SNOW	JACOB PATRICK	Mount Pearl
STAPLETON	SARAH CATHERINE	BROPHY	SARAH CATHERINE	Wabush
ZHAO	MIN	SULLIVAN	EVA	St. John's
MULLALY	LONDON GLEN	DROVER	LONDON GLEN	Bate Verte
MULLALY	DARIAN BRIAN	DROVER	DARIAN BRIAN	Bate Verte
TAPLIN	ISABELLE MAY	HULL	ISABELLE MAY	St. John's
MUSSEAU	DANIEL GEORGE DAVID	DRAKE	DANIEL GEORGE DAVID	Stephenville
CORNWELL	JENNIFER MARIE	EDWARDS	SARAH	St. John's
PENNEL	ANGELA DEANNE	HEADLAND	DEANNE ANGELA	Mount Pearl
PIERCEY	CONSTANCE CHARLENE	CAREN	CONSTANCE CAROLINE ANNE	Placentia
CROFT	HOLLY LYNN	HALLIDAY	HOLLY LYNN	St. John's
LODGE	CHERYL LYNN	EDDY	CHERYL LYNN	Little Caralina
SUTTON	TYLER WILLIAM	LINTHORNE	TYLER WILLIAM	St. John's
BUDGEEL	RODNEY MICHAEL	MANUEL	MICHAEL	St. John's
ELLIOTT	JAYDEN EVELYN NATASHA	ELLIOTT-JOY	JAYDEN EVELYN NATASHA	Catalina
ELLIOTT	PAYTON BRENDA MELVINA	ELLIOTT-JOY	PAYTON BRENDA MELVINA	Catalina
BARNES	SHYANNE LILLIAN PATRICIA	DOMINIX	SHYANNE LILLIAN PATRICIA	Gander
COOK	SARAH ROSE	MERCER	LOGAN SKYLER	St. John's
NICHOLL	DESTINY MELITA LAURA	DAVIS	DESTINY MELITA LAURA	St. John's
PRESTON	ALEX BRADLEY MIGUEL	HUNT	ALEX BRADLEY MIGUEL	Hare Bay
RENDELL	CHARLES WILLIAM	RANDELL	CHARLES WILLIAM	Glovertown South

PIKE	COURTNEY TRUDY VANESSA	DROVER	COURTNEY TRUDY VANESSA	Upper Island Cove
PICKETT	LONDON AMELIA ELLIE	YETMAN	LONDON AMELIA ELLIE	Paradise
SMITH	SARAH ALICE	TOBIN	SARAH ALICE	Carbonear
DINN	NICHOLAS WILLIAM	FLEMING	NICHOLAS WILLIAM	Goulds
DINN	JACOB JOHN	FLEMING	JACOB JOHN	Goulds
DENT	AARON ALLAN	BUSSE	AARON ALLAN	Comer Brook
BROWN	DANIEL CHRISTIAN	BROWNE	DANIEL	Gander
HANN	MONICA ANNIE	CREWS	MONICA ANNIE	Mount Pearl
HANN	MADISON CATHERINE	CREWS	MADISON CATHERINE	Mount Pearl

Dated this 23rd day of September, 2013.

SERVICE NL
 Ken Mullay, Registrar
 Vital Statistics

TRUSTEE ACT

ESTATE NOTICE

IN THE ESTATE of ROBERT LOWELL LEGGE, Late of the Town of Robinsons in the Province of Newfoundland and Labrador, Deceased: August 30, 2013.

All persons claiming to be creditors of or who have any claims or demands upon or affecting the Estate of ROBERT LOWELL LEGGE, late of the Town of Robinsons, in the Province of Newfoundland and Labrador, deceased, are hereby requested to send the particulars of the same in writing, duly attested, to the undersigned Solicitor for the Executor of the Estate on or before the 28th day of October, 2013, after which date the said Executor will proceed to distribute the said Estate having regard only to the claims of which notice shall have been received.

DATED at Stephenville, Newfoundland and Labrador this 23rd day of September, 2013.

ROXANNE PIKE LAW OFFICE
Solicitor for the Executor
PER: Roxanne Pike

ADDRESS FOR SERVICE:
P. O. Box 272
43 Main Street
Stephenville, NL A2N 2Z4

Tel: (709) 643-6436
Fax: (709) 643-9343

Oct 4



THE NEWFOUNDLAND AND LABRADOR GAZETTE

PART II

SUBORDINATE LEGISLATION FILED UNDER THE STATUTES AND SUBORDINATE LEGISLATION ACT

Vol. 88

ST. JOHN'S, FRIDAY, OCTOBER 4, 2013

No. 40

NEWFOUNDLAND AND LABRADOR REGULATION

NLR 112/13



**NEWFOUNDLAND AND LABRADOR
REGULATION 112/13**

Liquor Licensing Regulations (Amendment)
under the
Liquor Control Act
(O.C. 2013-276)

(Filed October 3, 2013)

Under the authority of 61 of the *Liquor Control Act*, the Board of the Newfoundland and Labrador Liquor Corporation makes, with the approval of the Lieutenant-Governor in Council, the following regulations.

Dated at St. John's, October 2, 2013.

Glenn Tobin
Board of Newfoundland
and Labrador Liquor Corporation

Julia Mullaley
Clerk of the Executive Council

REGULATIONS

Analysis

1. S.14.1 Amdt.
Recreational facility licence

CNLR 1162/96
as amended

1. (1) Paragraph 14.1(4)(a) of the *Liquor Licensing Regulations* is repealed and the following substituted:

- (a) at an indoor stadium or indoor arena, spirits and wine only in disposable cups with lids;
- (a.1) at an indoor stadium or indoor arena, beer
 - (i) in disposable cups with lids, or
 - (ii) by the opened can, with the prior written approval of the board;

(2) Subparagraph 14.1(8)(a)(iv) of the regulations is repealed and the following substituted:

- (iv) where the facility is being used as a site for an indoor concert, serve
 - (A) alcoholic beverages in disposable cups with lids only, except as approved under clause B, and
 - (B) beer by the opened can with the prior written approval of the board, and restrict the consumption of that beer to the area commonly known as the concourse area of the facility, or another area which is not a designated seating area in that facility as determined by the board,

(3) Subparagraph 14.1(8)(a)(vi) of the regulations is repealed and the following substituted:

- (vi) serve
 - (A) alcoholic beverages in disposable cups with lids only, except as approved under clause (B), and those cups shall be distinct in appearance from the containers in which non-alcoholic beverages are served, and
 - (B) beer by the opened can, with the prior written approval of the board, and

©Queen's Printer

Index

PART I

Change of Name Act, 2009 – Notice	452
City of St. John’s Act – Notices	447
Lands Act – Notices	449
Mineral Act – Notice	445
Municipalities Act, 1999 – Notice	447
Quieting of Titles Act – Notice	450
Trustee Act – Notice	454
Urban and Rural Planning Act, 2000 – Notices	448

PART II

CONTINUING INDEX OF SUBORDINATE LEGISLATION

Title of Act and Subordinate Legislation made thereunder	CNLR or NL Reg.	Amendment	NL Gazette Date & Page No.
Liquor Control Act			
Liquor Licensing Regulations (Amdt.)	NLR 112/13	Amends CNLR 1162/96 S. 141 Amdt. Extraordinary Gazette October 3, 2013	Oct 4/13 p. 723

45*The Newfoundland and Labrador Gazette* is published from the Office of the Queen's Printer.

Copy for publication must be received by **Friday, 4:30 p.m.**, seven days before publication date to ensure inclusion in next issue.

Advertisements must be submitted in either PDF format or as a MSWord file. When this is not possible, advertisements must be either typewritten or printed legibly, separate from covering letter. Number of insertions required must be stated and the names of all signing officers typewritten or printed.

Copy may be mailed to the address below, faxed to (709) 729-1900 or emailed to queensprinter@gov.nl.ca.

Advertising rates are available upon request. Subscription rate for *The Newfoundland and Labrador Gazette* is \$125.00 for 52 weeks plus applicable tax (\$131.25). Weekly issues of \$3.00 per copy, plus tax payable in advance.

All cheques, money orders, etc., should be made payable to THE NEWFOUNDLAND EXCHEQUER ACCOUNT and all correspondence should be addressed to: Office of the Queen's Printer, P. O. Box 8700, Ground Floor, East Block, Confederation Building, St. John's, NL A1B 4J6. Telephone (709) 729-3649. Fax: (709) 729-1900.

Web Site: <http://www.servicenl.gov.nl.ca/printer/index.html>

**Place your order by contacting:
Office of the Queen's Printer
Confederation Building, East Block
St. John's, NL A1B 4J6
Telephone: (709) 729-3649 Fax: (709) 729-1900
email: queensprinter@gov.nl.ca**

**Government Information Product
Publication Rate Mail**

G.S.T. # R107442683

All requests for Subscription and Legislation MUST be prepaid.