

**NOTES**

A. CONTRACTORS TO VERIFY ALL DIMENSIONS AND LOCATIONS OF ALL DISSEMPLEMENTS AND UNSATISFACTORY CONDITIONS. ALL DISSEMPLEMENTS AND UNSATISFACTORY CONDITIONS TO BE CORRECTED BEFORE PROCEEDING WITH THE WORK.

B. DO NOT SCALE FROM DRAWING.

C. EXISTING MOORE ROAD PROTECTED WATERSHED AREA FOR THE TOWN OF WHITEBOURNE - 5289 H.A.

D. THE PROPOSED WATERSHED BOUNDARY AND DRAINAGE AREA ARE SHOWN FOR INFORMATION ONLY. THE PROPOSED WATERSHED BOUNDARY AND DRAINAGE AREA SHALL BE AS SHOWN ON THE DRAWING.

**REVISIONS**

No.	Description	Date	By
1	ISSUED FOR APPROVALS	11/17/05	MM
2	STREAM RE-ALIGNMENT SHOWN	11/17/05	MM



**NEWLAB ENGINEERING LIMITED**  
 CONSULTING ENGINEERS - PROJECT MANAGERS

100 WATERLOO STREET, 3RD FLOOR  
 ST. JOHN'S, NL A1B 1X6  
 TEL: 709-734-1140 FAX: 709-734-1141  
 E-MAIL: newlab@newlabeng.com

**CONSULTANTS**

100 WATERLOO STREET, 3RD FLOOR  
 ST. JOHN'S, NL A1B 1X6  
 TEL: 709-734-1140 FAX: 709-734-1141  
 E-MAIL: newlab@newlabeng.com

**DATE** 29/08/05  
**SCALE** AS NOTED

**PROJECT** NEWFOUNDLAND HATCHERY DRAINAGE PLAN

**LOCATION, WATERSHED BOUNDARY AND DRAINAGE AREA**

**DRAWING NO.** 2004-53  
**PROJECT NO.** 2004-53

**SCALE** 1:7500

**DATE** 29/08/05

**BY** S. SREELY

**APPROVED BY** [Signature]

**AS NOTED**

**DETAIL NO.**  
 A B C  
 DRAWING TITLE, REQUIRED  
 DATE LISTED

**PROJECT**

**NEWFOUNDLAND HATCHERY DRAINAGE PLAN**

**LOCATION, WATERSHED BOUNDARY AND DRAINAGE AREA**

**DRAWING NO.** 2004-53  
**PROJECT NO.** 2004-53

**SCALE** 1:7500

**DATE** 29/08/05

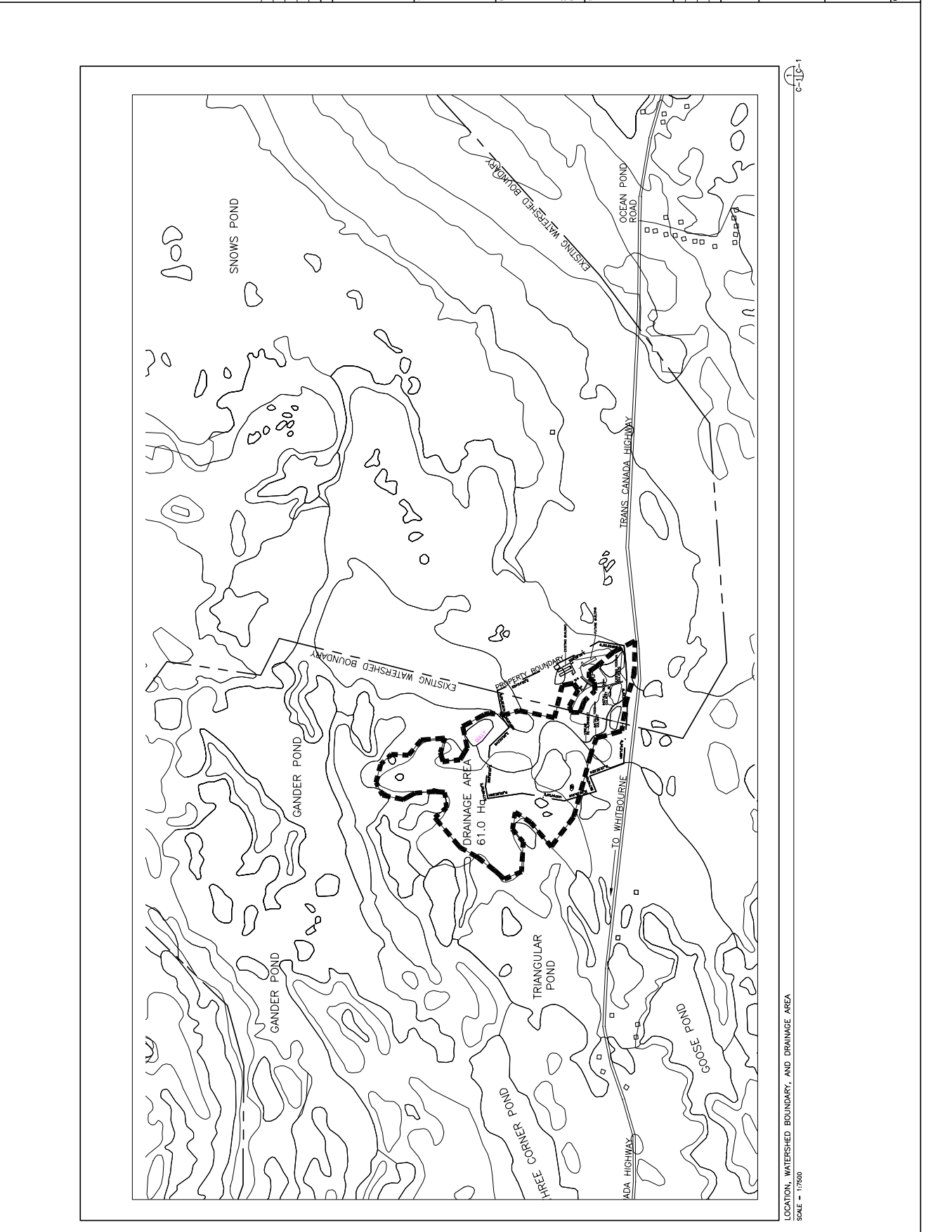

LOCATION, WATERSHED BOUNDARY, AND DRAINAGE AREA  
 SCALE = 1:7500  
 6-11C-1