

Environmental Assessment Registration Form

**Phoca G Company Ltd.
Carbonear, NL**

Fur Tannery

**Prepared for
Dept. of Environment & Conservation**

Date: March 24, 2006

Table of Contents

Name of Undertaking	2
Proponent	3
Name of Corporate Body	3
Address	3
Chief Executive Officer	3
Principal Contact Person for purposes of environmental assessment	3
The Undertaking	4
Nature of the Undertaking	4
Purpose/Rationale/Need for the Undertaking	4
Description of Undertaking.....	5
Geographical Location	5
Physical Features	5
Construction	5
Operation	6
Process	6
Potential Pollutants	7
Waste Treatment	7
Water Supply	9
Approval of Undertaking	10
Funding	11
Appendices	12
Form for Analysis of Waste Water on Tanning Process.....	12

A. Proponent

Name of Corporate Body:

Phoca G Company Ltd.

Address:

Mailing Address: P.O. Box 250
Carbonear, NL
A1Y 1B6

Processing Plant: P.O. Box 250
Carbonear, NL
A1Y 1B6

Chief Executive Officer:

Dean Russell
General Manager
Phoca G Company Ltd.
P.O. Box 250
Carbonear, NL
A1Y 1B6
Telephone: (709) 596-5166
Facsimile: (709) 596-3801

Principal Contact Person for purposes of environmental assessment:

Same as above.

C. The Undertaking

Nature of the Undertaking

The existing Phoca G Company Ltd. seal processing plant at Carbonear, Newfoundland & Labrador will be expanded to enable the tanning of seal pelts. This operation will process seal skins to the dressed (tanned) stage using a high-tech, environmental friendly process.

Purpose/Rationale/Need for the Undertaking

Phoca G Company Ltd. was incorporated in March 2003 under the laws of the Province of Newfoundland & Labrador. The present shareholders of the Company are as follows:

50% NewCo Inc.
50% CanVest Inc.

The principle business activity of the company has been to operate a seal processing facility at Carbonear, Conception Bay, NL.

Phoca G Company Ltd. operated a seal processing operation at Carbonear since 2003. During this time there were no environmental problems and no complaints or mishaps.

Recently, the Government of Newfoundland & Labrador, through then Minister of Fisheries and Aquaculture, The Honorable Gerry Reid, has expressed concerns that the majority of seal pelts landed in the Province are being exported in a raw, unfinished state. Government's aim is to have more seal pelts landed in the Province, further processed to the dressed (tanned) stage.

Phoca G Company Ltd. has had discussions with people in Fisheries and Aquaculture. In these discussions, it was pointed out that Phoca G had been in the process of setting up a fur tannery at their site in Carbonear, Conception Bay. The first official step in this process being the filing of registration with the Government of Newfoundland and Labrador, Department of Environment, Environmental Assessment Division.

D. Description of the Undertaking

Geographical Location:

The site is located on the southeastern side of Carbonear Harbour in Carbonear, Conception Bay, Newfoundland & Labrador, and the boundaries are as follows:

- On the East by a road leading to the processing facility
- On the South by Carbonear Harbour
- On the West by road to processing facility
- On the North by Water Street, Carbonear
- Provincial District: Carbonear/Harbour Grace, MHA – The Hon. George Sweeney
- Federal District: Avalon, MP – Fabian Manning

Physical Features:

The site is approximately 22,812 square feet, and contains two (2) buildings, as follows:

- Processing building for seals
- Storage building

The site also has a tank farm that contains nine (9) metal storage tanks. These tanks are presently utilized for the storage of seal oil. With a storage capacity of 75,000 gallons.

Construction:

Tanning equipment will be installed in the existing production building. It is expected that the construction period for the installation of this equipment will be in the order of two (2) months. It is not expected that there will be any pollutants during the construction period, including airborne emissions, liquid effluents or solid waste materials.

The new equipment that will be installed will consist of two Rizzi shaving machines, one Buffing Machine, two dyeing tanks, one drycleaner, and six de-dusting drums. All of which are shown on attached drawing.

Operation:

Phoca G Company Ltd. expects to phase in the tanning of seal pelts at Carbonear over a period of approximately 1 year. The start-up phase will involve the tanning of approximately 100 seal pelts per day. This number will be steadily increased until approximately 400 seal pelts per day are being tanned.

Process:

The following is a brief description of the process flow:

- Wash, pickle to set white
- Prepare tanning solution in mixer
- Empty drums and mixer and place on pallets
- Press and shave
- Re-tanning and dyeing in drums
- Set out on machine and hang to dry
- Drum in sawdust
- Stretch
- Finish with buffing and stretching

E. Potential Pollutants

The main potential pollutants are generally in liquid form from the tanning operation. However, there is also a quantity of solid waste from the tanning operation as well. This solid waste consists mainly of fat/blubber, hair and flesh from the skins.

It is estimated that each skin put through the tanning process will generate approximately 35 litres of liquid effluent, and 200 grams of solid waste. It is estimated that a yearly volume of 1,400,000 litres of liquid effluent, and 70,484 kgs of solid waste will be generated.

The analysis of the tannery wastewater for the determination of fats, oils, and grease content will be carried out at least twice per month upon start-up or as often as deemed necessary. The liquid effluent will be discharged into the harbour only after it has been treated through a wastewater treatment system. A qualified company will supply this system. The solid waste will be stored in watertight containers and deposited of at a licensed facility.

F. Waste Treatment

According to the *Environmental Control Water and Sewage Regulations* under the *Environment Act* (O.C. 96-254), a person shall not discharge into a body of water, sewage or effluent having a pH value less than 5.5 or greater than 9.0.

A review of the levels of potential pollutants present in the wastewater indicates that their occurrence will be substantially less than the maximum content provided for in Schedule “A” for the aforesaid regulations.

The maximum content of certain constituents permitted in Schedule “A”, for the most part, is measured in milligrams per litre (thousandth of a gram). The measurement of the various constituents contained in the wastewater tested for the most part is measured in micrograms (“μ”), (millionth of a gram).

The following table shows a comparable measurement (gram per litre) of the test results and the maximum levels permitted from Schedule “A”.

Constituents	Milligrams/L Permitted	Micrograms/L (μ l) Test Results	Grams/L Permitted	Grams/L Test Results
Boron	5.00	460.00	0.00500	0.0004600
Cadmium	0.05	5.80	0.00005	0.0000058
Chromium	1.00	24.00	0.00100	0.0000240
Copper	0.30	18.00	0.00030	0.0000180
Iron	10.00	435.00	0.01000	0.0004350
Nickel	0.50	11.00	0.00050	0.0000110
Lead	0.20	12.00	0.00020	0.0000120
Zinc	0.50	193.00	0.00050	0.0001930

The proteolytic active material, which will be used during the pickling and washing of the skins, will be treated with sodium bicarbonate to elevate its pH value to comply with the regulation before it is released.

G. Water Supply

The town of Carbonear is presently providing water to the existing plant. It is expected that this supply will also be available for the tanning process.

As previously noted, the tanning process utilizes approximately 35 litres of water per skin. With production levels to range between 100 and 400 skins per day, the volume of water required will range from a low of 3,500 to a high of 14,000 litres per day.

H. Approval of Undertaking

- The site is within a Municipality, (Town of Carbonear) therefore, a municipal permit will be required.
- The site is not on a protected roadway; therefore a permit will not be required because all the expansion will take place inside the existing building.
- The existing facility is already supplies fresh water from the Carbonear Fresh Water System. We have held preliminary discussions with a representative of the Town and have been advised, verbally, that they do not anticipate any problems in this regard.
- Upon approval of this undertaking our employees will benefit dramatically. Their number of weeks work will increase from 14 weeks at present, up to a minimum of 30 weeks to a maximum of 40 weeks.

I. Funding

The main source of funding will be private capital. Funding will be requested from Human Resources Development Canada to assist in the training of staff. Assistance from the Atlantic Canada Opportunities Agency in the form of a repayable contribution will also be requested. The estimated cost of the project will be approximately \$700,000.00.

Date

Dean Russell, General Manager

J. Appendices

Form for Analysis of Waste Water on Tanning Process:

Monthly report to be submitted not more than 30 days after the end of each month to:

Director
Department of Environment and Labour
Pollution Prevention Division
P.O. Box 8700
St. John's
NL A1B 4J6

Information to be included with report: (See following page)

Waste Water

	Tannery
Date	Quantity Discharged (Litres)

Solid Waste

	Tannery	
Date	Quantity (lbs)	Disposal Method

Shut Downs

Date	Location	Duration	Reason

floor # 1

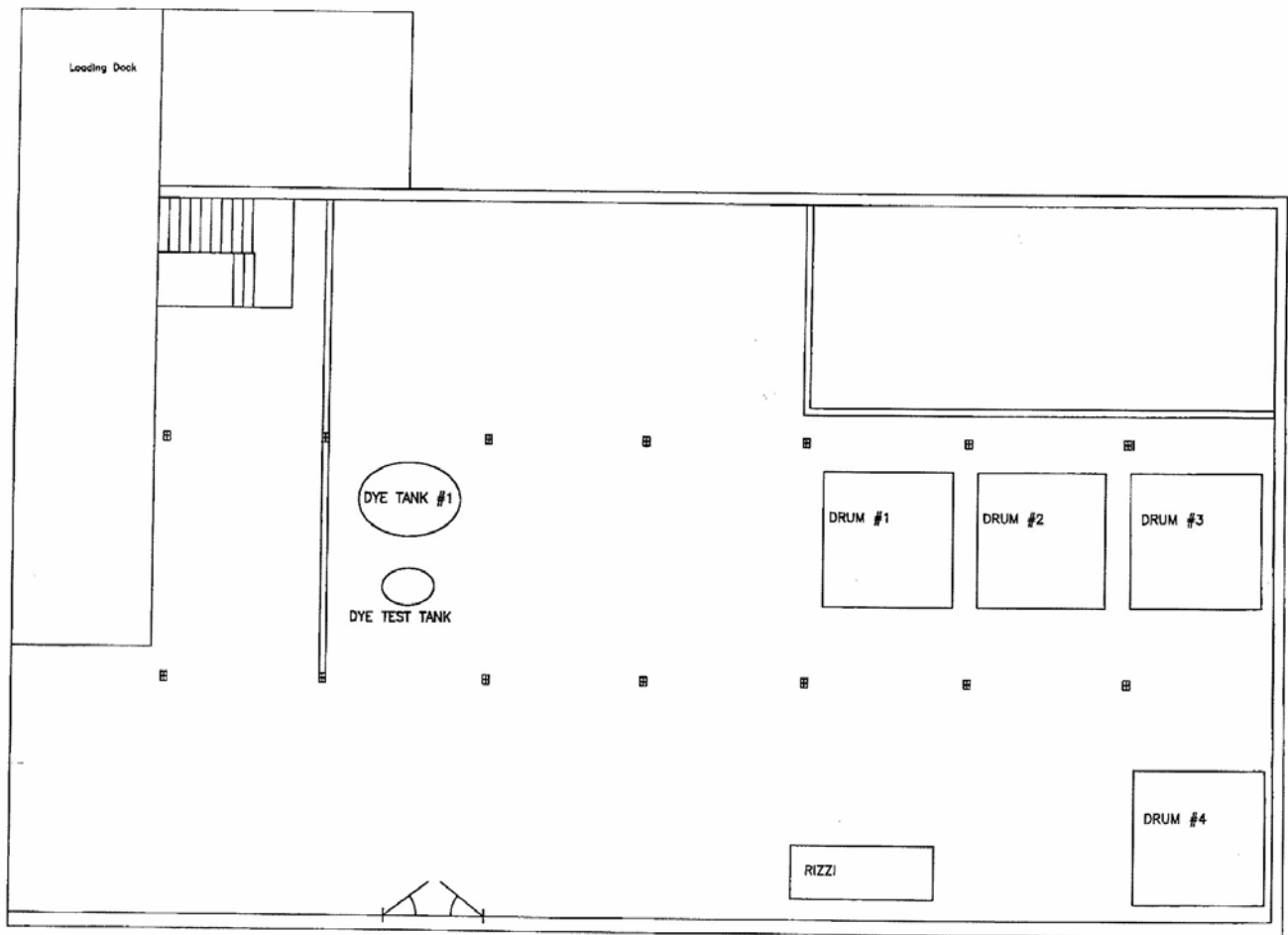

Floor # 2

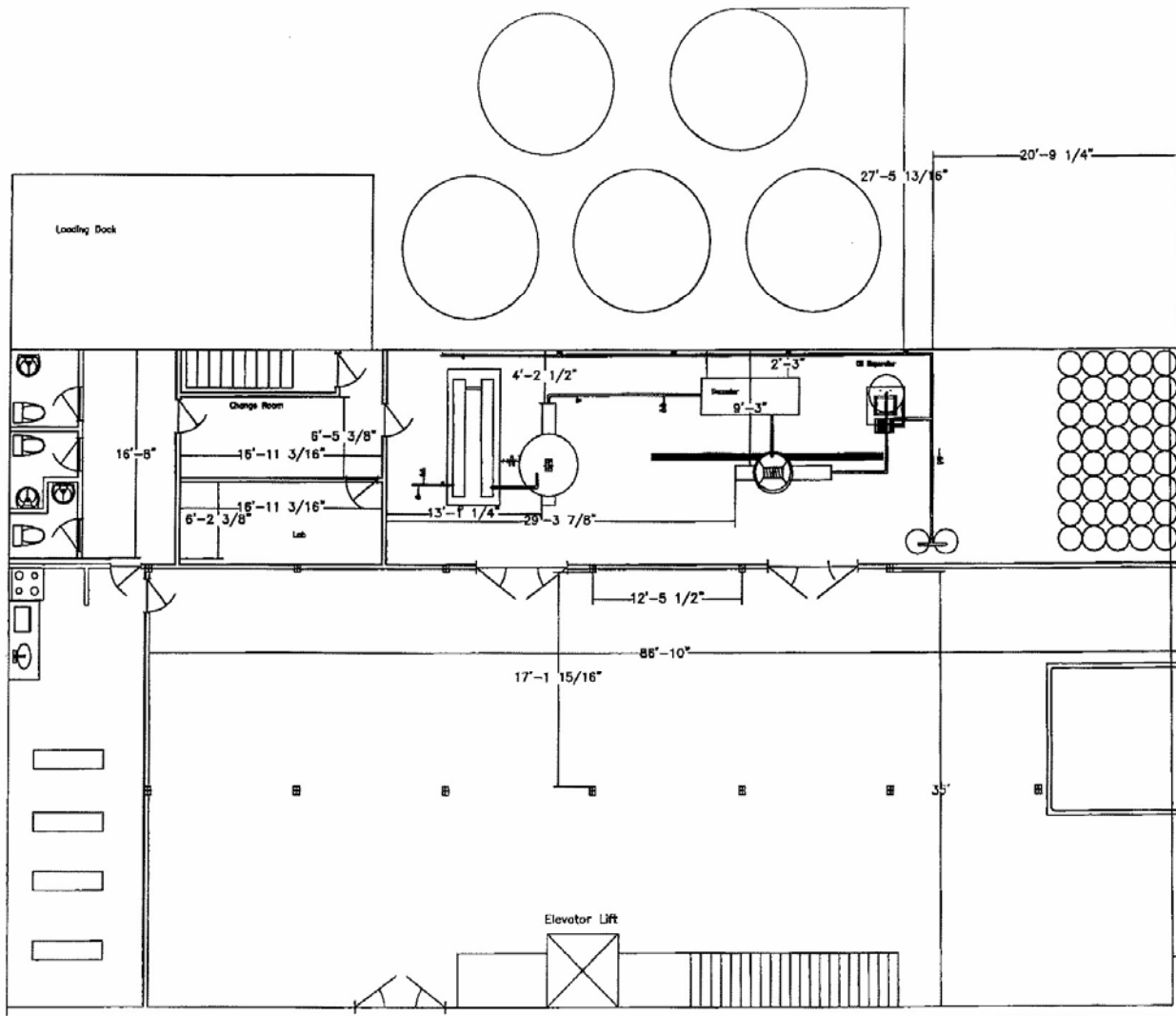

Floor #3

