

*NuMink Inc.*

415 Griffin Drive  
Corner Brook, NL

A2H 3E9

Phone: (709) 785-7387

Fax: (709) 785-5646

Submitted to

**Minister of Environment and Conservation**

P.O. Box 8700

St. John's, NL

A1B 4J6

**Attention: Director of Environment of Assessment**



**Mink Farm in Cox's Cove**  
**Registration Pursuant to Section 49 of**  
**The Environmental Protection Act**

*NuMink Inc.*

415 Griffin Drive  
Corner Brook, NL  
A2H 3E9  
Phone: (709) 785-7387  
Fax: (709) 785-5646

**Chief Executive Officer:**

Bill Barry  
President and CEO of NuMink Inc. & Barry Group of Companies  
Contact Info: Same as Above

**Principal Contact Person for Purposes of Environmental Assessment:**

Catherine Moores  
V.P. Operations  
Contact Info: Same as Above.

**THE UNDERTAKING**

The scope of this report includes proposed construction required for the expansion of a mink farm in Cox's Cove, Newfoundland. The Goal of *NuMink Inc.* is to expand their current herd of 5,000 female breeders, to 10,000 female breeders in the spring of 2007. Required construction to begin in 2006 and end in 2007.

A complete analysis of the fur industry has been conducted and it shows viability for *NuMink Inc.* especially with its parent involvement in the pelagic and seal trade, and recent establishment of a second dressing operation. Farm expansion construction with respect to layout, size, and location are based are in adherence with the "Environmental Farm Practices Guidelines for Livestock Producers in Newfoundland and Labrador" (November 2001). The proposal is designed to grow *NuMink Inc.* to operate competitively in the international fur trade.

## DESCRIPTION OF THE UNDERTAKING

### GEOGRAPHICAL LOCATION:

The proposed site for expansion is located within the municipal boundaries of Cox's Cove, in the Bay of Islands, approximately 3 km along Country Road, away from domestic dwellings and commercial operations. The site location map (Appendix A), shows the site location with respect to the municipality and surrounding area. The size of the site including all five parcels is approximately 116 acres with a total cleared area of 55 acres.

Table 1. All Land Acquired, Associated Uses and Size

LAND PARCEL / MAP I.D.	STATUS	SIZE ACRES	ACTION
Melvin Payne (NuMink Inc.)	Grant	26.74	Purchase
Melvin Payne (Lot 1)	Agricultural Lease	13.5	Transfer Lease
Melvin Payne (Lot 2)	Agricultural Lease	24.9	Transfer Lease
Town of Cox's Cove (Old Dump)	Grant	4	Purchase
Crown Lands (Lot 3)	Agricultural Lease	26.19	Transfer Lease
Crown Lands (CB Pulp & Paper)	Agricultural Lease	20.36	Transfer Lease
<b>Total Area</b>		<b>115.69 Acres</b>	

Melvin Payne is the only resident living in close proximity of the *NuMink Inc.* Mr. Payne has stated his support of the expansion of the current operation.

### PHYSICAL FEATURES:

A number of physical structures will be required for the complete development of the farm. Expansion will begin in 2006 and will commence in 2007.

#### **1. Mink Sheds**

In order for *NuMink Inc.* to expand to 10 000 female breeders as planned, it will have to double its current housing capacity. This means, the construction of an additional four peltier sheds (32' X 450'), and an additional two breeder sheds (37' X 450'). These facilities will be built by Tech Construction (Appendix B).

These buildings will be constructed similar to the first six. The outside shell will be constructed using metal sheeting and polycarbonate panels. Polycarbonate panels will be inserted into the roof and walls to allow additional light access. Such light is required for the mink to progress through critical hormonal changes. Artificial lighting within the shed will also be required.

The shed will be designed to vent above and below the walls during the warmer months. Mink are extremely susceptible to intense heat.

During the colder winter months, the building will be tightly secured. It is important that the animals are kept in a dry, draft-free environment. Thus, snow and wind must be kept out.

The floor of this facility will consist of crushed stone, which will allow for excellent drainage of water and urine. In addition to this, the floors will be graded, higher in the center aisles than beneath the pens, to direct the drainage. Wood shavings will be spread beneath the pens which will aid in the absorption of the urine, and in feces collection.

This building will also be equipped with power outlets, lights, functioning smoke detectors and fire extinguishers.

## **2. Shavings Storage Facility**

A small storage facility and staff room was constructed on site in the fall of 2004. Although this facility is adequate as a staff room and temporary pelting facility, it does not have the capacity to hold our current bedding requirements. Thus, prior to the winter of 2007, we must construct a facility capable of holding multiple loads of bedding, as material is less readily available during the winter months, so we must have the ability to collect material when it is available.

### **CONSTRUCTION:**

Construction is expected to be completed by the Fall of 2007. Pollutants will not be an issue during any construction phase. All are simple structures built with low environmental impact. Any and all solid waste materials will be removed from the site by the contractor and disposed of in the most environmentally friendly fashion, recycling when possible.

It is not foreseen that construction of any of these structures will negatively impact on flora or fauna, or drainage in the area. The land on which construction is scheduled has been cleared agricultural land (hay and pasture), since the early 1970's.

Cox's Brook runs along the down slope edge of the property. It is not a scheduled salmon river and is protected by a heavily vegetated, mostly birch and fir, buffer zone of approximately 25m depth. No construction of any kind will occur within this buffer zone.

Table 2. Proposed Structure Development by Stage, Purpose, Site of Construction, and Expected Completion Date

<b>Structure</b>	<b>Purpose</b>	<b>Area</b>	<b>Completion Date</b>
<b>PHASE 1:</b>			
2 Breeder Sheds (450' X 37')	Mink Housing	Lot 2	Fall 2006
2 Pelter Sheds (450' X 32')	Mink Housing	Lot 2	
Manure Platform	Holding Manure for Spreading	Old Dumpsite	Fall 2006 - Completed
<b>PHASE 2:</b>			
2 Pelter Sheds (450' X 32')	Mink Housing	Lot 1	Spring 2007
<b>PHASE 3:</b>			
Shavings Storage Facility	Storage of Bedding	Lot 1 or 2	Summer/Fall 2007
Guard Fence	Protection & Biosecurity	Lots 1 & 2	Summer 2007 (July 15)

**OPERATION:**

The operation will continue to consist of raising animals from birth to maturity and harvesting their pelts that same year. Next spring we hope to breed 10,000 female mink. On average, mink produce 4-4.5 offspring per female annually. Thus, we intend on producing 40,000 - 45,000 pelts annually.

**1. Manure Management**

**Winter/Spring Management Plan:**

<p><b>Volume Produced</b></p> <p>9.6 cu ft / 1500 mink / day @ 36% Dry Matter</p> <p>This includes bedding and other waste materials</p> <p><b>NOTE:</b> Above information was developed by Canadian Service Plan, an organization of Canadian Agricultural Engineers</p> <p>12,000 mink / 1500 mink = 8</p> <p>8 X 9.6 cu ft X 180 days = 13,824 cu ft</p> <p><b>Total Storage Requirements = 13,824 cu ft</b></p>
---

## Manure Storage Requirements

A facility was designed and constructed to hold 6 months of manure (November through April). During this period we will be housing mainly our breeder herd, consisting of 12,000 animals.

The facility constructed has the ability to store the above calculated volume of material. Under the circumstances that additional capacity is required, it will be added.

## Manure Holding Facility

This facility consists of a manure platform that is 48' wide X 32' deep. It was constructed with 5" thick reinforced concrete, and is positioned with a 1% grade, sloping towards a 2' knee wall in the back. This will prevent run-off.

This facility is constructed with a roof and three walls to keep rain water off of the manure.

Actual Capacity = 15,360 cubic feet

## Location

This facility is situated on a package of land adjacent to our farm. This is a retired dumpsite which has been land filled. This land was purchased by *NuMink Inc.* from the Town Council for this purpose. It consists of a cleared area, surrounded by a forested buffer. It is not visible from the public road.

## Summer/Fall Management Plan:

### Volume Produced

9.6 cu ft / 1500 mink / day @ 36% Dry Matter

This includes bedding and other waste materials

**NOTE:** Above information was developed by Canadian Service Plan, an organization of Canadian Agricultural Engineers

50,000 mink / 1500 mink = 33

33 X 9.6 cu ft X 180 days = 57,024 cu ft

**Total Summer/Fall Waste Production = 57,024 cu ft of waste produced**

## **Waste Disposal**

Manure will be spread on a continual basis throughout the growing season (until the ground freezes). *NuMink Inc.* has access to 65 - 70 acres of land suitable for spreading. *NuMink Inc.* has secured additional land which can be cleared if extra land base is required for spreading (Appendix C).

Melvin Payne has signed an agreement to spread manure for *NuMink Inc.* as long as he is able. In addition to this, *NuMink Inc.* recently invested in a large manure spreader which will allow manure to be spread as soon as it is removed from the barns.

In addition to this, *Hammond Farm Inc.* has agreed to accept any manure which cannot be spread on the above discussed land.

Throughout the winter months manure will be stored in the holding facility until the climate is suitable for spreading.

## **Land Requirements**

According to Appendix D “Recommended Minimum Land Area for Livestock Manure Utilization” of the *Environmental Farm Practices Guidelines for Livestock Producers in Newfoundland and Labrador* the land base required for 10,000 breeders is 66 acres.

Total land owned by *NuMink Inc.* = 116 acres

Total land owned by *NuMink Inc.* currently available for spreading = 41 acres

Additional land owned by Melvin Payne available for spreading = ~25 acres

Additional land owned by Hammond Farm available for spreading = 440 acres

Thus, we should have ample cleared land to handle the estimated volume of manure between ourselves, Mr. Payne and *Hammond Farm Inc.*

## **2. Composting of Mink Carcasses**

Last spring *NuMink* and *Viking Fur Inc.* worked closely with the *Department of Natural Resources and Environment* on developing a method of carcass disposal for the industry that would be feasible and practical for farmers, and would be environmentally sound (as on-site burial is no longer permitted). A composting pilot project was designed and was funded by the *Advancing Canadian Agriculture and Agrifood (ACAAF) Program* and implemented by *NuMink Inc.* and *Viking Fur*

*Inc.* (partnered by the Livestock Council) on behalf of industry. The long-term goal was to encourage the composting of carcasses (of all types) as opposed to burial. The project was monitored closely by government over a period of several months.

The procedure consisted of layering thin layers of carcasses between thick layers of wood chafe and turning periodically. The pile was monitored daily for temperature, moisture content, disturbances, etc.

*NuMink* had great success with this process. The carcasses decomposed very quickly, leaving a solid condensed material with very little scent. Soil samples and material samples were taken and sent away for analysis. Results to date seem positive, indicating a positive breakdown of the material as well as no contamination to surrounding land. In addition to this, there appeared to be no significant odor, or fly or animal attraction associated with the pile.

Moving forward, *NuMink Inc.* would like use this method of disposal for all carcasses. Assuming that permission to do so is granted, carcass composting will be conducted in compliance with guidelines provided by the Department of Environment.

This pilot project took place on the dumpsite, adjacent to the manure storage. In future, *NuMink Inc.* would like to avail of this location for carcass composting again.

An alternative to mink composting would be disposal of carcasses via burial in an Approved Waste Disposal Site in accordance with the *Environmental Farm Practices Guidelines for Livestock Producers in Newfoundland and Labrador*.

### **3. Protection of Water Quality**

Prior to the development of the mink farm in Cox's Cove, *NuMink Inc.* participated in the environmental assessment process. The application was reviewed by the *Department of Government Services & Lands, Department of Tourism, Culture & Recreation, Department of Environment, Department of Labour, Department of Human Resources and Employment, Department of Mines & Energy, Department of Health & Community Services, and Environment Canada*. On December 12, 2003, the proposal was released from environmental assessment. At that time there were no known concerns regarding the impact on water quality.

In addition to this *NuMink Inc.* management recently trekked over the farm with a *Natural Resources Land Management Specialist* and studied drainage routes associated with all aspects of the operation. Resultant water contamination appears to be unlikely.

It should be noted that there are no downstream users.



It is, however, a local swimming hole, thus, as a precaution, the Department of Environment and Conservation will be adding Cox's Brook to the list of Recreational Bacteriological Monitoring Sites for long-term monitoring.

*NuMink Inc.* is serviced by the community water supply and at the request of Council, is in the process of installing a "double backflow preventor" to prevent back-flow under in the circumstance that there is a break in the line.

#### **4. Fly Mitigation**

There is a brief period of time during the warmer months when the fly population increases. During this period *NuMink Inc.* will take extra efforts to mitigate the problem.

##### **Manure Removal**

*NuMink Inc.* will ensure that manure is removed from all sheds biweekly (or more frequently if required) during the growing season, which includes the warmer times of the year. This will limit the nesting environment for flies.

##### **Manure Storage**

Storage of manure throughout the growing season will be limited, as it will be spread regularly by Melvin Payne and *NuMink Inc.* Any necessary manure storage will take place on the concrete platform and will be tarped in the warmer months to kill the fly larvae.

##### **Manure Composting**

The practice of manure composting is being investigated and discussed with the Departments of Natural Resources and Environment and Conservation as a possible method of fly reduction.

##### **Lime**

In addition to this, hydrated lime will be spread beneath the pens regularly and on top of stored manure. This will make the environment inhospitable for flies.

##### **Fish Tubs**

All fish tubs holding waste materials will be kept covered between uses. This will reduce access to fly feeding/breeding grounds.

## **Drainage**

Still water creates breeding grounds for flies, thus *NuMink Inc.* will maintain any ditching required to keep the farm well drained.

The floor of Barn #2 has been a problem area on the farm. The material does not drain properly, resulting in excess water accumulation. This fall *NuMink Inc.* has arranged to have the existing floor removed and replaced with material that will drain properly.

## **Insecticides/Fly Bait**

*NuMink Inc.* has a Pesticide's Applicators License and will continue to use industry accepted insecticides as a method of fly control. *NuMink Inc.* has been in discussions with the Pest Management Specialist on the use of more effective pesticides this upcoming season.

## **Fly Monitoring Program**

Please see the attached Fly Monitoring Program prepared by the Pest Management Specialist of the Department of Natural Resources (Appendix D). This program has been designed to:

- Notify of an increase in fly activity on the farm
- Notify of an increase in fly activity in Town
- Determine which factors (manure removal, liming, pesticide spraying, etc., and weather) influence fly activity on farm and off farm
- Determine if fly species in both locations are similar
- Provide warning of potential fly increase in early stages so additional mitigation measures can be taken.

## **5. Protection Against Disease**

*NuMink Inc.* has been taking measures to ensure that its ranch remain free of Aleutian Disease. *NuMink Inc.* has been requiring that all breeding stock introduced to its ranch come from AD-Free operations, and that the actual mink purchased have been blood tested prior to and upon importation.

In addition to this, *NuMink Inc.* has been conducting regular AD blood testing on its herd. This has consisted of its entire breeder herd in January, prior to breeding season, and all baron females after whelping season. Although, to date, we have not had any positive AD results, we will continue to test regularly to ensure that if a problem does arise, we can deal with it promptly and prevent it from spreading.

All mink are vaccinated annually against Distemper, Pseudomonis, Virus Enteritis and Botulism.

## **6. Biosecurity**

This is an area that *NuMink Inc.* will improve on in the very near future. The plan is to construct a parking area off-site which all staff (and government representatives, etc.) will use. This will be separated from the farm with a guard fence. A small building will be constructed just inside of this gate, where workers can change into their work clothes, and store their outside clothes. This area will be equipped with hand disinfectants, foot-dips, plastic boots, etc. All government employees, sales people, etc., will have to use this facility prior to entering the farm.

In the summer of 2007 a perimeter guard fence will be installed to keep wildlife and intruders off of the farm and prevent mink from escaping. A commitment has been made to the Department of Natural Resources by *NuMink Inc.* to have this in place by July 15<sup>th</sup> (Appendix E).

In addition to this, all sheds have been constructed in such a manner as to limit animal movement. All openings are lined with a wire mesh to prevent mink from escaping and birds and other animals from entering. The doors had been a possible escape way for mink previously, however, *NuMink Inc.* is currently enforcing the closure of doorways at all times until the guard fence is in place.

Live traps have been set around the sheds to catch any mink that have escaped – however, with the above detail, the number of escapees should be limited.

## **7. Health & Safety**

Three employees have participated in proper *Occupational Health and Safety* training seminars. *NuMink Inc.* has a committee in place, and has compiled a manual. Two employees are trained in St. John's Ambulance First Aid training. In addition to this, one employee has obtained a Pesticides Applicators License.

*NuMink Inc.* recommends that all employees obtain a Tetanus shot to protect against infection caused by cuts, etc., obtained on the job.

All barns are designed for maximum ventilation during the warmer months to improve air quality and working conditions for staff members (as well as living conditions for mink).

## **8. Management Team**

*NuMink Inc.* management team consists of Catherine Moores, Lee Churchill, Daphne Boudreau and Melvin Payne. Catherine Moores has been an employee of *Barry Group Inc.* for almost 5 years. She is a graduate of the *Nova Scotia Agricultural College*, with an honors degree in Agriculture, majoring in Animal Science, and minoring in Business. Catherine over-sees all aspects of the *NuMink*

*Inc.* operation. Lee Churchill was recently hired as her assistant. His background is in business and the fishery. He is learning all aspects of the mink and feed business. He is assisting in day to day activities and future planning. Daphne Boudreau is the on-site manager of the mink operation. She graduated from the *Nova Scotia Agricultural College* with an honors degree in Agriculture, majoring in Animal Science, and has completed her master's degree in Mink Nutrition. Daphne conducted six years of fur research under one of the top fur researchers in the world – Dr. Kirsti Rouvinen-Watt. Melvin Payne is Daphne's counterpart, and helps her with the day-to-day management of the operation. Melvin has a combination of agricultural and carpentry experience.

In addition to this, *NuMink* continues to work closely with Dean Armstrong of the *Heger Company*, who is the most recognized and highly respected mink nutritionist in North America. Furthermore, *NuMink* continues to work closely with one of Nova Scotia's top mink ranchers, Ronnie Crowell of *Elite Farms Ltd.*

### **APPROVAL OF THE UNDERTAKING**

Approvals required for such expansion includes:

<b>Approval</b>	<b>Issuing Agency</b>	<b>Status</b>
<b>Certificate of Approval</b>	Dept. of Environment	Pending
<b>PHASE 1:</b>		
2 Breeder Sheds (450' X 37')	Building Permit – Town Council	Obtained
2 Pelter Sheds (450' X 32')	Building Permit – Town Council	Obtained
Manure Platform (48' X 32')	Building Permit – Town Council	Obtained
<b>PHASE 2:</b>		
2 Pelter Sheds (450' X32')	Building Permit – Town Council	Obtained
<b>PHASE 3:</b>		
Storage Facility	Building Permit – Town Council	Pending
Guard Fence	Building Permit – Town Council	Pending

(Appendix F & G)

### **SCHEDULE**

Due to unforeseen delays incurred over the past 6 months, it is very important that there are no further delays, as we must proceed with required construction and financing, which are necessary for our successful growth.

## FUNDING

Funding for this expansion will consist mainly of private investment. *NuMink Inc.* has applied for assistance through *Atlantic Canada's Opportunities Agency* (No-Interest Loan). Approval has not yet been granted.

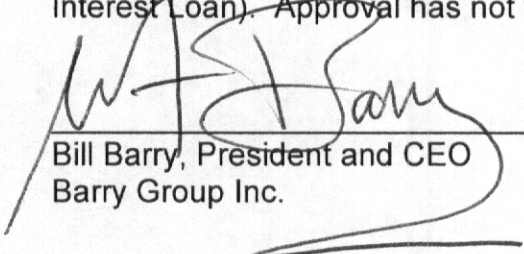

---

Bill Barry, President and CEO  
Barry Group Inc.

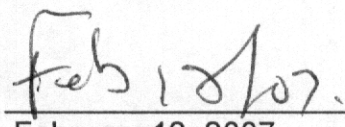

---

February 12, 2007

## **Appendix A**

Site Location/Drainage Map  
1: 2,500 Scale Map



## **Appendix B**

### Engineering Diagrams Of Mink Sheds



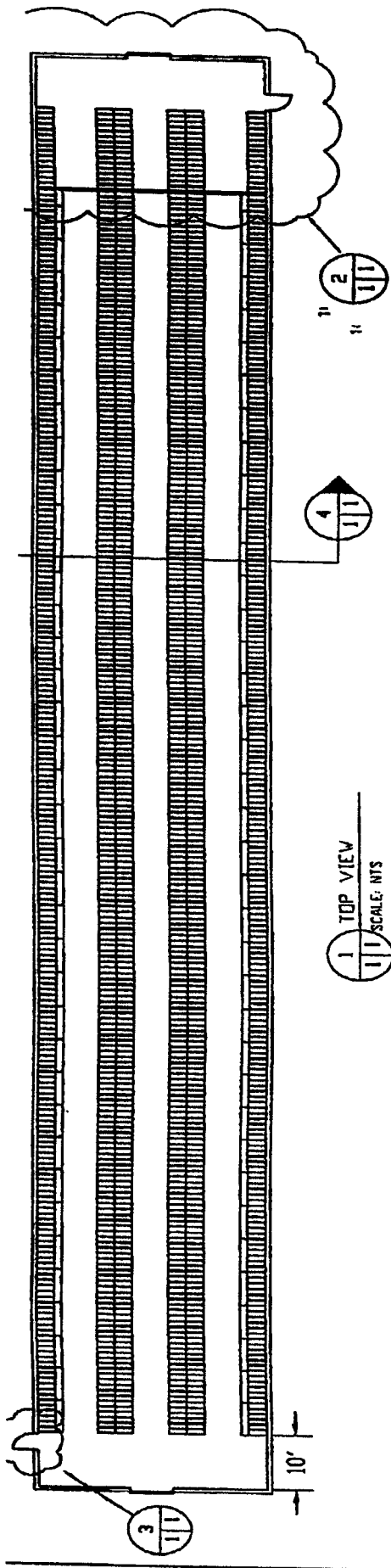

1 TOP VIEW  
1/1 SCALE: NTS

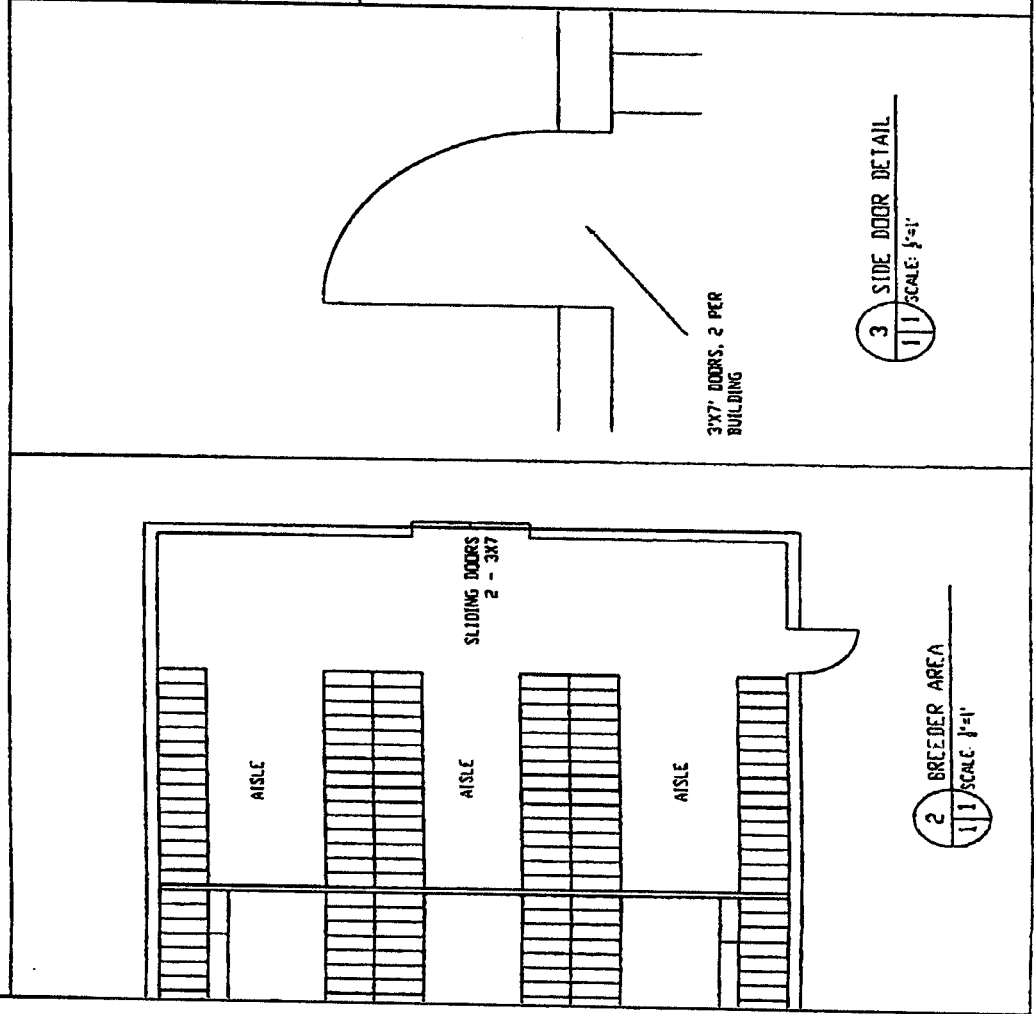

2 BREEDER AREA  
1/1 SCALE: 1/4" = 1'

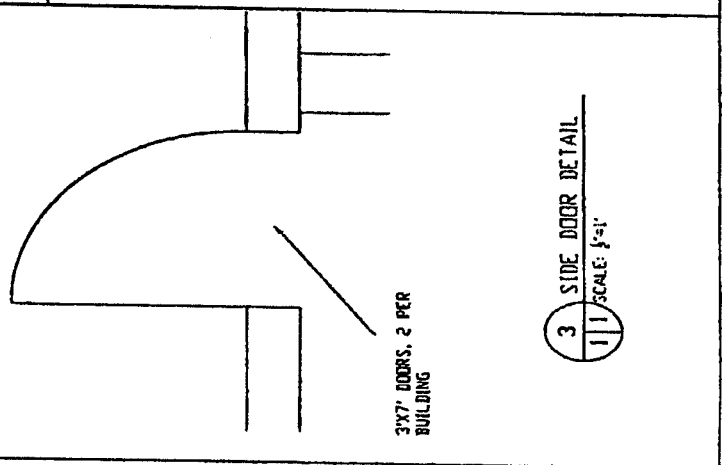

4

2

3

4

PROJ NAME	HINK FARM CONSTRUCTION		
PROJ NO.	MF0301		
DWG TITLE	CAGE LAYOUT		
BY	KC	DATE	OCT 2, 03
DWG NO.	MF0303	REV	00
SCALE	A/S	SHEET	1 OF 1

4 SECTION/SIDE VIEW  
1/1 SCALE: 1/4" = 1'



## **Appendix C**

### Landbase Agreements for Spreading Manure

Cox's Cove, NL  
A0L 1C0  
(709) 688-2291

October 3, 2006

I, Melvin Payne, will spread NuMink Inc. manure, which will be stored on their concrete platform, as long as I am able.

I have 20 – 30 acres of land on which this manure can be spread (in addition to that owned by NuMink Inc.).

Yours truly,

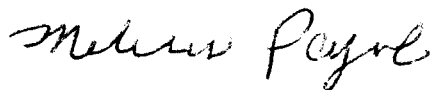
A handwritten signature in cursive script that reads "Melvin Payne". The signature is written in black ink and is positioned above the printed name.

Melvin Payne

---

**Hammond Farm Limited**

---

Box 2155, RR 1  
Corner Brook, Nfld. A2H 2N2  
Phone 709-634-6648 Fax 709-634-0046  
hameggs@nf.aibn.com

---

January 15, 2007

To whom it may concern:

Please let this letter serve as official notification that Hammond Farm Limited is prepared to accept manure from NuMink Inc. of Griffin Drive Corner Brook. This byproduct of the Cox's Cove mink operation can and will be utilized by Hammond Farm for fertilization of forage production fields. It is understood that from time to time, NuMink Inc. may exceed their capacity to spread this manure on their land-base therefore Hammond is agreeable to spreading this access product.

Hammond has adequate land capacity for this purpose in that the current dairy and egg production operations at Hammond Farm cannot fulfill the nutrient requirements desirable for the forage production operation. Hammond Farm Limited has access to 300 acres of forage production in Little Rapids as well as an additional 140 acres in the Pasadena area.

If there are any further questions, please do not hesitate to contact the undersigned at your convenience.

Regards,

---

Bruce Simmons  
President, Hammond Farm Limited

cc. Ms. Catherine Moores

## **Appendix D**

### Fly Monitoring Program

January 26, 2007

Nu Mink Inc.  
415 Griffin Drive  
Corner Brook, NL  
A2H 3E9

Dear Ms. Moores:

In response to your request January 8, 2007 for information on establishing an investigation into the nuisance fly complaints associated with the mink ranch Nu Mink Inc. The following is a proposed procedure for the investigation into the fly population seasonality and fly species present around your mink ranch and the Country Road area of Cox's Cove Newfoundland. It will determine the fly species that are present on the farm and in the area and determine the time of year that the populations spike as well as to establish complaint thresholds that reflect complaint response.

Past research for fly species associated with animal facilities, such as poultry, has proven that several sampling techniques can be used in monitoring populations of flies. Such sampling techniques are sticky tapes and spot cards.

Sticky tapes are ribbons that hang throughout the facility or around structures. They are collected and counted weekly. They monitor species present and the abundance of a population.

The fly spot card method is based on index cards placed inside livestock facilities and around structures, where flies are known to congregate. Every time a fly lands, they leave behind spots that are excreta and vomit. The spots are counted on a weekly basis and can be used as an index of fly abundance and activity. The comparison of spot card indexes and nuisance complaint times can establish the threshold that then can be used to determine timing and selection of pest management techniques.

There will be two monitoring areas:

1. On-Farm:

Five (5) sampling sites per aisle consisting of a sticky tape and spot card will be established in all sheds, for a total of 150 collection sites. The cards and tapes will be counted on weekly bases. If dust proves to be a problem then tapes may have to be collected twice a week.

Visual inspections of manure under the cages at three (3) sites in all sheds for maggots of all species, including beneficial species, will be conducted weekly. Manure removal and timing of lime and shaving applications will be recorded weekly.

The location known as the old dump will have two (2) sampling sites established to be collected and counted weekly.

2. Off-Farm:

The Country Road area will have three (3) sampling sites at the beginning (Barry Gillingham's), at the middle (Lem Payne's) and at the end (Shelly Payne's). Each site will consist of two stations (a paired tape and card)

There are other locations located further back from the farm such as the Wells and Park store and the fish plant. Again two (2) collection sites per location to be established.

Nuisance complaints will be noted (dated and timed) and recorded throughout the season (May – October) from the Cox's Cove area. These complaint times will then be compared to the spot card numbers from the ranch to determine if there is any correlation to each other.

Data sheets for on-farm and off-farm are attached. GPS mapping and digital pictures will also be used as record keeping tools. Data will be collected by a government technician.

The mathematical modeling and data analysis required of the monitoring program to establish thresholds will be established and reviewed by Tim Lysyk, a Research Scientist, Livestock Insect Population Ecology, with Agriculture and Agri-food Canada.

If you have any questions or concerns do not hesitate to contact me.

Sincerely,

Jane White  
Pest Management Specialist

GENERAL WEATHER

GENERAL CONDITIONS

SPOT CARDS	CARD #	COUNT																		
	1																			
	2																			
	3																			
	4																			
	5																			
	6																			
	7																			
	8																			
	9																			
	10																			
	11																			
	12																			
	13																			
	14																			
	15																			
MAGGOTS PRESENT	SITE 1	SITE 2	SITE 3																	
visual rating low/moderate/high																				
Species of fly: House fly																				
Blow fly																				
Green Bottle fly																				
Lesser house fly																				
Other																				
Beneficial																				
STICKY TRAP #	1	2	3	4	5	6	7	8	9	10	11	12	13	14	15					
Species of fly: House fly																				
Blow fly																				
Green Bottle fly																				
Lesser house fly																				
Other																				
Beneficial																				

COMMENTS:

Blank lines for handwritten notes and comments.



## **Appendix E**

### Commitment to Construct Guard Fence

# NuMink Inc.

---

415 Griffin Drive Corner Brook Newfoundland A2H 3E9  
Tel: (709) 785-7387 Fax: (709) 785-5646 cmoores@NuMink.ca

December 7, 2006

Attn: Mr. Hazen Scarth - Department of Natural Resources

C.C.: Mr. Michael Cahill – Department of Environment and Conservation

Re: Deviation from 2003 Environmental Assessment Commitment – Perimeter Guard Fence

Dear Mr. Scarth,

This is in reference to the issue surrounding a commitment made by *NuMink Inc.* in its 2003 application for Environmental Assessment to establish a perimeter guard fence around its farm in Cox's Cove.

This commitment has not yet been met.

*NuMink Inc.* is still in the construction phase, and there remains some degree of uncertainty as to where its final buildings will be situated. This fall we were faced with having to relocate two buildings 300' from the intended building sites due to the unforeseen presence of vertical shale. If the guard fence had already been erected, significant additional expense would have been endured to have it moved.

As stated in the 2003 application for Environmental Assessment, a guard fence is a priority for *NuMink Inc.* for multiple reasons, including preventing the escapement of our own mink and the entrance of other animals, as well as protection from intruders. The delay has simply been an issue of timing.

*NuMink Inc.* will have all phases of construction completed by early July of 2007. Thus, we commit to having a suitable guard fence in place by July 15, 2007.

I hope that this solemn commitment can give you the assurance that you require.

Yours truly,

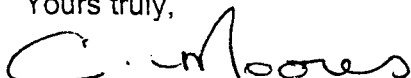

Catherine Moores  
V.P. Operations  
*NuMink Inc.*

## **Appendix F**

### Building Permits Obtained



# The Town of Cox's Cove

P.O. BOX 100, COX'S COVE  
BAY OF ISLANDS, NEWFOUNDLAND A0L 1C0  
PHONE/FAX: (709) 888-2900

## Building Permit Application

Fee:	Shed -----	
	Slipway -----	\$10.00
	Extension To Building -----	\$10.00
	House -----	\$10.00
	Church/Charity -----	\$20.00
	Business Buildings: -----	\$30.00
	Est. Cost up to \$50,000 -----	\$30.00
	Est. Cost more than \$50,000 -----	\$100.00

This application must be completed by any person proposing to construct a building, extend on an existing building etc. In The Municipality of Cox's Cove.

1. Application Date: June 13, 2006
2. Applicant's Name: MUMINK INC, 415 Griffith Dr, Corner Brook, NL AZH 3E9
3. Size of Building: 5 @ 33' x 448' 2 @ 37' x 448'
4. Location of Building: 69 Country Road, COX'S COVE
5. Intended use of Building: Housing of mink
6. Construction Material: Metal sheeting
7. Approximate Cost: \$160,000<sup>00</sup> Each
8. Please try to sketch the location of the building and it's closeness to the next building, on the back of this application.

This application will be processed subject to the approval of the Community Council of Cox's Cove and subject to any other government departments and will remain valid for a period of one (1) year from the date of Issue.

**FEE MUST BE ENCLOSED WITH THE APPLICATION**

THE COMMUNITY OF COX'S COVE

# PERMIT GRANTED

No. 1321

Expiry Date: 06-22-2007

Name Nu-muk Inc

Address 69 Country Road

Specification 7 Bams 5 @ 33x448 2 @ 37x448

This building permit is condition on compliance with the building regulation of the Community of Cox's Cove (the National Building Code of Canada). It is your responsibility to ensure compliance, Council will not be undertaking inspections.

**NOTE:** *The Cox's Cove Town Council approves your request to build 7 bams but is subject to the concerns of other departments.*

*Michelle Restell*

PRINTED BY COMMERCIAL PRINTING LTD.

**NEW**

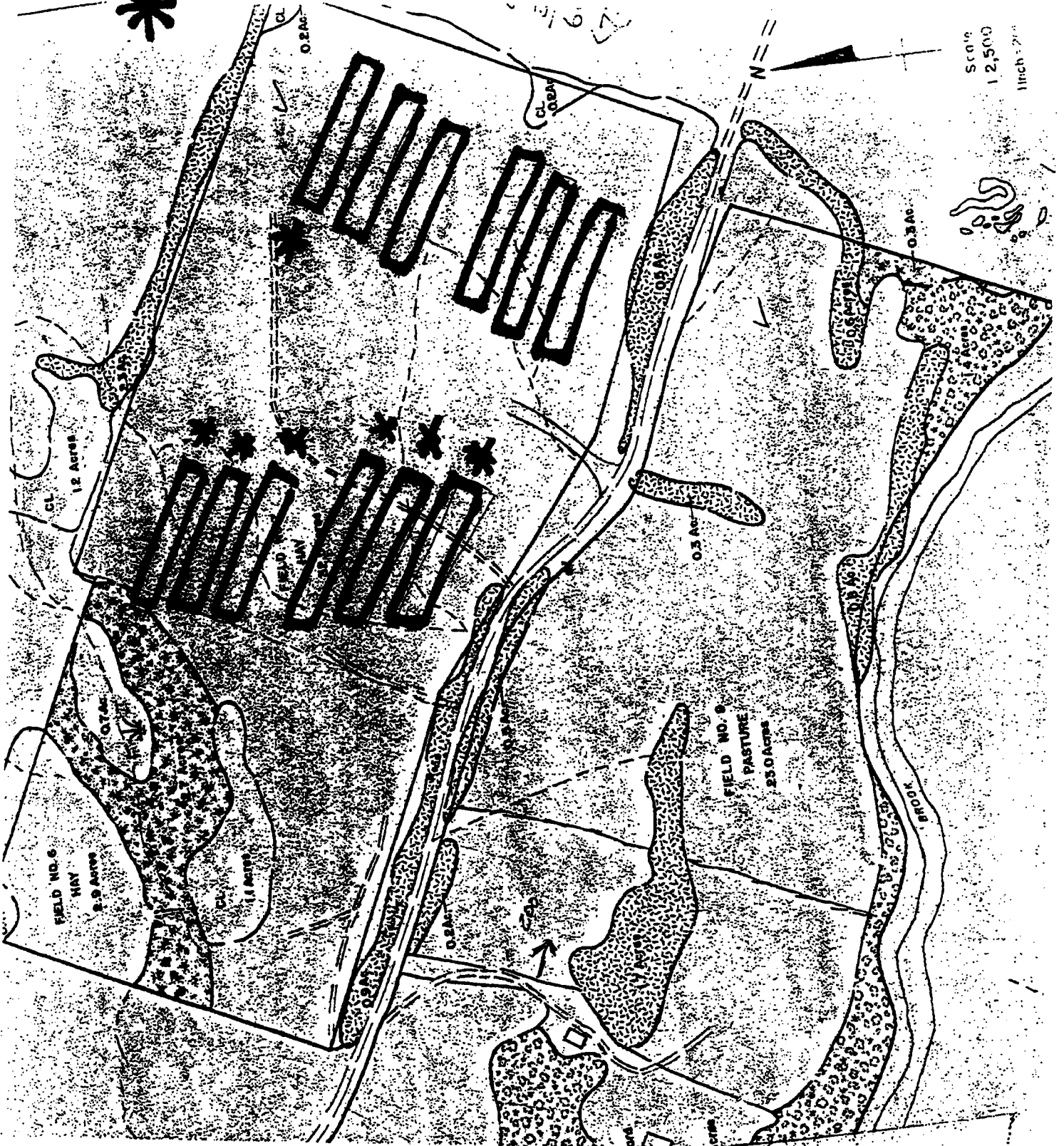

THE COMMUNITY OF COX'S COVE

# PERMIT GRANTED

No. 1330 Expiry Date: 08-17-07

Name Nu-Mink Inc

Address 69 Country Road

Specification Apron Holding facility

Michelle Besten

This building permit is conditional on compliance with the building regulation of the Community of Cox's Cove (the National Building Code of Canada). It is your responsibility to ensure compliance. Council will not be undertaking inspections.

PRINTED BY COMMERCIAL PRINTING LTD.

MANUK & NATHAN

## **Appendix G**

Letter of Support from  
Town Council



The Town of Cox' Cove  
P.O. Box 100  
Cox's Cove, NL  
AOL-1C0  
Tel/Fax (709) 688-2900

February 12, 2007

Nu Mink Inc  
415 Griffin Drive  
Corner Brook, NL  
A2H 3E9

Dear Ms Moores;

In response to your request for expansion. The Town was impressed by Nu Mink Inc and how they complied with the Town's concerns regarding the condition of their work sites and serious concerns with the fly population. The Town is very cautious when it comes to the operations of The Mink Farm and will be monitoring the Mink farm very carefully. The Town hopes that Nu Mink Inc continues to keep up their new practices in running their operation; especially now that they are looking to expand. With the new changes that Nu Mink has made The Town is in support of The Mink Farm expanding.

If you have any questions, please feel free to contact the undersigned.

Sincerely;



Michelle Restell, Clerk