

NAME OF UNDERTAKING:

To access remote cottage from existing approved trail

PROPONENT:

- (i) **Name of applicant** **Wallace Keeping**
Address **P.O. Box 251**
Garnish, NL
Telephone **1-709-826-2183**
e-mail **wkeeping@hotmail.com**
- (ii) **Principal contact Person for purposes of environmental assessment:**
- Names: Wallace Keeping
Address P.O. Box 251
Garnish, NL
1-709-826-2183

THE UNDERTAKING

- (i) **Purpose/Rational/Need for the Undertaking:**
- To access remote cottage # 131634 from existing ATV trail

DESPRITION OF THE UNDERTAKING:

- (i) **Geographical Location**
- Description of the proposed site:
To leave existing trail and end at cottage #131634 the actual new trail construction is approximately .5 km.
- (ii) **Physical Features:**
- Major physical features of the undertaking
There are no man-made physical features along the proposed trail route
 - **Areas to be affected by the undertaking:**
Trail excavation will occur between the existing trail and remote cottage # 131634
 - **A description of the physical and biological environment:**

The terrain along the trail consist of mostly barren 70%, wetland approximately 15%, wooded area approximately 15%. These points are indicated on the provided map. Two (2) wooden bridges measuring approximately 6 ` x 6 ` are required in wetland area to allow run-off due to spring thaw and heavy rain. There are no stream crossings.

Construction:

- **Approximate total construction period:**
At estimated construction speed of 1 km per day, trail excavation will require approximately 1 day.
- **Proposed date of first physical construction-related activity on site:**
April 2010
- **Potential sources of pollutants during the construction period:**
Possible pollutants include air pollution from excavator diesel engine
Possible water pollution from the oil and fuel used by the excavator.
- **Potential causes of resource conflicts:**
There is no resource activity currently in process along the proposed trail route.

(iii) **Operation**

- **Description of the Operation:**
Once the trail is complete it will allow access to remote cottage by walking or ATV.
- **Estimated period of operation:**
The trail will be accessible year round
- **Potential sources of pollutants during operation periods:**
Fuel or oil leaks from ATV's.
- **Potential causes of resource conflicts:**

There are no industrial resource activities along the proposed trail route

Occupations:

- estimate the number of employees for construction and operation of the project as well as expected duration of employment.

During Construction Period:

1 Excavator operator- 1 Day
Labour to be carried out by proponent

During Operation of the Trail

Maintenance to be carried out by the Proponent at the cost of the proponent

- **Identify what work will be carried out by direct hiring and contracting/out**

No maintenance and repair work will be done by direct hire

- **Identify how employment equity will be addressed to relative to age and gender.**

Not Applicable

- **Provide a bibliography of all project-related documents already generated.**

Not applicable

APPROVAL OF THE UNDERTAKING:

- List the main permits, licences, approvals and other forms of authorization required for the undertaking, along with the names of the authorities responsible for issuing them.
 1. Permit to Occupy – Crown Lands, Government of Newfoundland Labrador
 2. Department of Forestry, Government of Newfoundland Labrador

Schedule:

- **Indicate the earliest date and latest dates which project construction could commence**

Earliest date construction could begin is April 1, 2010.

Latest date construction could begin is October 1, 2010. After this date frost and winter storms could be delaying factors.

Funding:

- No funding required cost to be the responsibility of the proponent.

Dec 26/09
Date

Wallace Murray
Signature of Applicant

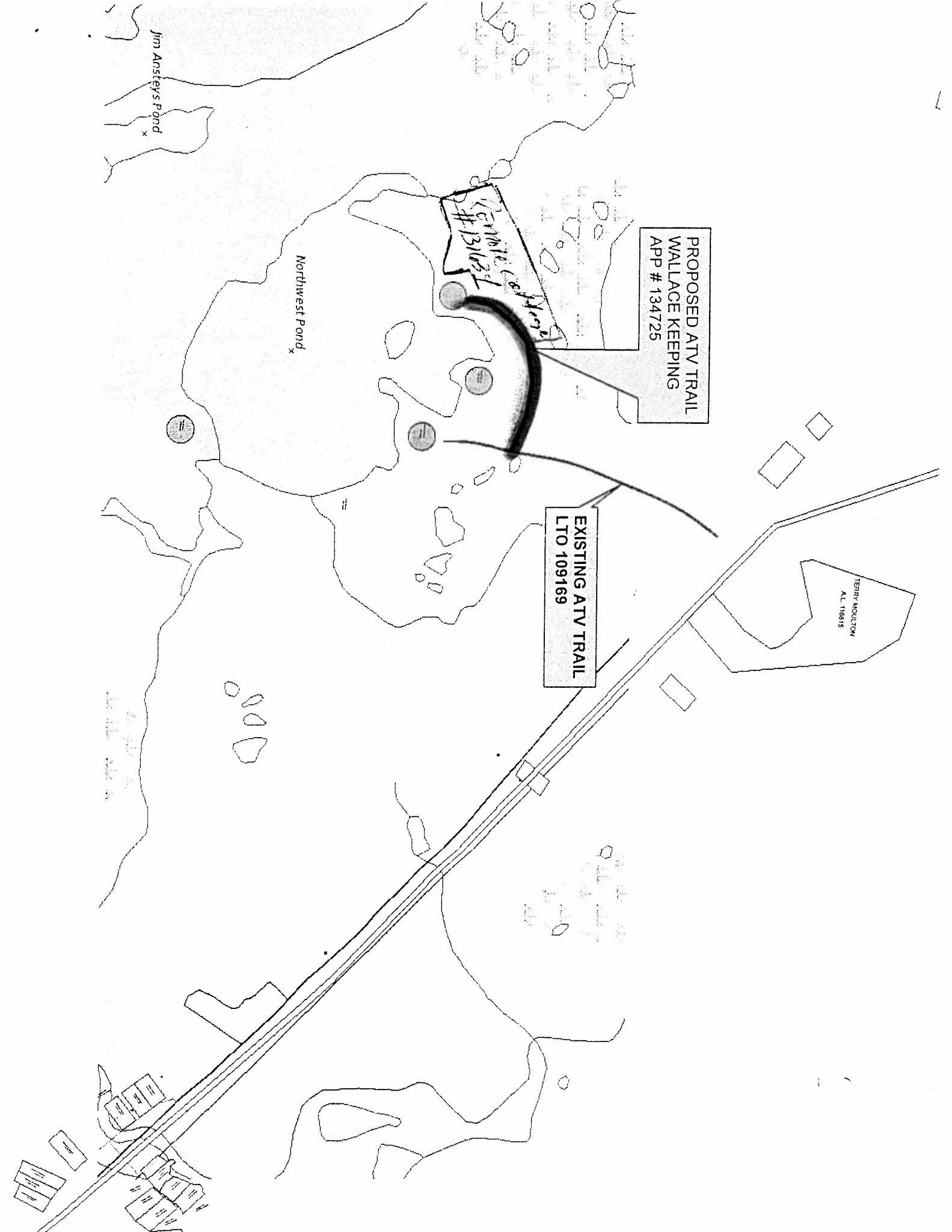

PROPOSED ATV TRAIL
WALLACE KEEPING
APP # 134725

EXISTING ATV TRAIL
LTO 109169

Vernon Co. #131681

TERRY MOUTON
AL 11815

Northwest Pond x

Jim Anstey's Pond x

