

D. BYRNE & SONS LIMITED

GENERAL CONTRACTORS

P.O. Box 383, Botwood, NF, A0H 1E0
Tel: 709-257-3808 Fax: 709-257-3274

February 18, 2010

Minister of Environment and Conservation

P.O. Box 8700

St. John's, NL

A1B 4J6

Attention: Director of Environmental Assessment

To Whom It May Concern:

Enclosed you will find 40 copies of Appendix 1 Registration Format for our Environmental Assessment Process. I trust you will find this satisfactory.

Sincerely,

A handwritten signature in cursive script that reads "Peter Byrne".

Peter Byrne

D. BYRNE & SONS LIMITED

GENERAL CONTRACTORS

P.O. Box 383, Botwood, NF, A0H 1E0
Tel: 709-257-3808 Fax: 709-257-3274

Name of Undertaking:

Operation of Peat Quarry

Proponent:

D. Byrne and Sons Ltd.

P.O. Box 383

Botwood, NL

A0H 1E0

Chief Executive Officer: Peter Byrne

Owner/Manager

P.O. Box 234

Botwood, NL

A0H 1E0

(709)257-2116 Cell: (709)486-2327

Principal Contact Person for purposes of environmental assessment: Peter Byrne

D. BYRNE & SONS LIMITED

GENERAL CONTRACTORS

P.O. Box 383, Botwood, NF, A0H 1E0
Tel: 709-257-3808 Fax: 709-257-3274

The Undertaking:

The proponent plans to operate a quarry to extract peat to mix with topsoil to produce a better quality topsoil for public sale.

Description of the Undertaking:

(i) Geographical Location:

The proposed site runs adjacent with D. Byrne and Sons Ltd. Quarry lease off Route 350.

(ii) Physical Features:

See attached topographical map.

(iii) Construction:

No construction necessary.

(iv) Operation:

The quarry will be used for the screening of peat and for the mixture of topsoil for public sale.

(v) Occupations:

Occupations of employees will be heavy equipment operators/truck drivers.

(vi) Project-Related Documents:

~ Aerial map of site and surrounding area

~ Survey of site

~ Survey of adjacent site

D. BYRNE & SONS LIMITED

GENERAL CONTRACTORS

P.O. Box 383, Botwood, NF, A0H 1E0
Tel: 709-257-3808 Fax: 709-257-3274

Approval of the Undertaking:

Works, Services and Transportation – Grand Falls-Windsor

Government Services and Lands – Grand Falls-Windsor

Crown Lands – Gander

Dept of Mines and Energy – Bill Oldford

The Town of Botwood

Schedule:

No construction necessary to start up operations.

Funding:

No funding required.

Feb 18/10

Date

Pete Byrne

Signature of Chief Executive Officer

Google maps
Canada

To see all the details that are visible on the screen, use the "Print" link next to the map.

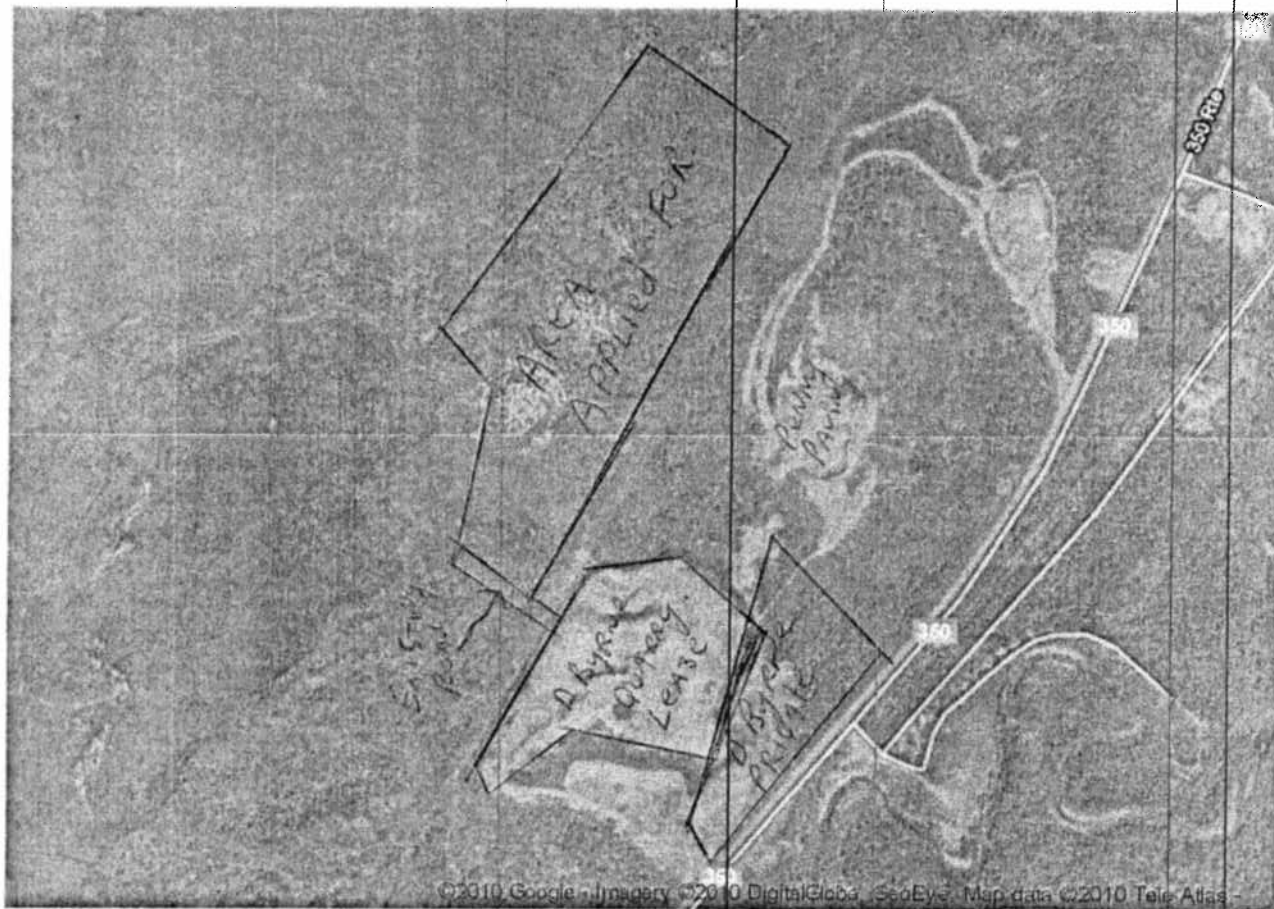

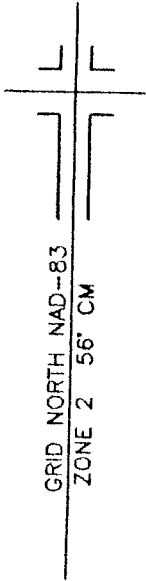

AREA APPROVED

TRANSMISSION LINE
CROWN LAND

CROWN LAND

AREA = 9.510 Ha.

CROWN LAND

ANGLO NEWFOUNDLAND DEVELOPMENT
COMPANY LIMITED
VOL. 94 FOL. 190
NOW ABITIBI CONSOLIDATED INC.

N 5441716.390
E 349456.909

ACCESS ROAD
TO ROUTE 350

ROUTE 350

3° MTM COORDINATES

| STATION | NORTHING | EASTING |
|--------------|---------------|--------------|
| 76G2151 | 5444195.980 m | 351691.140 m |
| STARTING PT. | 5441716.390 m | 349456.909 m |

