

Environmental Assessment Registration Document

**Crab Processing Facility
Mary's Harbour, Labrador**

**Labrador Fishermen's Union Shrimp Company Limited
P.O. Box 130
L'Anse Au Loup, Labrador
A0K 3L0**

Environmental Assessment Registration Document

NAME OF UNDERTAKING: Crab Processing Facility

PROPONENT:

- (i) **Name of Corporate Body:**
Labrador Fishermen's Union Shrimp Company Limited (LFUSC)

- (ii) **Address:**
Labrador Fishermen's Union Shrimp Company Limited
P.O. Box 130
L'Anse Au Loup, Labrador, NL
A0K 3L0

- (iii) **Chief Executive Officer:**
Name: Gilbert Linstead
Official Title: General Manager
Address: P.O. Box 130
L'Anse Au Loup, Labrador, NL
A0K 3L0
Telephone #: 709-927-5546

- (iv) **Principal Contact Person for Purposes of Environmental Assessment:**
Name: Aldwin H. Boone
Official Title: Principal
Address: The NewLantic Group
7 Creedon Place
St. John's, NL
A1E 5G6
Telephone #: 709-745-1225

THE UNDERTAKING:

- (i) **Nature of the Undertaking:**
To construct a modern state-of-the-art crab processing facility in Mary's Harbour.

- (ii) **Purpose/Rationale/Need for the Undertaking:**
To replace LFUSC's present Mary's Harbour crab processing facility. The existing processing facility is very old and not able to employ state-of-the-art technology/work

Environmental Assessment Registration Document

methods used at other processing facilities within the province. The new modern facility will employ the latest technology/methods, produce high quality products, and hence be more profitable than the existing operation.

DESCRIPTION OF THE UNDERTAKING:

(i) Geographical Location:

The plan is to locate the crab processing facility in Mary's Harbour on Crown Land adjacent to the Government/plant wharf on the South and the community road to town center on the East. This makes an ideal site for a new processing facility, refer to maps/site plan attached.

(ii) Physical Features:

The facility will be a pre-engineered steel building, single story structure, 80' wide by 260' long by 20' high c/w standing seam roof, R20 insulation in walls and roof, and metal siding.

Constructing the facility adjacent to the Government/plant wharf will provide numerous benefits including:

- flexibility of offloading vessels,
- ease of transporting of raw material from vessels, and
- convenience of supplying ice, bait, etc. to vessels.

Plant employees will park their vehicles and access the plant on the North while shipping of finished product and receiving of packaging materials will take place on the East - locating these activities away from the wharf will help eliminate congestion that would otherwise occur when offloading vessels.

To make the site large enough for the processing facility, rock will be blasted from the embankment area near the community road to town center on the East and placed in the harbour water on the West. Additional rock, if required, will be obtained from a nearby quarry. The current shoreline is a natural site, other than the recently filled-in area where the fishermen's haul-up is located. A total of 450 square meters of harbour will be filled-in. The deepest location of water that will be filled-in is ~ 6', with most areas being between 2' and 4'.

(iii) Construction:

The conceptual design of the facility has been completed. Construction will begin as soon as LFUSC receives title for the Crown Land and Environmental Approval. A tentative construction schedule is as follows:

- prepare site: immediately
- erect building: September 2010
- install equipment: March 2011
- commission operation: May 2011

All solid waste materials from the construction of the facility will be disposed of at the Mary's Harbour community landfill site according to Government regulations.

There are no resource conflicts anticipated during the construction phase of this project.

(iv) Operation:

The facility will have the capability of processing live snow crab into either cooked or raw sections. A typical processing flow will include blanching, washing, butchering, grading, packing, cooking, cooling, finished product weighing, brine freezing, glazing, after freezing, and mastering. Processing will take place for approximately six (6) months of the year, May through to October.

No changes are anticipated in the annual volume of raw material that the new facility will process compared to the existing facility. Hence there will be very little changes in the amount of processed effluent generated from production or in the amount of finished product shipped out other than that generated through improvements in production efficiencies and effectiveness. However, improvement in production efficiencies and effectiveness will result in the current 12 hrs. shifts employed in the existing facility being replaced with 9 hrs. shifts in the new facility.

The facility will use 100% fresh water obtained from the town's municipal system. An estimated 600 GPM will be required when the facility is in operation; this compares to 400 GPM used by the existing facility (200 GPM through a saltwater system and 200 GPM from the town's municipal system).

Environmental Assessment Registration Document

There are two possible sources of waste/effluent from the facility, as follows:

- domestic sewage from toilets and washrooms that will be routed through the town's municipal system, and
- processed effluent generated from production (by products, such as shell, viscera, etc.) that will be directed to a barge and transported to an approved ocean disposal site after passing through a screening set-up to separate solids from water - a process that is ongoing in the existing processing facility. Permission to undertake the ocean disposal will be through a permit from Environment Canada pursuant to the Canadian Environment Protection Dumping Regulations.

A 3000 gallon fuel (diesel gas) storage tank will be located on the harbour side of the facility. This tank will be double walled/dyked to meet Government regulations. A similar type storage tank is presently used at the existing facility.

The new facility will have odours similar to that of a typical crab processing operation. These odours will be no different from those emitted from the existing facility.

There are no resource conflicts anticipated during the operation of the facility.

(v) Occupations:

During the six (6) months construction of the facility, LFUSC will hire 8 to 10 people. The workers will mostly be carpenters and labourers. There will also be contractors working on the construction site such as steel erection specialists, cement finishers, plumbers, electricians, and boiler/refrigeration engineers.

During the operation of the facility, a planned workforce of 65 - 80 workers is anticipated. These will be permanent seasonal workers transferred from the Company's existing processing facility.

(vi) Project Related Documents:

This is a new project and there have been no related documents generated.

Environmental Assessment Registration Document

APPROVAL OF THE UNDERTAKING:

A list of permits, licences and approvals required for the proposed project are as follows:

- | | | |
|-------|--|---|
| (i) | Application for Grant of Land | Dept. of Environment & Conservation
Government of NL |
| (ii) | Environmental Assessment | Dept. of Environment & Conservation
Government of NL |
| (iii) | Processing Licence | Dept. of Fisheries
Government of NL |
| (iv) | Canadian Food Inspection
Agency Licence | Government of Canada |
| (v) | Business Permit | Municipal Council
Town of Mary's Harbour |

SCHEDULE:

Construction will commence immediately after the approval of the Grant of Land and Environmental Assessment. It is critical that construction begins in June 2010 if the Company is to meet the planned commission operation date of May 2011, the start of the crab fishing season. If the Company is unable to meet the May 2011 date, than the project's commission date will have to be deferred to May 2012.

FUNDING:

Funding for the facility, estimated to be ~\$4 million, will come from private investors.

Date

Signature of General Manager

E 316000

E 316200

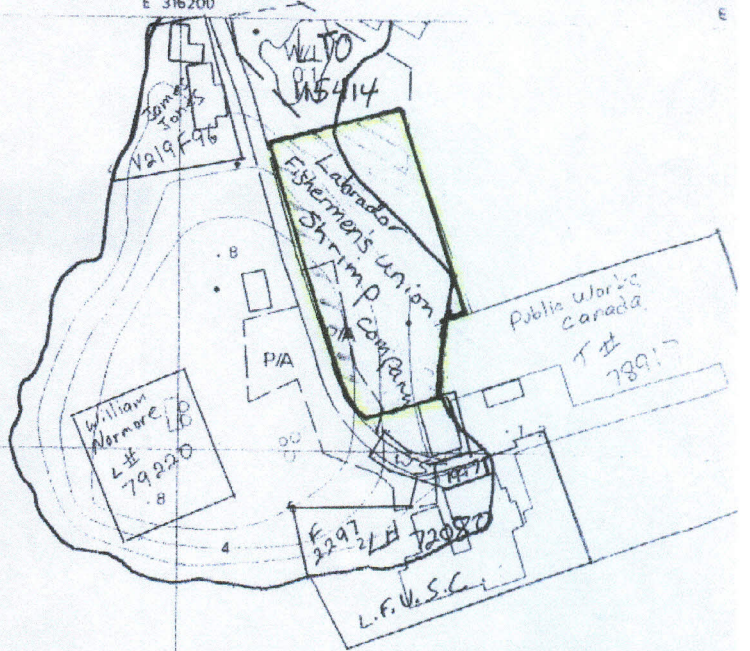

Labrador Fisherman's Union
 Shrimp Company
 Mary's Harbour, NL
 Mapsheet 3D5-146
 Application # 136235

MARY'S HARBOUR
 SEA LEVEL

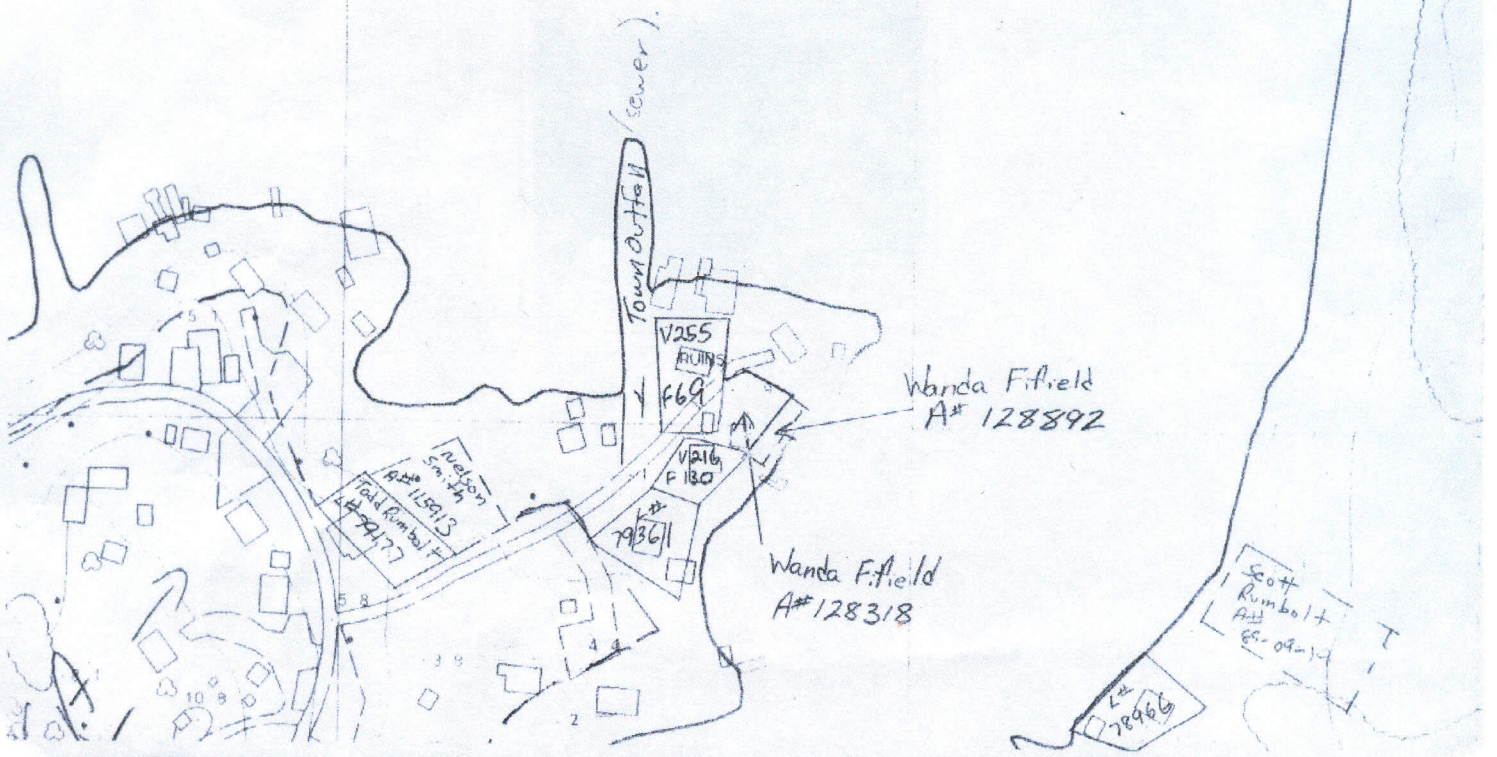

Government of Newfoundland & Labrador
Department of Environment & Conservation



NOTE TO USERS

The information on this map was compiled from land surveys registered in the Crown Lands Registry.

Since the Registry does not contain information on all land ownership within the Province, the information depicted cannot be considered complete.

The boundary lines shown are intended to be used as an index to land titles issued by the Crown. The accuracy of the plot is not sufficient for measurement purposes and does not guarantee title.

Users finding any errors or omissions on this map sheet are asked to contact the Crown Titles Mapping Section, Howley Building Higgins Line, St. John's Newfoundland.

Users finding error or omissions can contact the Crown Titles Mapping Section by telephone at 729-0081. Some titles may not be plotted due to Crown Lands volumes missing from the Crown Lands registry or not plotted due to insufficient survey information.

The User hereby indemnifies and saves harmless the Minister, his officers, employees and agents from and against all claims, demands, liabilities, actions or cause of actions alleging any loss, injury, damages and matter (including claims or demands for any violation of copyright or intellectual property) arising out of any missing or incomplete Crown Land titles, and the Minister, his or her officers, employees and agents shall not be liable for any loss of profits or contracts or any other loss of any kind as a result.

For inquiries please contact a Regional Lands Office.
Comer Brook - 637-2387
Gander - 256-1400
Goose Bay - 896-2488
St. John's - 729-2654
Clareville - 466-4074

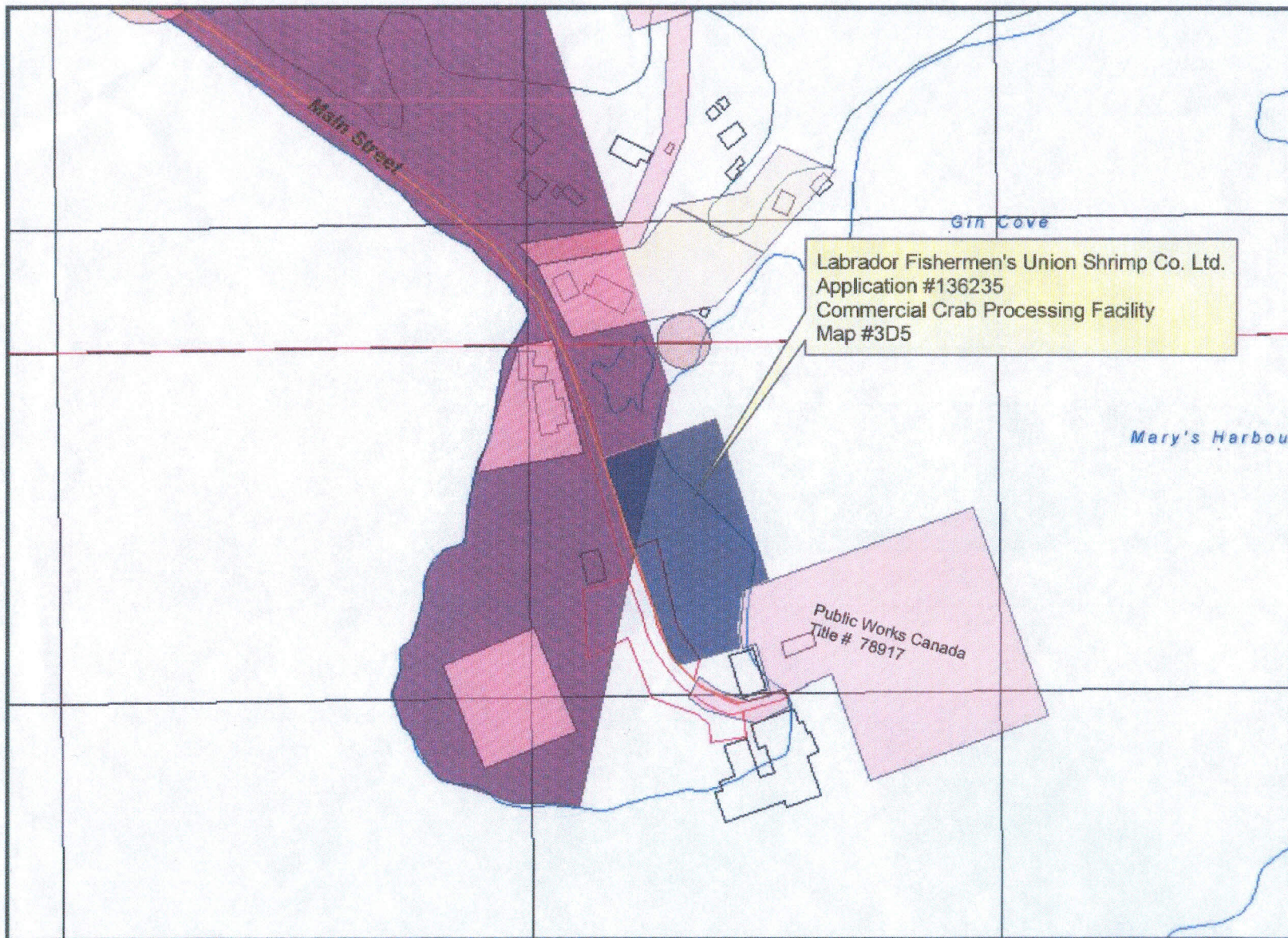

Scale 1:2,500
May 4, 2010

Crown Lands Division

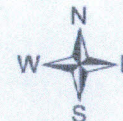
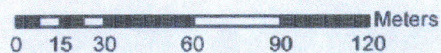

LABRADOR FISHERMEN'S UNION SHRIMP COMPANY – MARY'S HARBOUR

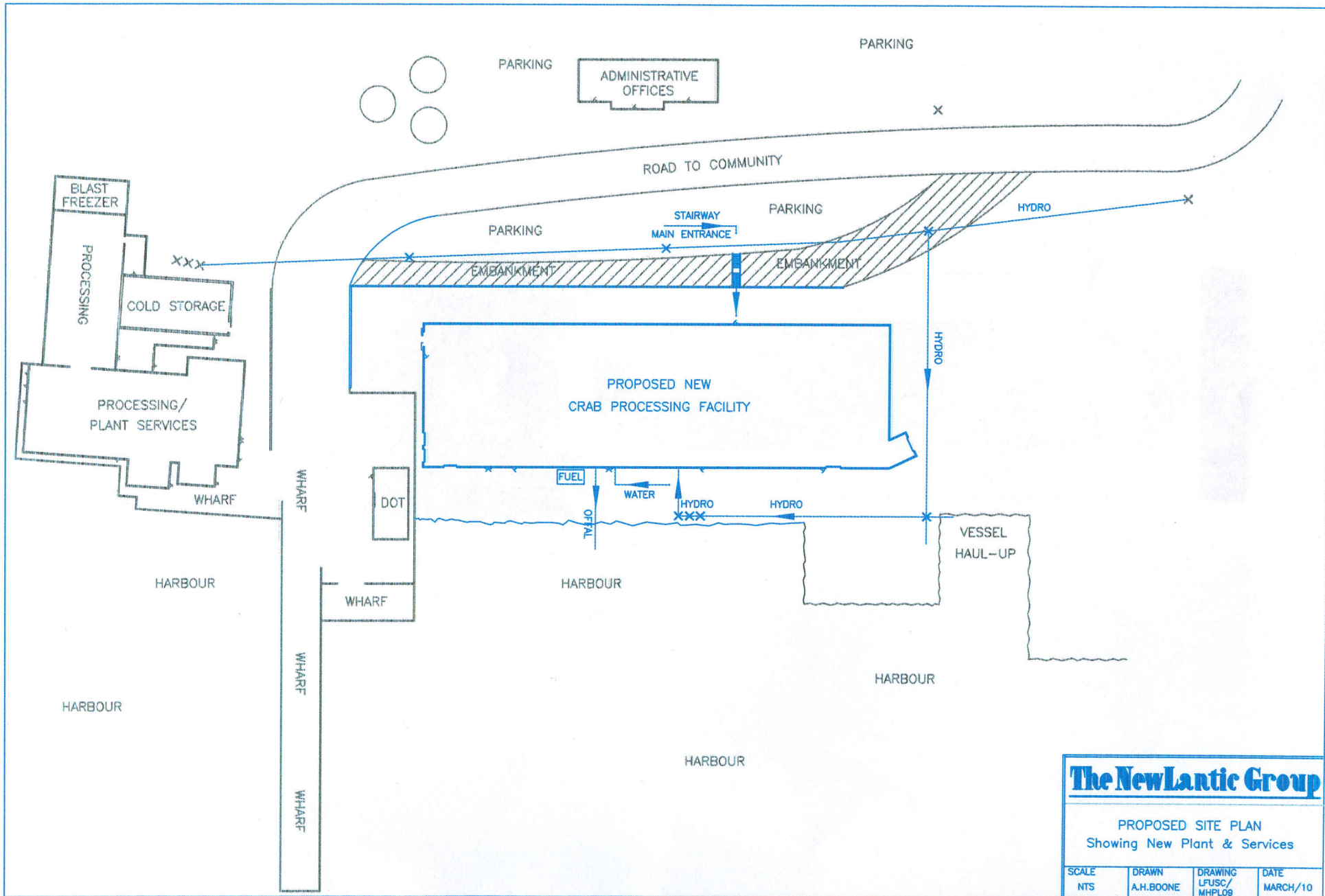

The NewLantic Group

PROPOSED SITE PLAN
Showing New Plant & Services

SCALE NTS	DRAWN A.H. BOONE	DRAWING LFUSC/ MHPLOS	DATE MARCH/10
--------------	---------------------	-----------------------------	------------------