

## ENVIRONMENTAL ASSESSMENT PROCESS

Name of The Undertaking

---

Humber Village Snowmobile Trail

Proponents:

---

John Jenniex  
Box 2309 RR1  
Corner Brook NL A2H2N2

Cecil Collins  
Box 2316 RR1  
Corner Brook NI A2H2N2

The Undertaking

---

The Proponents intend to develop a snowmobile trail; originating in the community of Humber Village, which of course is situated in the Humber Valley in Western Newfoundland. The trail is to provide a safe access out of the Village to connect with existing logging and other road networks and ultimately to the groomed trails managed by The Newfoundland and Labrador Snowmobile Federation. At the present time no such access exists. The proposed trail would exit the Village from Village property onto crown land in a northwest direction for approximately one (1) klm and then turn Northeast for approximately two Klms where it would intersect a forest access road. It should be noted that this is the only area where the terrance is adequate to build a trail apart from locations starting on private land which of course is not vavilable to us.

Description of the Undertaking:

---

(1) Geographic Location.

Humber Village area-see the attached map (Appendix # 1)

(11) Physical Features.

Snowmobile Trail Only.

(!!!) Construction:

Not Applicable

(IV) Operation

See the "Undertaking"

(v) Occupations

Volunteers (exclusively)

(V1) Project Related Documents:

See appendix 11

(V11) Approval of The Undertaking:

See appendix 111

Schedules

---

The commencement will be as soon as the final approval is gotten from Crown Lands and the permit is issued. The duration is dependent on the time of year approval is gotten; however our plan is to commence development around the first week of September and have it completed sometime before the end of November. We would want to work within that timeframe as it is after the fire season and before the first major snowfall and the onset of winter.

Funding:

We are not looing for or anticipating any funding. The whole exercise will be done both by volunteers and contributions from the snowmobiling community of Humber Village.

## Appendix # 1

Government of Newfoundland & Labrador  
 Department of Environment & Conservation



**NOTE TO USERS**

The information on this map was compiled from land surveys registered in the Crown Lands Registry.

Since the Registry does not contain information on all land ownership within the Province, the information depicted cannot be considered complete.

The boundary lines shown are intended to be used as an index to land titles issued by the Crown. The accuracy of the plot is not sufficient for measurement purposes and does not guarantee title.

Users finding any errors or omissions on this map sheet are asked to contact the Crown Titles Mapping Section, Howley Building Higgins Line, St. John's Newfoundland.

Users finding error or omissions can contact the Crown Titles Mapping Section by telephone at 729-0091. Some titles may not be plotted due to Crown Lands volumes missing from the Crown Lands registry or not plotted due to insufficient survey information.

The User hereby indemnifies and saves harmless the Minister, his officers, employees and agents from and against all claims, demands, liabilities, actions or causes of actions arising any loss, injury, damages and matter (including claims or demands for any violation of copyright or intellectual property) arising out of any misreading or incomplete Crown Land titles, and the Minister, his or her officers, employees and agents shall not be liable for any loss of profits or contracts or any other loss of any kind as a result.

For inquiries please contact a Regional Lands Office.  
 Corner Brook - 637-2387  
 Garder - 256-1400  
 Goose Bay - 896-2488  
 St. John's - 729-2654  
 Clarenville - 466-4074

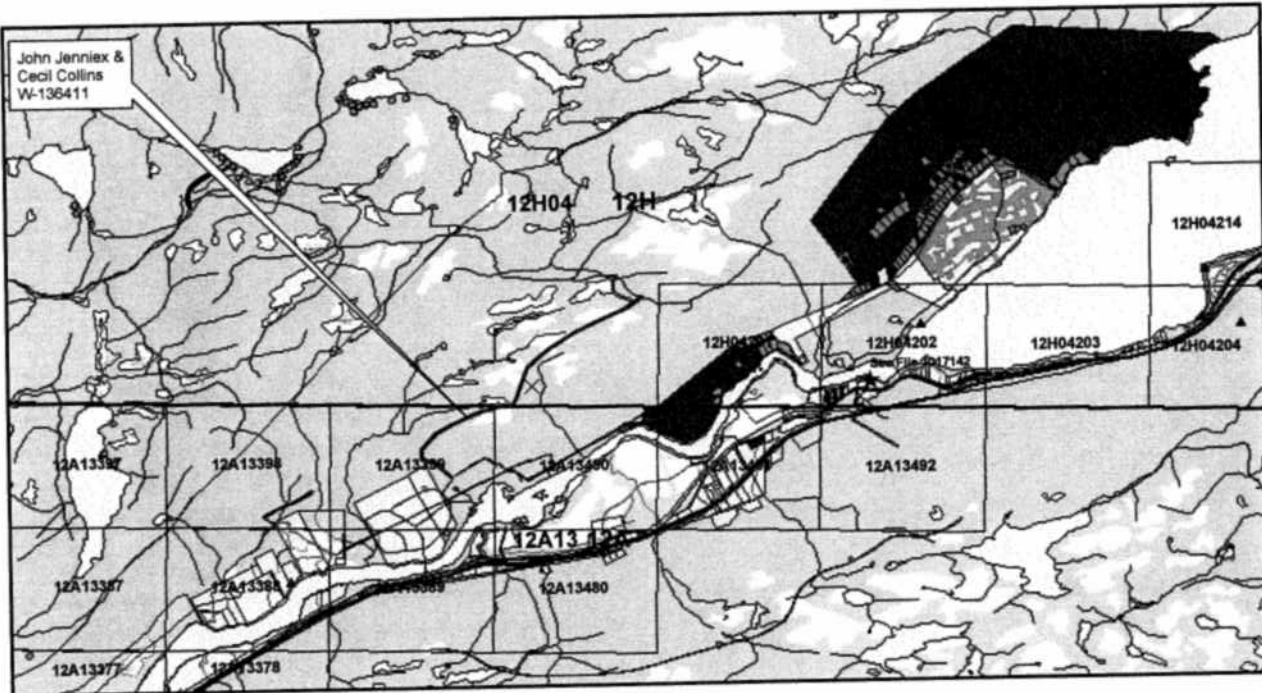

Crown Lands Division

Scale 1:50,000  
 Compiled on May 29, 2010

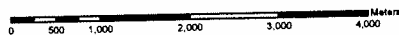

Government of Newfoundland & Labrador  
 Department of Environment & Conservation



**NOTE TO USERS**

The information on this map was compiled from land surveys registered in the Crown Lands Registry.

Since the Registry does not contain information on all land ownership within the Province, the information depicted cannot be considered complete.

The boundary lines shown are intended to be used as an index to land titles issued by the Crown. The accuracy of the plot is not sufficient for measurement purposes and does not guarantee title.

Users finding any errors or omissions on this map sheet are asked to contact the Crown Titles Mapping Section, Howley Building Higgins Line, St. John's Newfoundland.

Users finding error or omissions can contact the Crown Titles Mapping Section by telephone at 729-0061. Some titles may not be plotted due to Crown Lands volumes missing from the Crown Lands registry or not plotted due to insufficient survey information.

The User hereby indemnifies and saves harmless the Minister, his officers, employees and agents from and against all claims, demands, liabilities, actions or causes of actions alleging any loss, injury, damages and matter (including claims or demands for any violation of copyright or intellectual property) arising out of any missing or incomplete Crown Land titles, and the Minister, his or her officers, employees and agents shall not be liable for any loss of profits or contracts or any other loss of any kind as a result.

For inquiries please contact a Regional Lands Office.  
 Corner Brook - 637-2387  
 Gander - 256-1400  
 Goose Bay - 896-2488  
 St. John's - 729-2654  
 Clarenville - 466-4074



Scale 1:25,000  
 Compiled on May 29, 2010

**Crown Lands Division**

