

November 6th, 2012

Dept. of Environment & Conservation
P.O. Box 8700
St. John's, NL A1B 4J6

Attn: Mr. John Pennell

Dear Mr. Pennell:

Re: File Ref No. 200.20.2103
Application No. 141761

We are asking to register a project of constructing an access road between Sail Pond and Coles Pond, Roddickton, NL. As such we submit to you this draft with the following information:

Name of Corporate Body:

Address: The Apostolic Faith Mission
73 Cloud Drive, Roddickton, NL

Chief Executive Officer:

Rev. Rene S. Cassell
Canadian District Superintendent
71 Cloud Drive
Roddickton, NL A0K 4P0
(709) 457-2516

Principal Contact Person:

Rev. Rene S. Cassell

The Undertaking: Construct an access road between Sail Pond and Coles Pond. The purpose of this road is to make access by vehicle to our Youth Camp site. In the past it has been accessed by boat through the waters of Coles Pond. The road would provide a safer way to transport some 120 people during our week of Youth Camp activities.

Description of the Undertaking: As stated above we have used boats over the past years to transport campers to our camp site. We do feel that having the site connected by road, would be a more safer and convenient way. The proposed access road would be taken off from Sail Pond Road go NNE to Coles Pond (within 500 feet of the Pond). See [map 1](#) and [map 2](#).

Physical Features of Construction: The proposed road route (which is possibly less than a mile) connects with very little forest. We would engage a contractor to build the road. If the foundation of the road could start by December 1, 2012 it would have a period to settle over the winter months. We would complete the road and the bridge in the spring (not later than June 1st) giving us time to access the site and prepare for the 2013 annual Youth Camp. The road route has been selected by local forestry officials, which follows a previously forested area. It would be built as a single lane road with passing sections every 200-300 feet.

This access road over the long term would have no or a small impact on the water ways and associated fish populations.

Actually, we do not anticipate any impact on fish, wildlife or rare plants. It would have a much safer and more sustainable means to access the camp site. It would give us more of a social value for the camp and take away much of the present logistical burden in trying to transfer all of those children safely. By taking the two boats we now have (operated by gas motors) from the pond would also reduce the pollution factor at Coles Pond.

This less than one mile propose road is marginal compared to the total of all the other access roads in that area.

The route of the road takes us over one small brook (stream) which flows into Coles Pond. We are proposing to use wood beams to cross the brook and wood material to cover the bridge. It would be 8-10 feet long and 12 feet wide.

The design of the bridge will replicate the forestry bridges in that area. We will try and utilize the trees cut for the right-a-way and use for the bridge construction, minimizing the forestry impact. About 75% of the proposed route has few or no trees to cut. Most trees are north of the stream, near the camp site.

For the construction cost there is no grant or loan involved. We will fund the cost ourselves.

Taking into consideration the time of the season, we appreciate your earliest attention and response.

Yours truly,

Rev. Rene S. Cassell
District Superintendent/Pastor

RSC/djb

Enc: Maps

Map 1

Government of Newfoundland & Labrador Department of Environment & Conservation

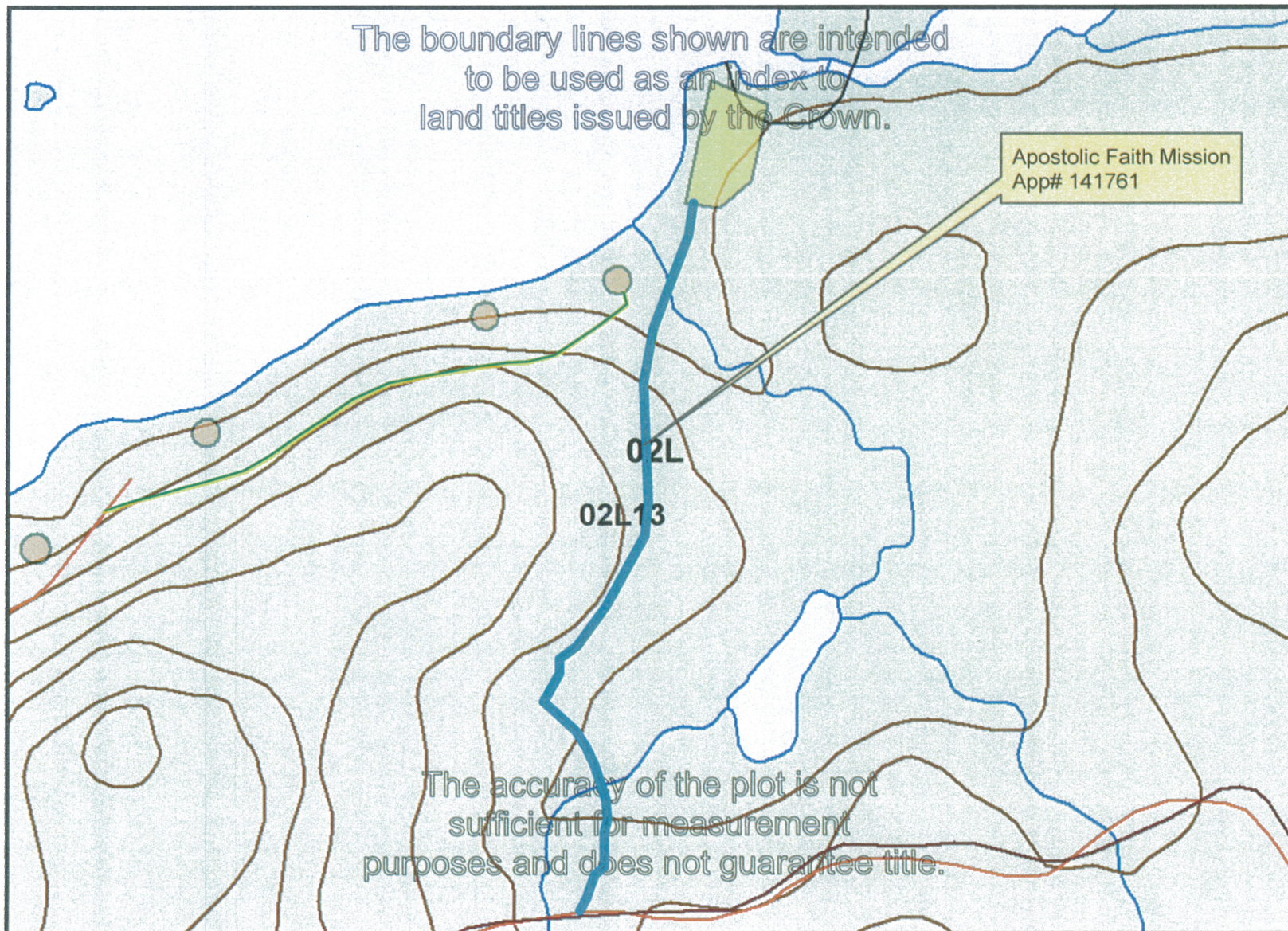

NOTE TO USERS

The information on this map was compiled from land surveys registered in the Crown Lands Registry.

Since the Registry does not contain information on all land ownership within the Province, the information depicted cannot be considered complete.

The boundary lines shown are intended to be used as an index to land titles issued by the Crown. The accuracy of the plot is not sufficient for measurement purposes and does not guarantee title.

Users finding any errors or omissions on this map sheet are asked to contact the Crown Titles Mapping Section, Howley Building Higgins Line, St. John's Newfoundland.

Users finding error or omissions can contact the Crown Titles Mapping Section by telephone at 729-0061. Some titles may not be plotted due to Crown Lands volumes missing from the Crown Lands registry or not plotted due to insufficient survey information.

The User hereby indemnifies and saves harmless the Minister, his officers, employees and agents from and against all claims, demands, liabilities, actions or cause of actions alleging any loss, injury, damages and matter (including claims or demands for any violation of copyright or intellectual property) arising out of any missing or incomplete Crown Land titles, and the Minister, his or her officers, employees and agents shall not be liable for any loss of profits or contracts or any other loss of any kind as a result.

For inquiries please contact a Regional Lands Office.
Corner Brook - 637-2387
Gander - 256-1400
Goose Bay - 896-2488
St. John's - 729-2654
Clareville - 466-4074

Scale 1:10,000

Compiled on Sep 17, 2012

Crown Lands Division



Map 2



Cules Pond

Scale 1:10,000