

Environmental Assessment Registration

Name of Undertaking: Mega Healthy Cranberry Farm

PROPONENT:

(i) Mega Healthy Cranberry farm

(ii) 13 Crewes Rd, Glovertown, NL A0G-2L0

(iii) Nancy Sweetapple, 13 Crewes Rd, Glovertown, NL, A0G-2L0 (709) 533-2492
home

(iv) Mr. Tony Mulrooney, 13 Crewes Rd, Glovertown, NL, A0G-2L0 (709) 533-2492
home (709) 424-1061 cell

THE UNDERTAKING:

(i) Nature of the Undertaking: Mega Healthy Cranberry Farm is presently seeking an Agriculture Crown Land Lease to develop and operate a cranberry farm in the Glovertown area.

(ii) Purpose / Rationale / Need for the Undertaking: We feel Newfoundland and Labrador is offering a significant opportunity for the development of a first class cranberry farm. The Glovertown area has a climate very suitable for cranberry production. This farm would contribute to the cranberry industry and help increase the overall yield of the berry which would be beneficial for future secondary processing on the island.

DESCRIPTION OF THE UNDERTAKING:

(i) Geographical Location:

The proposed site, 200 acres, is located off of the TCH, east of the Terra Nova River. A 1:50,000 scale location map and 1:24,000 scale map of the site is attached to this registration.

(ii) Physical Features: The bog was previously dredged and farmed. The ground vegetation consists of sphagnum moss, caribou moss, grasses and kalmia. There are no flashets or rock outcrops within the area proposed for development. The site is located between Terra Nova river and a water run off from the hills on the east of the fields. The area of this proposed site is approximately 200 acres. (We hope to develop the largest Cranberry farm in Newfoundland over the years)

No construction of a access road will be needed for this site. Minor work to repair the road that is currently on the farm.

(iii) Construction: The construction of the site will be subject to a detailed engineering design. The site will be a on going construction site for the development of the largest Cranberry farm in Newfoundland. The goal is to begin production on 6 acres within a two year period. Once operators are more familiar with construction of the beds, we feel more beds will be developed in a shorter time frame.

The Construction will consist of:

- Heavy equipment will be used to conduct preliminary ditching in the proposed berm locations and discharge areas;
- Cranberry bed development, consisting of removing a layer of peat to level the bed, with the excavated peat used for the berm construction measuring two metres high and five metres wide;
- Ditching between the bed and berm;
- Construction of discharge area/sediment pond;
- Installation of water control structures (sheet metal sluices);
- Installation of drainage tile in the bed;
- Construction of man made pond
- Placement and leveling of approximately 20 cm of sand on the constructed cranberry beds. If approval of Agriculture lease is granted, a application for the development of a “permitted” quarry will

be put in place. If not, sand will be purchased from permitted quarries.

Machinery diesel fuel and lubricants are potential sources of pollutants during the construction period. All Machinery and heavy equipment will be refueled and lubricated on mineral soil - off the construction site. Department of Environment and Conservation regulations will be used for the disposal of refuse and human waste. Buffers will be maintained between the development and water courses during (and after) the construction. The water courses are shown on the attached map. The buffers will be a minimum of 30 metres wide.

The phased development of this project will be completed over a five year period as follows:

Year 1 - Soil Samples, and all required surveys, soil depth and permits and application for Quarry development

Year 2 - 3 acre development or depending on engineering plans. Man made pond, water control structures.

Year 3 - 3 acre development

Year 4 - 3 acre development

year 5 - 3 acre development

(iv) Operations:

Mega Healthy Cranberry Farm is truly committed in producing a high quality cranberry product and developing and operating a world class environmental operation. The use of green technology will be incorporated and considered for all operational development.

The proposed cranberry site is located on a bog located between a freshwater river and a shallow water run off from the adjacent hills. There maybe a possibility of water fowl using the near by bodies of water, so we will be taking every precaution in observing the wildlife and water fowl and commensing

operations to not disturb or impact the well being of wildlife. The farm will not interfere with waterfowl feeding, nesting patterns, or with the hunting. We will use techniques which have been effective in controlling wildlife if in the future the wildlife is to jeopardize the crop yields and potentially damage the fields. Proper Departments will be contacted to help control such actions if need be. Noise makers, stimuli techniques, such as balloons, Mylar scare tape and plastic flags have proven useful.

The cranberry harvest consists of field by field flooding with approximately 30-45cm of water. Fields are flooded individually to reduce large volumes of discharge. While flooded, a cranberry beater will dislodge the cranberries from the vines underwater allowing them to float to the surface, where they are gathered by a boom and loaded into containers via a conveyor system. Once the harvesting of a field is completed, flood water discharge will be diverted into another field for harvesting or through maintained ditches and routed to a sediment pond, which will contain any potential contaminants, and act as a supplementary water source if required.

Farm operational procedures will be consistent with appropriate environmental standards for sustainable agriculture. Cranberry farms can be maintained for over 100 years.

Common agricultural chemicals, used at minimal levels on cranberry operations within the Province, include the following registered products:

Herbicides: Devrinol, Callisto, Roundup

Insecticides: Sevin, Diazinon

Fungicides: Bravo

Fertilizers: 17 17 17/50lbs/acre, 4600/10lbs/acre

Seven Fungicides - Ridomil

These products will be only purchase and used as needed.

(v) Occupations:

1. General Manager Full time.

2. Grower/Pesticide Applicator Full time.

3. Labourers Part time.

4. Equipment operator Full time.

5. Electrician.(Contractor) Part time.

6. Mechanic. (Contractor) Part time.

* Will include other positions as required

(vi) Project Related Documents:

Crown Land Application Number: 150754 in progress

Approval of the Undertaking:

Following is a list of main permits, licenses and approvals required for this project.

Approval/Certification/License/Permit Authority

Environmental Registration Department of Environment and Conservation

Environmental Assessment Approval Department of Environment and Conservation

Crown Land Department of Environment and Conservation

Fuel Storage & Handling. Department of Government Services

Road Access Approval Department of Transportation and Works

Pesticides (applicator/Operator) Department of Environment and Conservation

Water Use License Department of Environment and Conservation

Permit to Alter a Body of Water Department of Environment and Conservation

Workers Health and Safety Compensation Workplace Health Safety and Compensation
Commission

Schedule:

The earliest construction start date is May 2017, latest being May 2018.

Funding:

No application for funding at this time.

Date

Nancy Sweetapple (Owner)

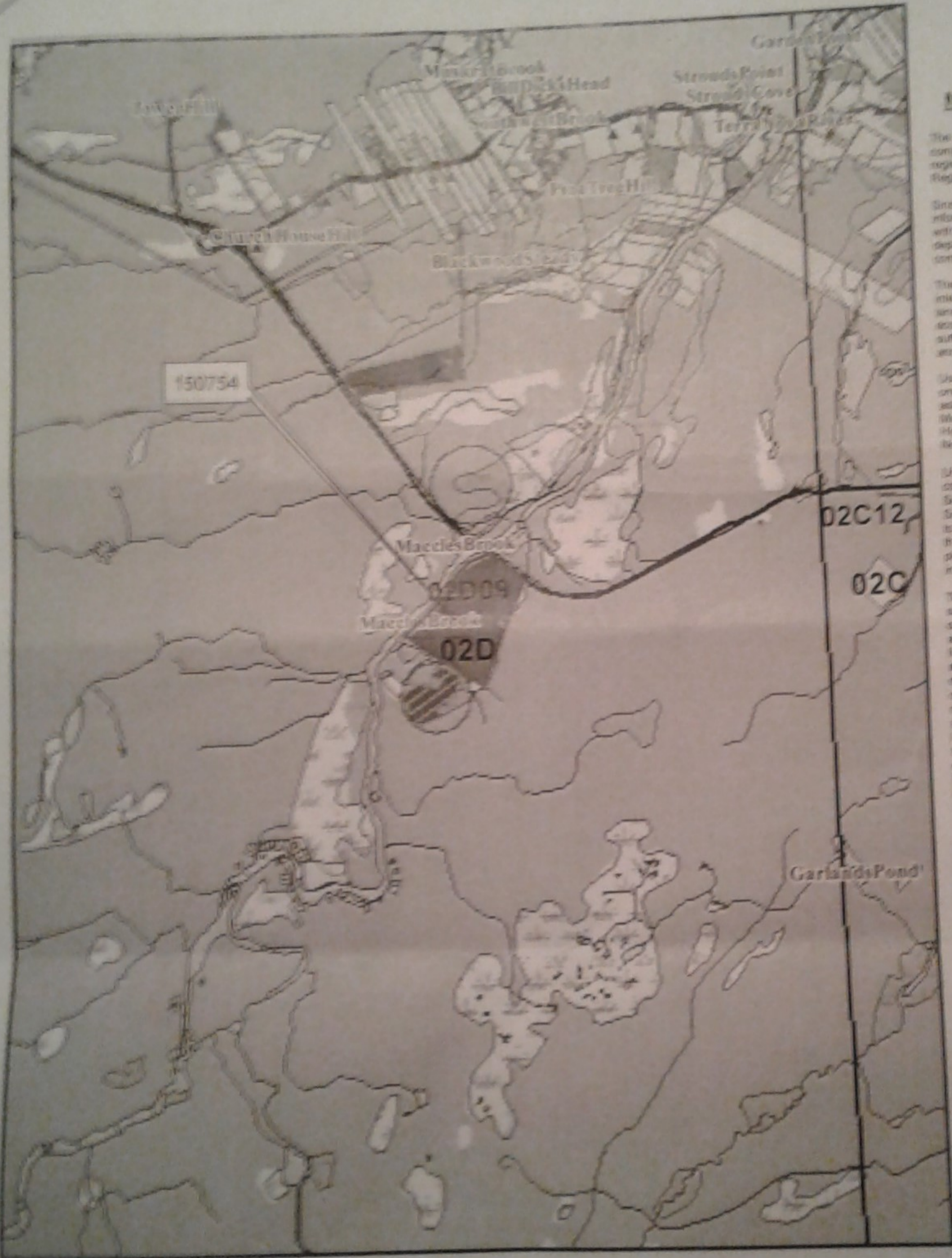

NOTE TO USERS

The information on this map was compiled from land surveys registered in the Crown Lands Registry.

Since the Registry does not contain information on all land ownership within the Province, the information depicted cannot be considered complete.

The boundary lines shown are intended to be used as an index to land titles issued by the Crown. The accuracy of the plot is not sufficient for measurement purposes and does not guarantee title.

Users finding any errors or omissions on this map sheet are asked to contact the Crown Titles Mapping Section, Howley Building, Higgins Lane, St. John's, Newfoundland.

Users finding error or omissions can contact the Crown Titles Mapping Section by telephone at 729-0061. Some titles may not be plotted due to Crown Lands volumes missing from the Crown Lands registry or not plotted due to insufficient survey information.

The User hereby indemnifies and saves harmless the Minister, his officers, employees and agents from and against all claims, demands, liabilities, actions or cause of actions alleging any loss, injury, damages and matter (including claim or demands for any violation of copyright or intellectual property) arising out of any missing or incomplete Crown Land titles and the Minister, his or her officers, employees and agents shall not be liable for any loss of profits or contracts or any other loss of a kind as a result.

For inquiries please contact a Regional Lands Office.
 Corner Brook - 637-2390
 Gander - 256-1400
 Clarenville - 466-4074
 St. John's - 725-2654
 Goose Bay - 896-2488

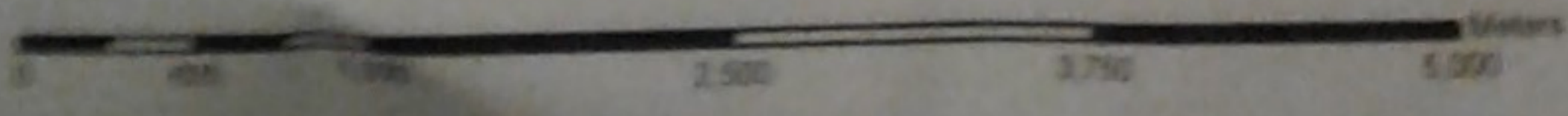

NOTE TO USERS

The information on this map was compiled from land survey data registered in the Crown Land Registry.

Since the Registry does not contain information on all land owners within the Province, the information depicted cannot be considered complete.

The boundary lines shown are intended to be used as an indication of land titles issued by the Crown. The accuracy of the plot is sufficient for measurement purposes and does not guarantee title.

Users finding any errors or omissions on this map sheet are asked to contact the Crown Land Mapping Section, Howley Building, Higgins Line, St. John's, Newfoundland.

Users finding error or omission should contact the Crown Titles Mapping Section by telephone at 729-4333. Some titles may not be plotted due to Crown Lands volumes missing from the Crown Lands registry or not plotted due to insufficient survey information.

The User hereby indemnifies and saves harmless the Minister, his officers, employees and agents and against all claims, damages, liabilities, actions or causes of actions alleging any loss, damages and matter (including costs or demands for any violation of copyright or intellectual property) arising out of any missing or incomplete Crown Land titles. The Minister, his or her officers, employees and agents shall not be liable for any loss of profit, contracts or any other loss of any kind as a result.

For inquiries please contact a Regional Lands Office:
Corner Brook - 637-2333
Gander - 256-1400
Clareville - 466-4074
St. John's - 729-2654
Goose Bay - 896-2488

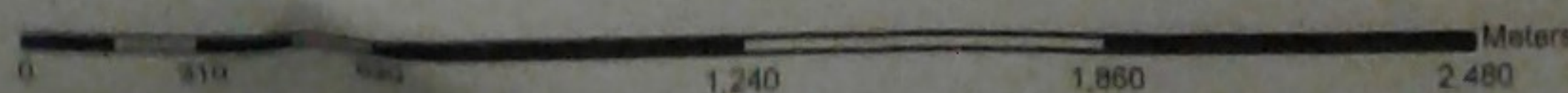
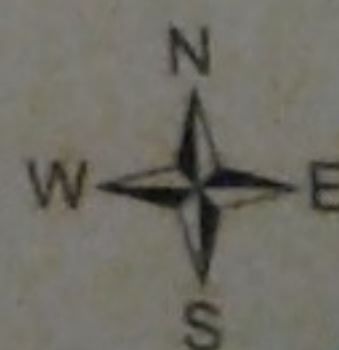
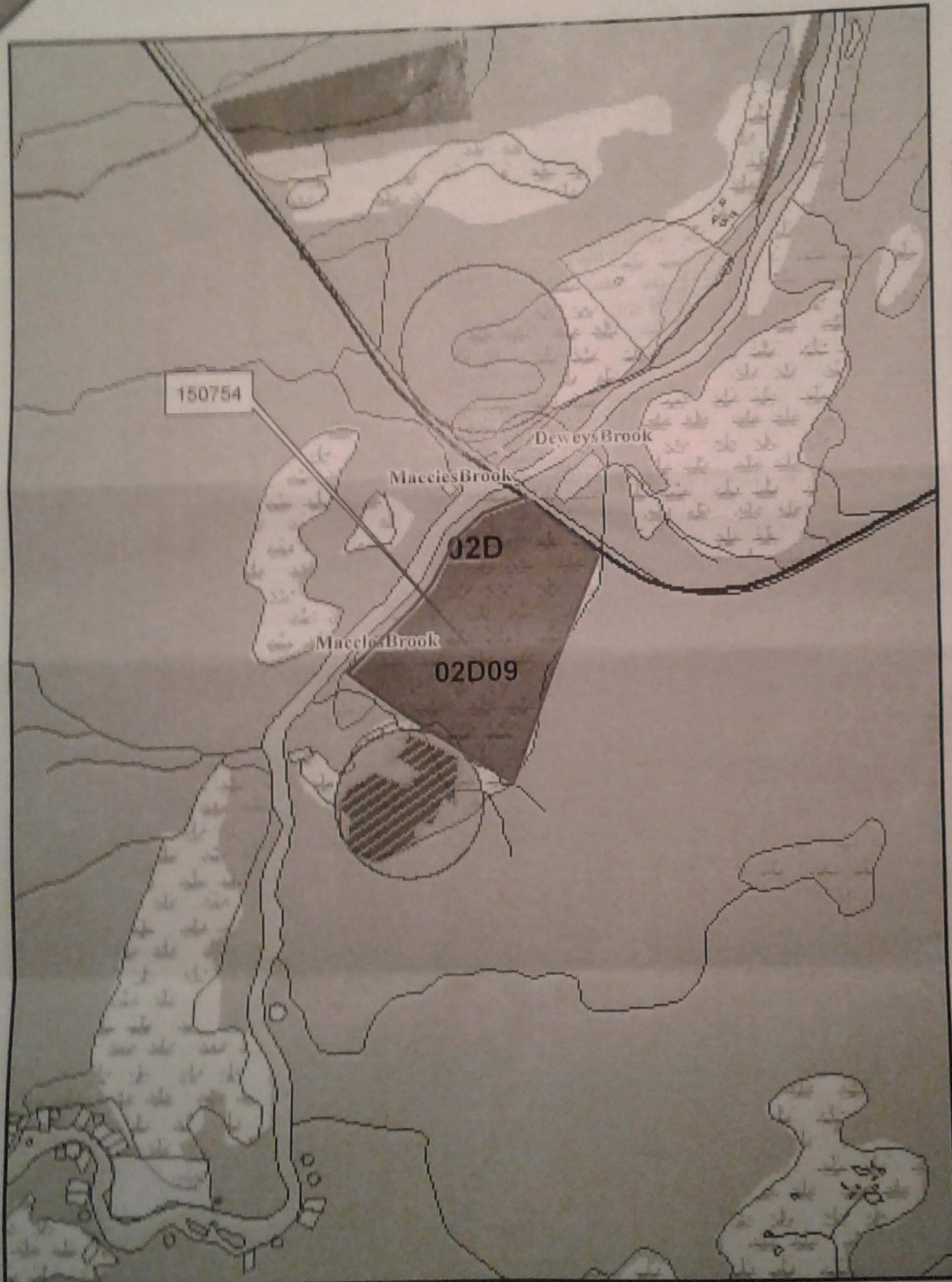

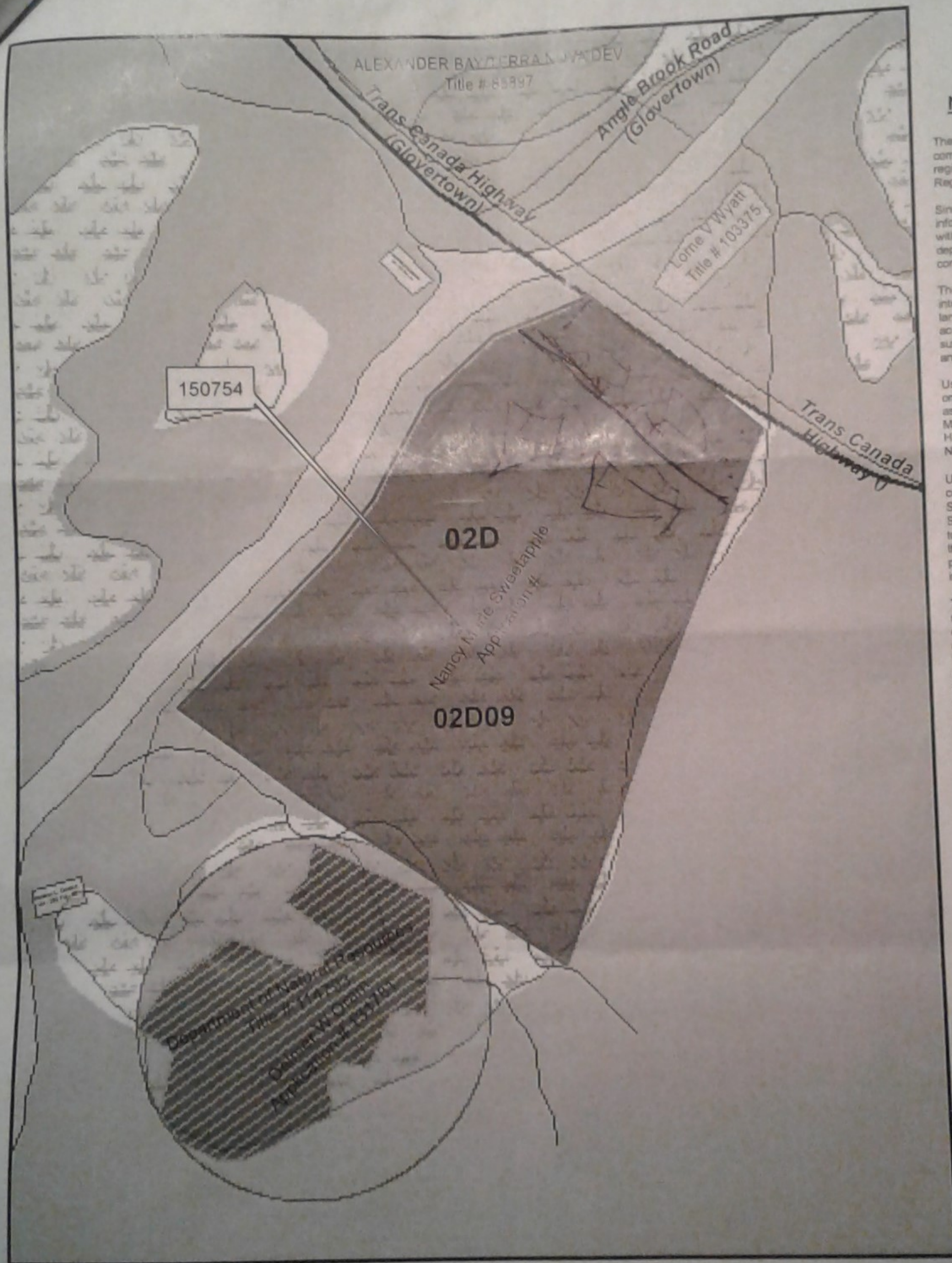

NOTE TO USERS

The information on this map was compiled from land surveys registered in the Crown Lands Registry.

Since the Registry does not contain information on all land ownership within the Province, the information depicted cannot be considered complete.

The boundary lines shown are intended to be used as an index to land titles issued by the Crown. The accuracy of the plot is not sufficient for measurement purposes and does not guarantee title.

Users finding any errors or omissions on this map sheet are asked to contact the Crown Titles Mapping Section, Howley Building Higgins Line St. John's Newfoundland.

Users finding error or omissions can contact the Crown Titles Mapping Section by telephone at 729-0061. Some titles may not be plotted due to Crown Lands volumes missing from the Crown Lands registry or not plotted due to insufficient survey information.

The User hereby indemnifies and saves harmless the Minister, his officers, employees and agents from and against all claims, demands, liabilities, actions or cause of actions alleging any loss, injury, damages and matter (including claims or demands for any violation of copyright or intellectual property) arising out of any missing or incomplete Crown Land titles, and the Minister, his or her officers, employees and agents shall not be liable for any loss of profits or contracts or any other loss of any kind as a result.

For inquiries please contact a Regional Lands Office.
 Corner Brook - 637-2390
 Gander - 256-1400
 Clarenville - 466-4074
 St. John's - 729-2654
 Goose Bay - 896-2488

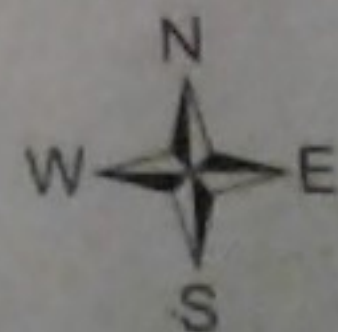

Crown Lands Administration Division

Scale 1:10,000

Compiled on January 23, 2000

