



# Stop Searching:

Curb Stops at Your Fingertips in  
Centreville-Wareham-Trinity



An Interactive Presentation About  
**Municipal Software**  
Designed Just For **You**

# Introduction

- **TownSuite Mapping LITE** is a tool that can make a **BIG** difference.
- Whether you are Administrator/Manager or Operator it can **save** you valuable time, money, and it can **revolutionize** the way you currently manage information, directly impacting the maintenance and repair of your infrastructure.
- If you are a representative of Council it can provide you with the peace of mind to know that your information is preserved.

# Stop Searching ...

- **TownSuite Mapping LITE** gives you the ability to:
  - Manage and maintain critical information about your in-ground infrastructure
  - Eliminate putting your documents at risk by maintaining a digital working copy of your critical information
  - Minimize the time required by personnel to find and manage this information and locate in-ground infrastructure

# What does this mean to **you**?

- You can:
  - Quickly and easily locate your in-ground infrastructure (i.e. valves, curb stops)
  - Keep your as-built drawings up to date by adding notes, photos, spec changes
  - Use your valuable time more efficiently
  - Provide stakeholders with more timely response to leaks or other situations involving in-ground infrastructure

# Minimize Infrastructure **Risks**

- Many drawings are as aged as your infrastructure; they could be
  - Irreplaceable
  - Damaged or illegible
  - Out of date – repairs and maintenance over the years have not been recorded.
- You often have
  - Several copies of the same drawing with varying revision numbers, dates and/or handwritten notes
  - Documents that have completely disappeared

# Minimize Infrastructure **Risks**

- If you have new drawings
  - Keep them in as pristine condition as possible
  - Update digital copies easily with notes on repairs and maintenance that is completed

# Where do we **start**?

- We start with digitizing as-built drawings and plan drawings...

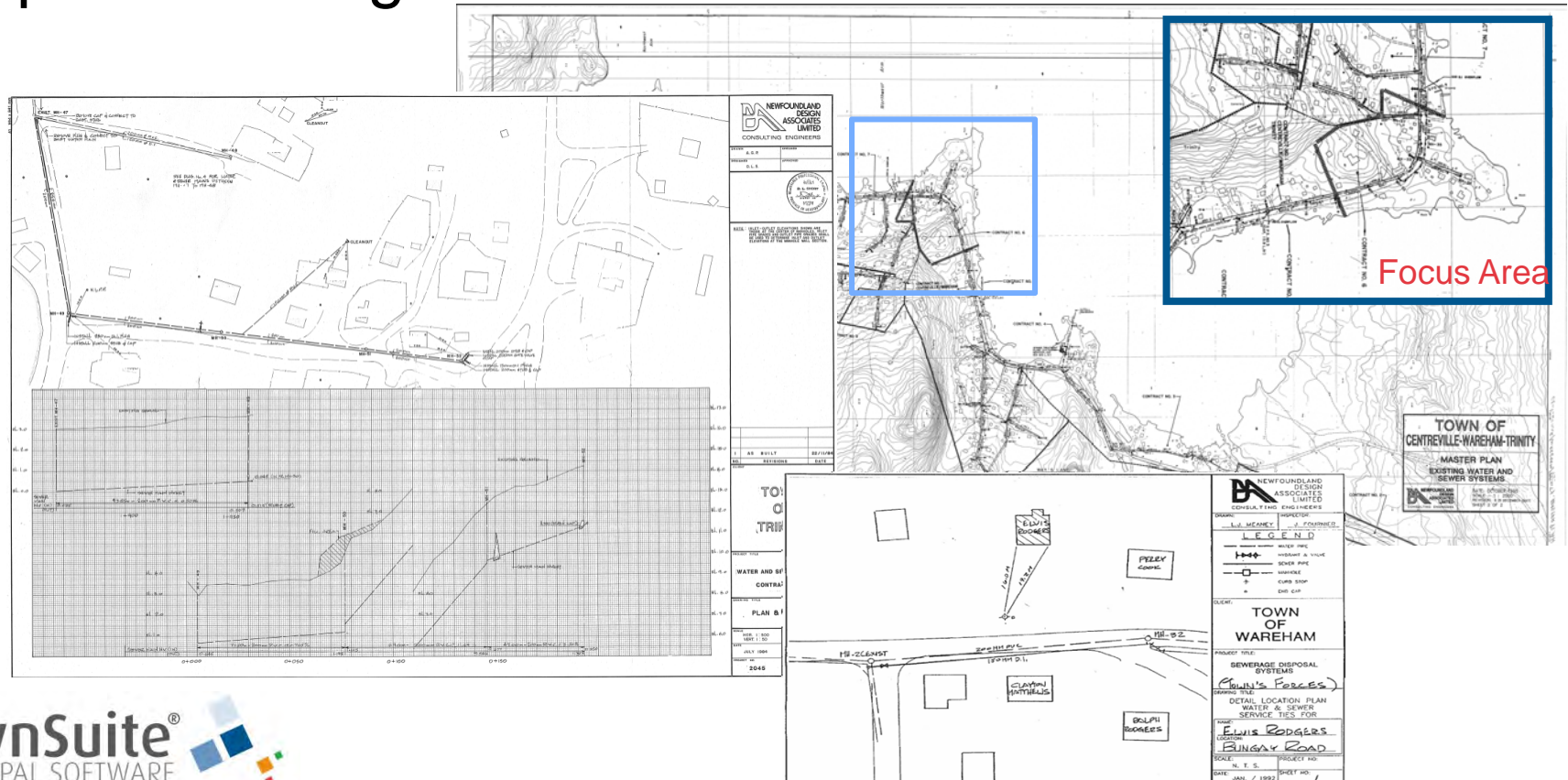



# Where are we now?

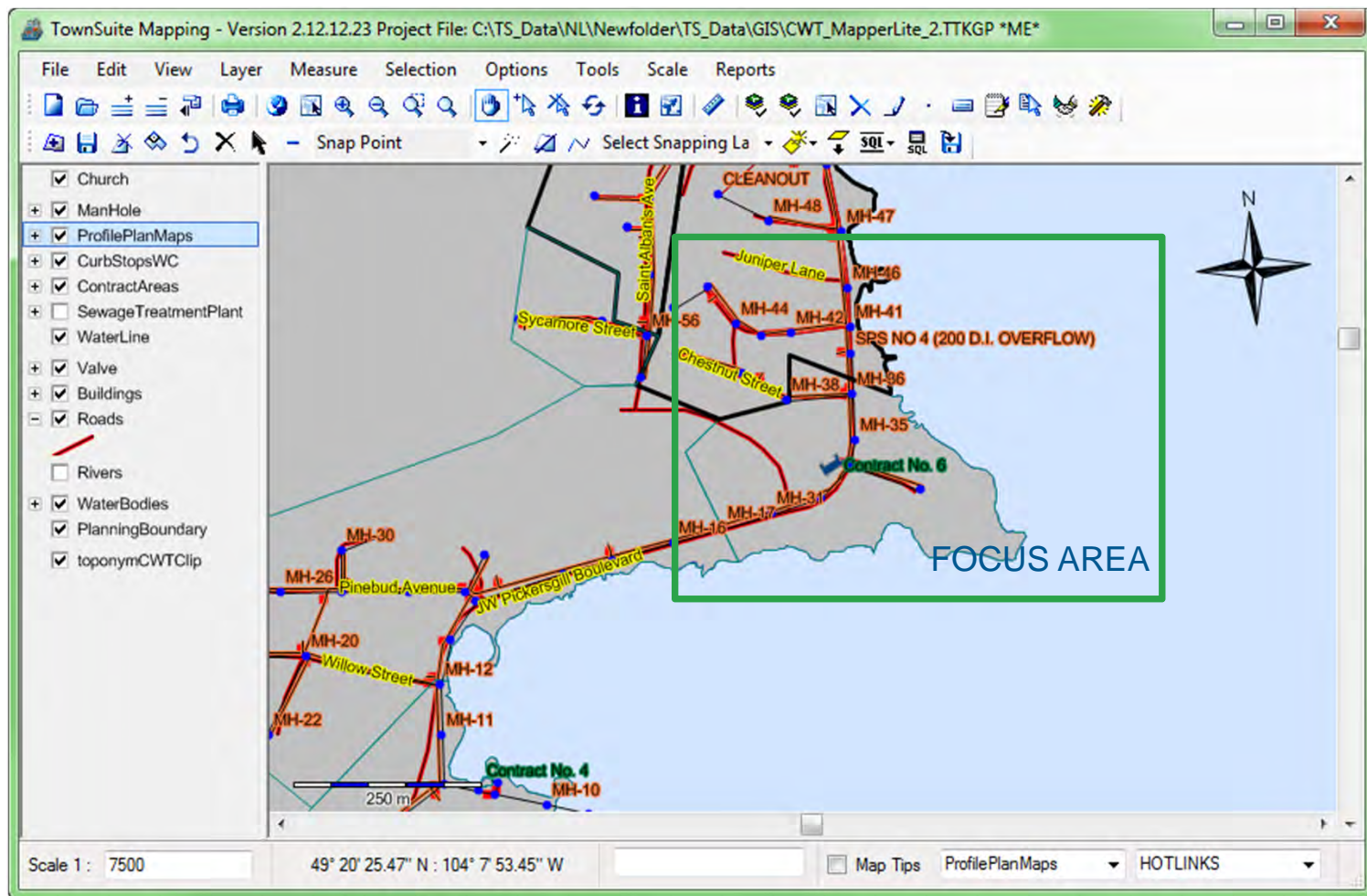



# Click to Access Curb Stop As-Builts

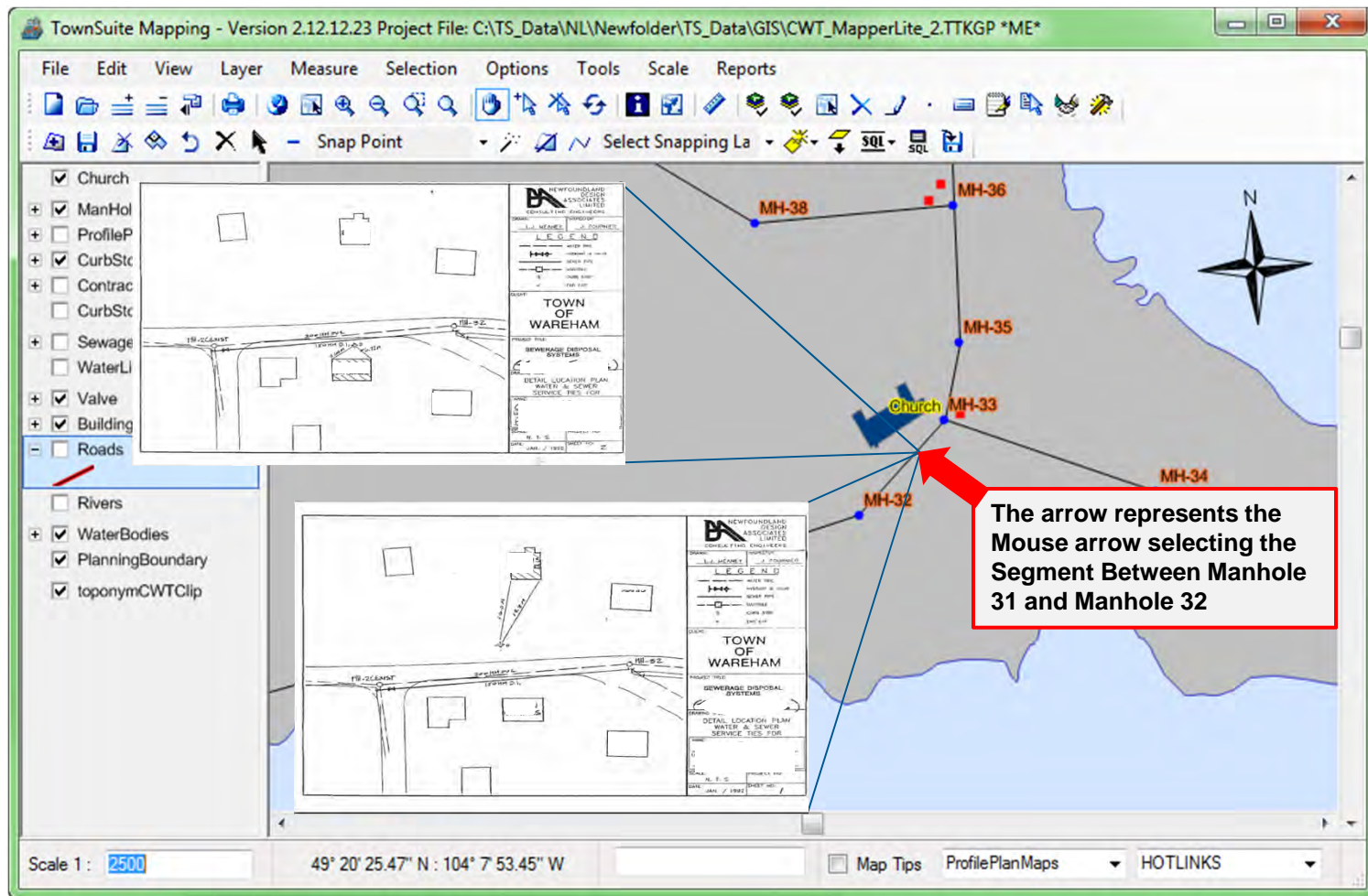

# What if As-Built Specs Change?

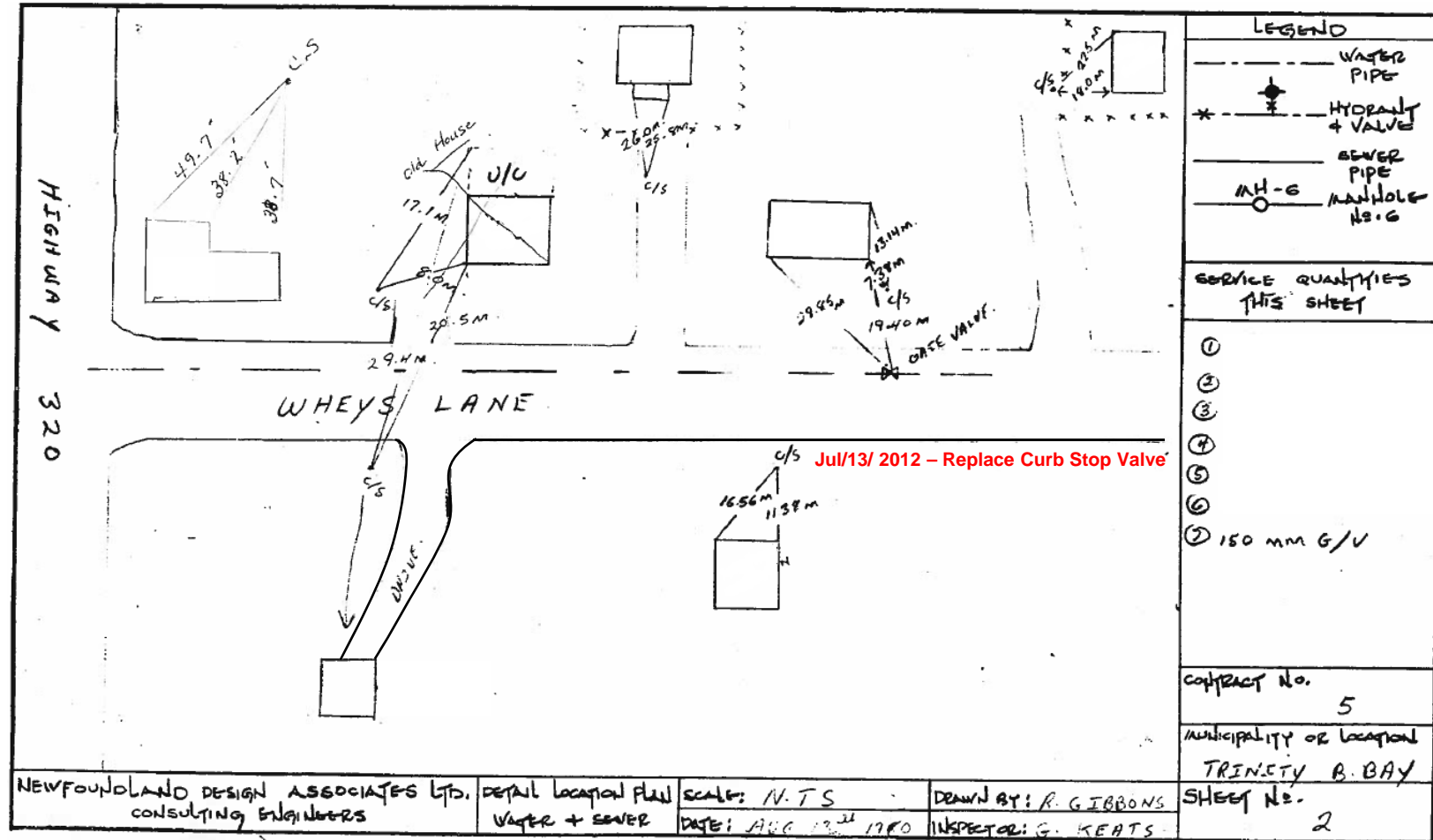

# What if my Documents are Damaged?

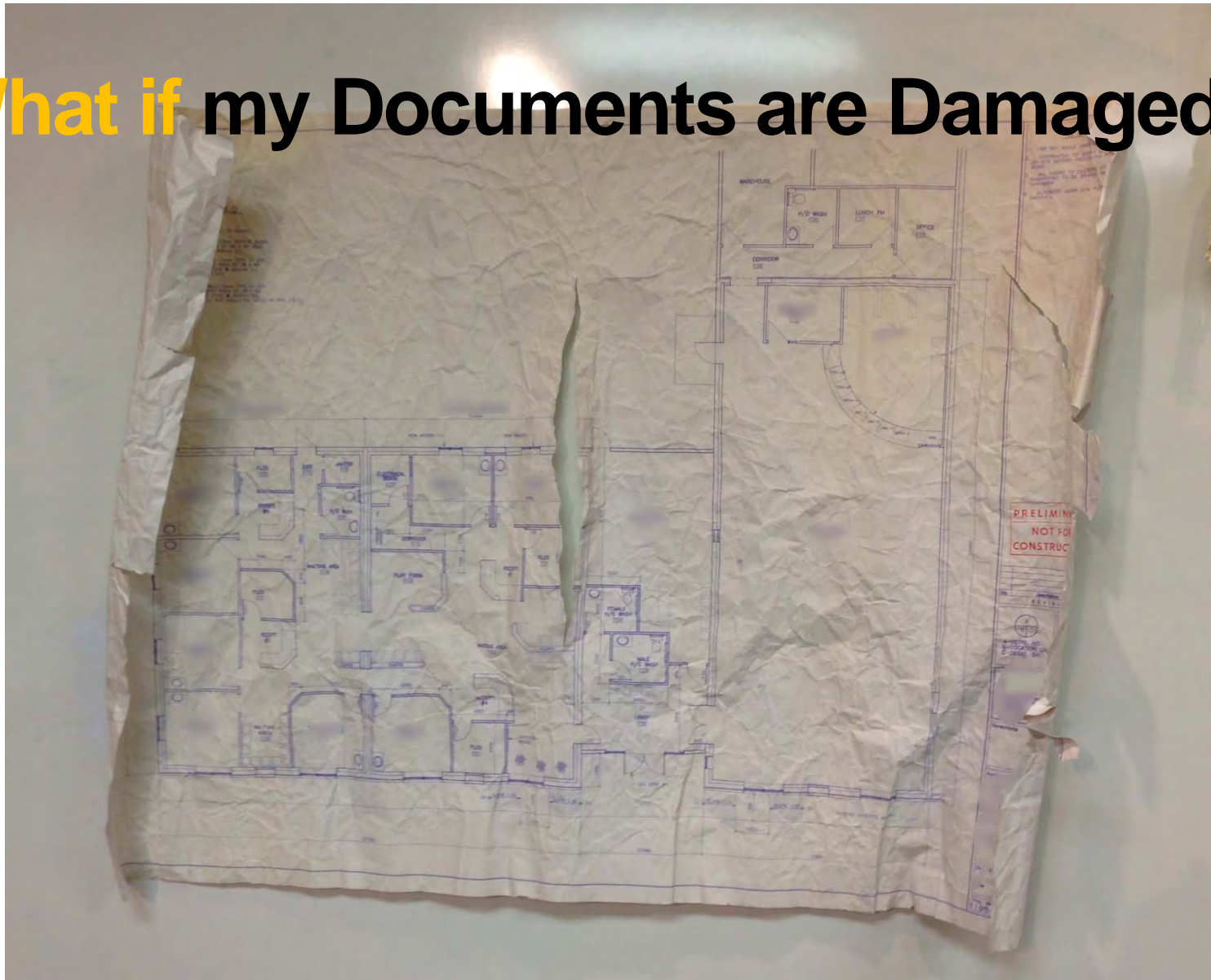

# TownSuite Mapping LITE





# What is it????

**TownSuite Mapping LITE** is a **GIS** based software package designed for the non-technical user.

# What is GIS????

**G** Geographical  
**I** Information  
**S** System **Location**

A system is used to capture, store, analyze, manipulate, manage, and present information. Types of information may include water distribution line information, fire hydrant information, Valve information (including curb-stops), lift stations information.....

# How did we design a GIS for **Centreville-Wareham -Trinity?**

Scanned all small and large format documentation – As built

Created “base map” using data sourced from Federal and Provincial GIS data sets

“Mapped” infrastructure using documentation acquired through the scanning process.

Used the base mapping to attach (or link) information to a location On the map to provide quick and easy access to the information



How did we design a GIS for **Centreville-Wareham -Trinity?**

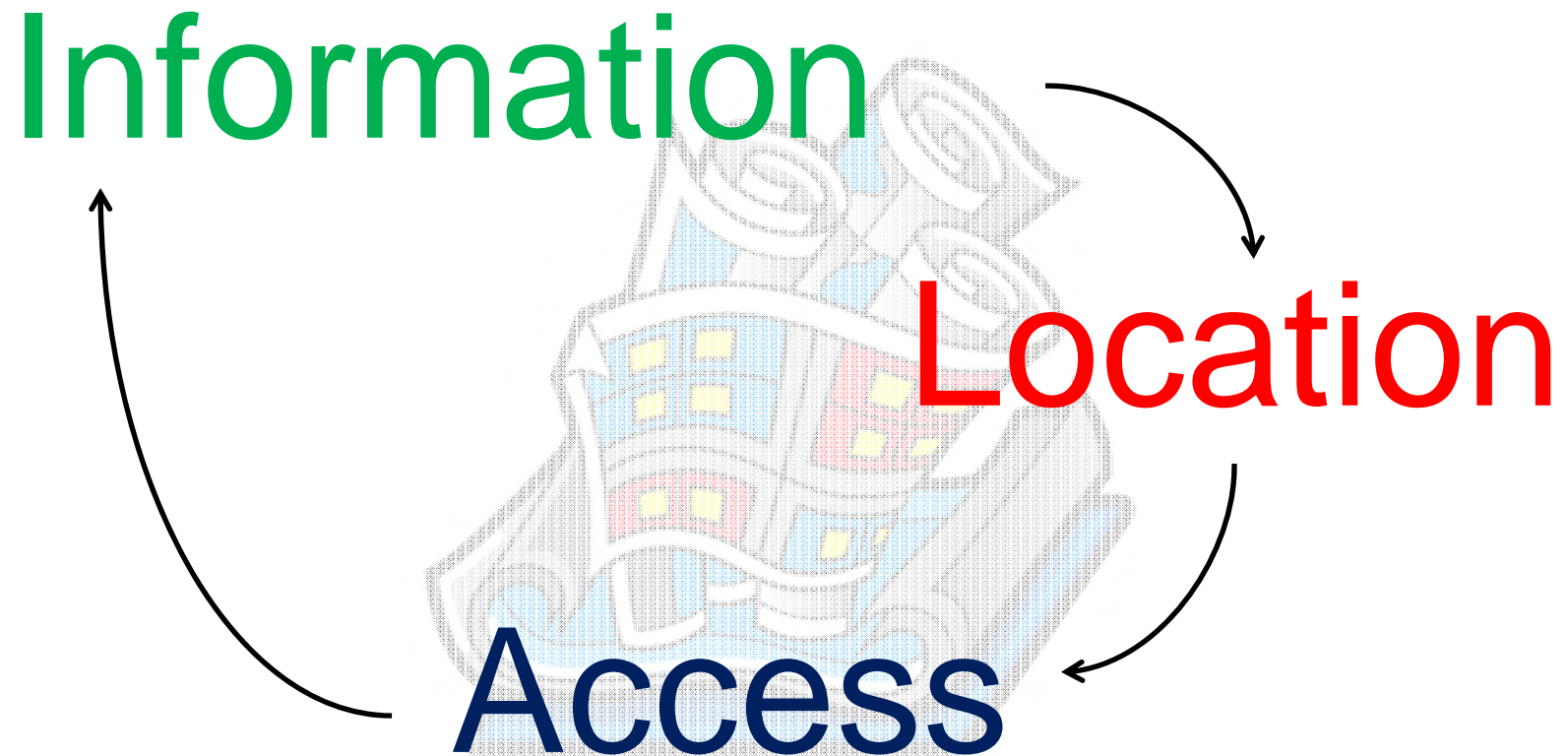

# So What's Next?

- The Town of Centreville-Wareham-Trinity is now working to sort through digitized information, to establish a “**working copy**” of critical information
- **TownSuite Mapping LITE** will enable:
  - Quick access, printing or emailing of information as required for repairs or maintenance, including Curb Stops, Water Line Valves, and Fire Hydrants
  - Update working copy documents with changed as-built specs, notes, and stored maintenance and repair procedures

# Challenge **Resolved**: Council

- Preserve critical documents for future
- Ensure proper tools are in place to manage information and infrastructure, and maximize efficiency of personnel resources

# Challenge **Resolved**: Council

*TownSuite Mapping LITE and the digitization of our drawings gives us peace of mind as community leaders.*

*We can be confident that critical information about our infrastructure is preserved and protected. But we can also rest assured that we have provided an easy to use and innovative tool that enables our administration AND operations, to better manage and quickly access this information and sustain our in-ground infrastructure.*



*Churence Rogers, Mayor  
Town of Centreville-Wareham-Trinity*

# Challenge **Resolved**: Administration

- Keeping critical information up to date
- Access critical information quickly and easily – no more searching for misplaced or missing documents

*TownSuite Mapping LITE makes it so easy to manage our infrastructure information – within minutes I can add or update notes from our Operators on repairs or maintenance that has been completed. I can even add photos of infrastructure to document repairs, or even problems. I can find any drawing they need within seconds and print it right away.*

Michelle Lane, Town Clerk  
Town of Centreville-Wareham-Trinity

# Challenge **Resolved**: Operators

- Can rely on critical information to be current with implementation of proper update procedures
- Easily access required information without the involvement of administration
- All information can be maintained in one place

*This tool will be so valuable to us going forward. We can use it to store repair and maintenance details including measurements and procedures, water test details, or even update specs related to line repairs or relocation. It will be easier to keep our information current, and we won't have any question about whether we have the right information before we start to dig.*



# Did you visit our booth?

- If you didn't get a chance to drop by our booth there are many ways to get more information about **TownSuite Mapping LITE** in Centreville-Wareham-Trinity
  - Talk to us after the presentations
  - We've put a few things in your kit bag that includes our contact information
  - Contact the Town of Centreville-Wareham-Trinity

# What else can **TownSuite** do for you?

- Manage your PSAB 3150 Inventory, including printing Continuity Schedules for your audit
- Accounting and financial management, including property taxes, utilities, budgeting and budget forecasting

<b>FINANCIAL</b> Full – featured accounting and financial management.	<b>MAPPING</b> Intuitive, affordable, organization wide GIS.	<b>PLANNING</b> Seamless, parcel-centric, foolproof tools.
<b>FIRE HALL</b> Effortless pre-planning and response management.	<b>TCA</b> Asset management made easy.	<b>WEB SERVICES</b> Connect to your community.

# Questions?

**Thank you for attending our presentation**

Get **TownSuite Working** for **YOU**

1.800.408.3313

Suite 101, 216 Airport Blvd, Gander

[townsuite@wheygroup.com](mailto:townsuite@wheygroup.com)

[www.townsuite.com](http://www.townsuite.com)