



**Newfoundland
Labrador**
Department of Environment,
Climate Change, and Municipalities

Climate Change Flood Risk Map Study Hummer River Communities

FloodExtent Map
Current Climate and
Fully Developed Condition

Hummer River
Hummer Resort Watercourses

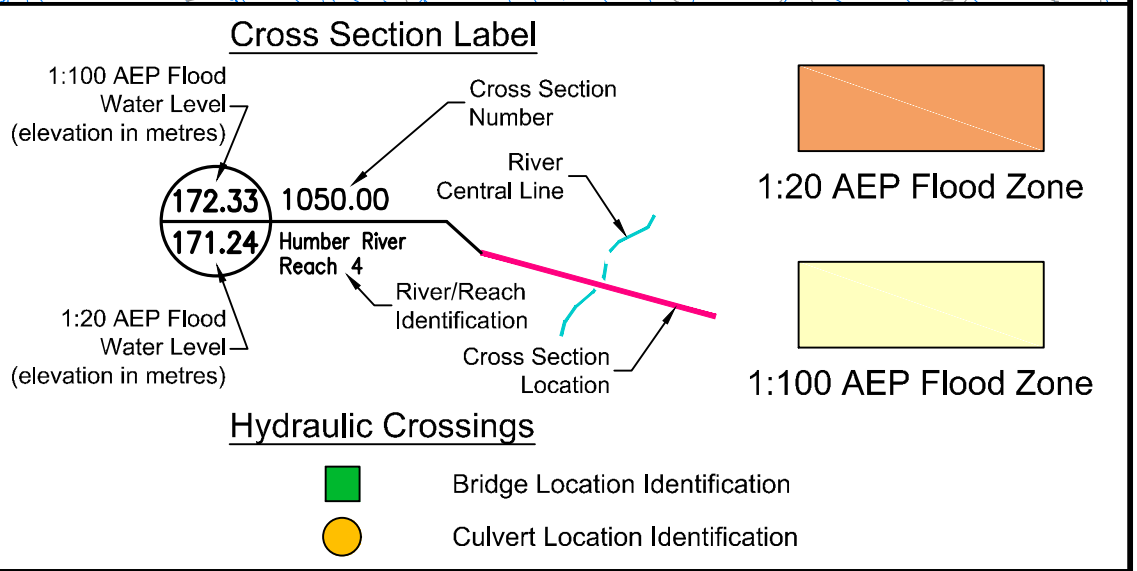
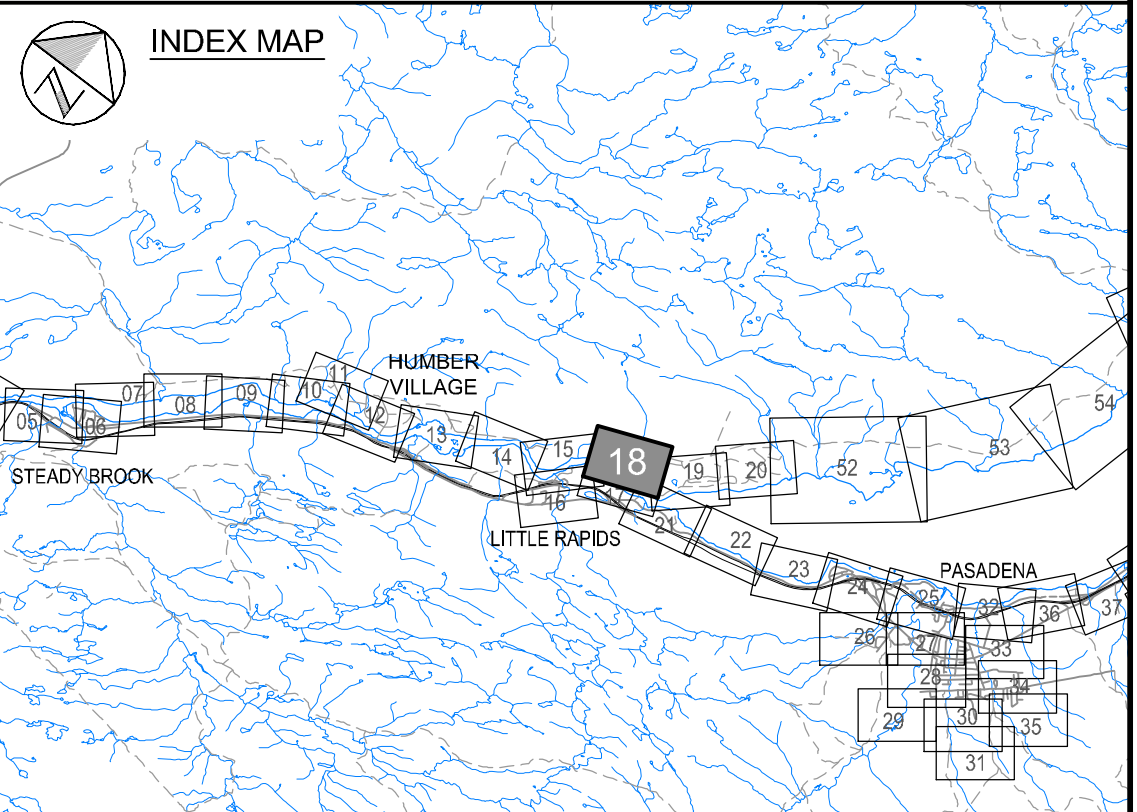

wood.

Please note that the Professional Engineer's stamp verifies the flood line and associated data, not the map unless otherwise noted.

R E V I S I O N S			
No.	Description	BY	DATE

Sheet 18 of 90

MTMNAD83
ZONE 3

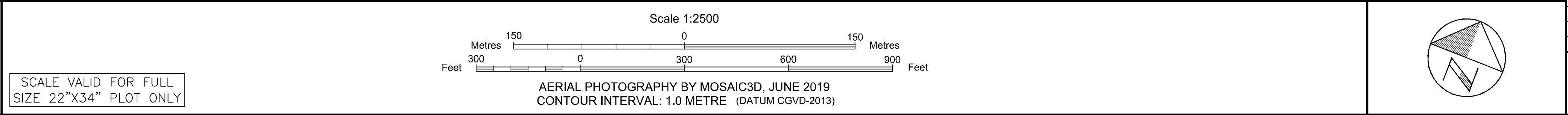

I:\TPP188156 - Hummer\06_DES-ENG\01_CAD\02_DWG\05_WF\01_PROJ\FloodMaps\Future VZM-CGFD\TPP188156-FZM-CGFD-CM2.dwg