

Newfoundland  
Labrador  
Department of Environment,  
Climate Change, and Municipalities

## Climate Change Flood Risk Map Study Humber River Communities

### Flood Extent Map Climate Change and Fully Developed Condition

South Brook

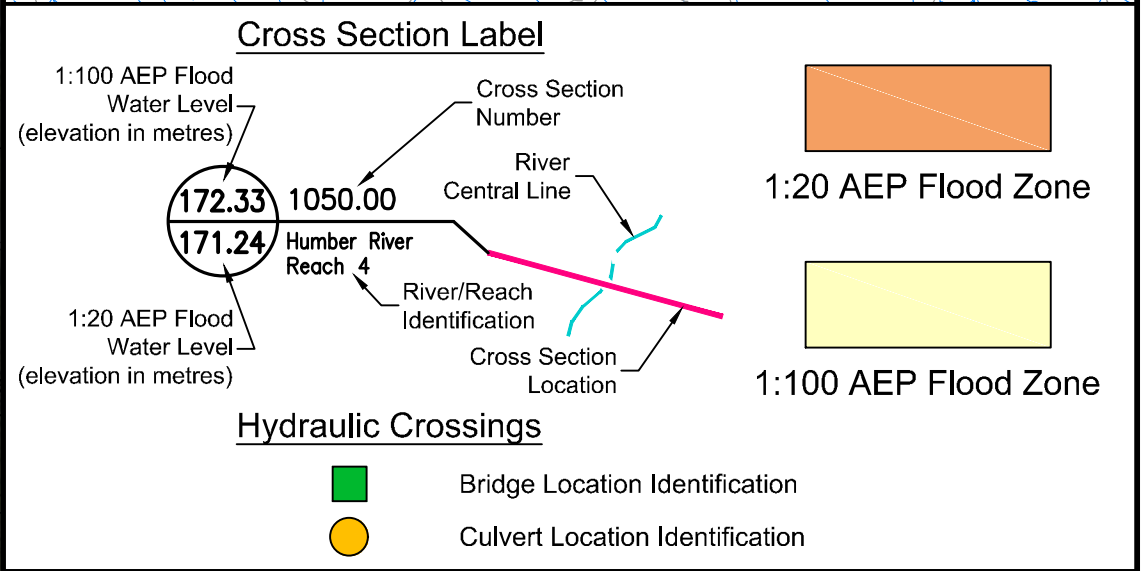
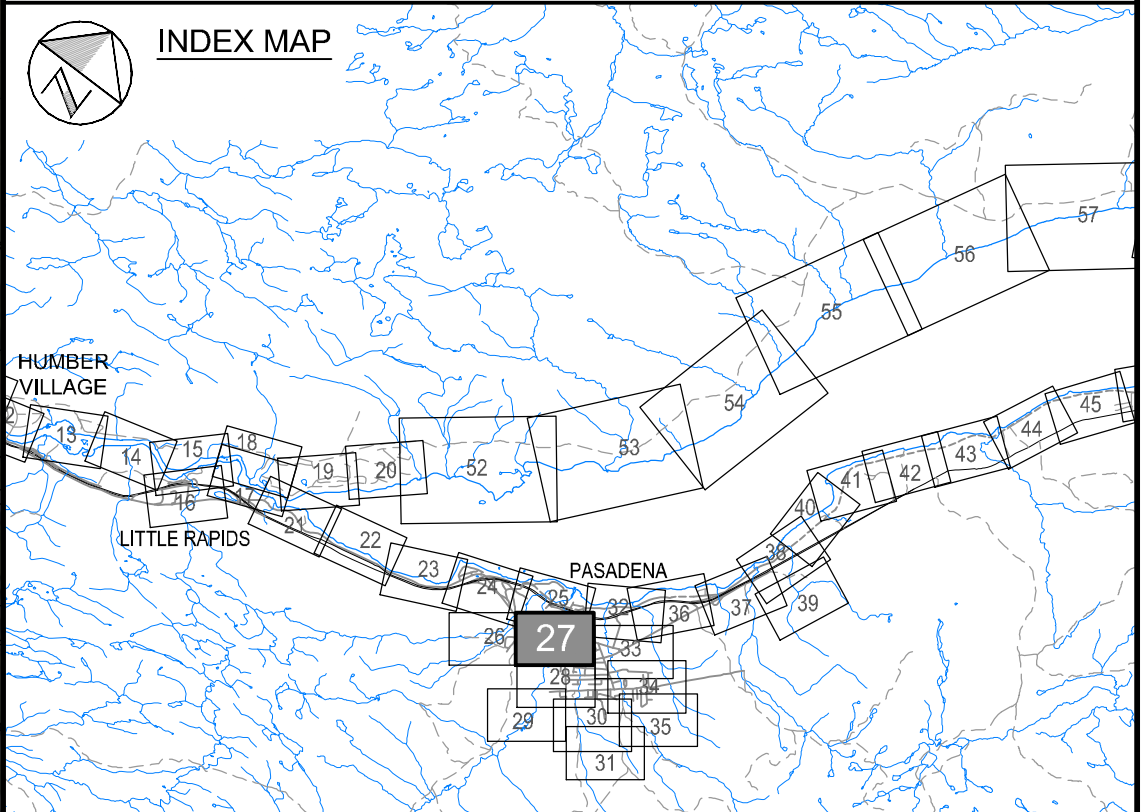

**wood.**

Please note that the Professional Engineer's stamp verifies the flood line and associated data, not the map unless otherwise noted.

REVISIONS			
No.	Description	BY	DATE