

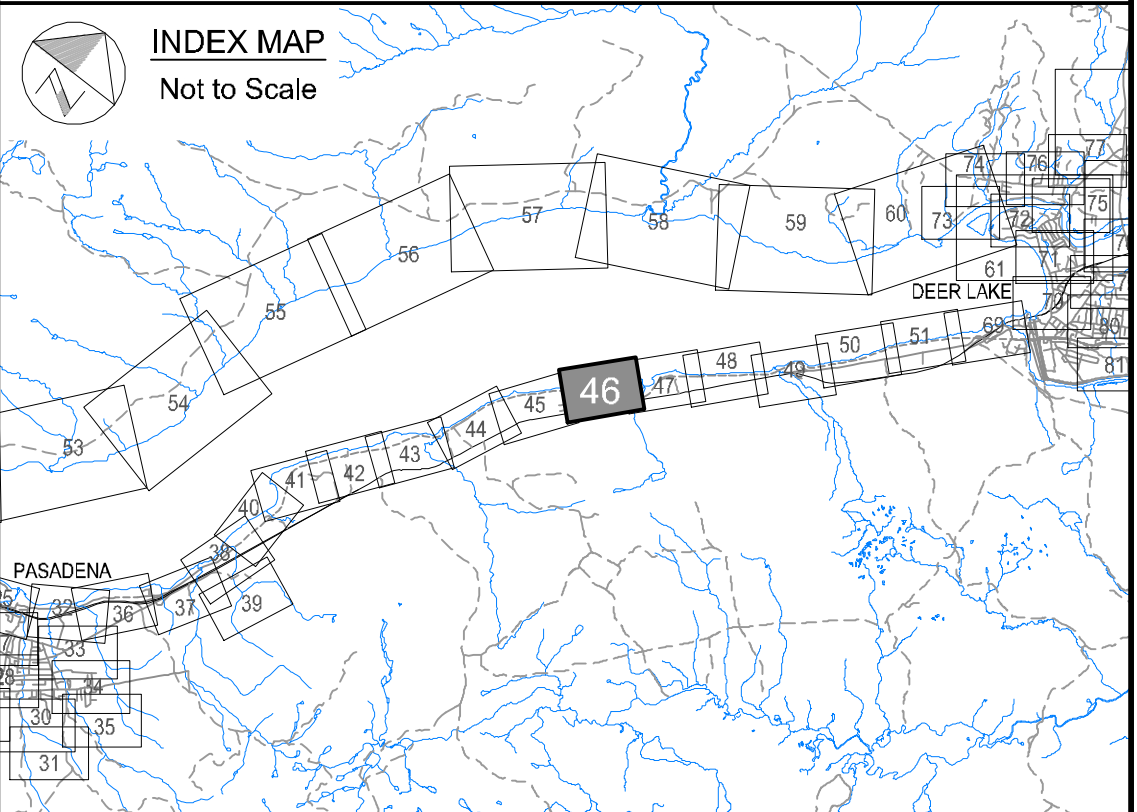

Newfoundland
Labrador
Department of Environment,
Climate Change, and Municipalities
Climate Change
Flood Risk Map Study
Humber River Communities

1:20 AEP Inundation Depth Mapping
Current Climate and
Current Development Condition
Deer Lake



Cross Section Label

1050.00
Humber River
Reach 4
River/Reach
Identification

Cross Section
Number

River
Central Line

Cross Section
Location

1:20 AEP Inundation Depth

- 0.0 m - 0.5 m
- 0.5 m - 1.0 m
- 1.0 m - 1.5 m
- 1.5 m - 2.0 m
- Greater than 2.0 m

Hydraulic Crossings

- Bridge Location Identification
- Culvert Location Identification

wood.

Please note that the Professional Engineer's stamp verifies the flood line and associated data, not the map unless otherwise noted.

R E V I S I O N S			
No.	Description	BY	DATE

Sheet 46 of 90

I:\TPB188156 - Humber\06_DES-ENG\01_CAD\02_DWG\05_WF\01_PROJ\FloodMaps\BoseCase\FDM-CCCD\TPB188156-FDM-CCCD-20AEP-CM4.dwg

MTMNAD83
ZONE 3

SCALE VALID FOR FULL
SIZE 22"x34" PLOT ONLY

Scale 1:2500

Metres

300 0 300 600 900

Feet

Metres

150 0 150

Feet

AERIAL PHOTOGRAPHY BY MOSAIC3D, JUNE 9th-14th 2019
CONTOUR INTERVAL: 1.0 METRE (DATUM CGVD-2013)