

AUXILIARY VIEW

SECTION B-B

SECTION C-C

AUXILIARY VIEW

TYPE A

TYPE B

RECTANGULAR ALUMINUM

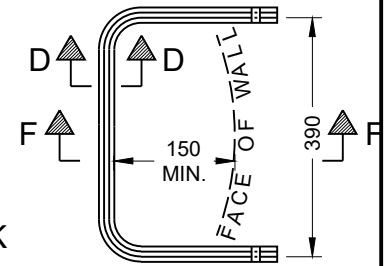
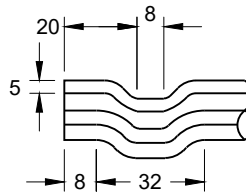
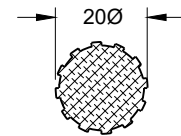
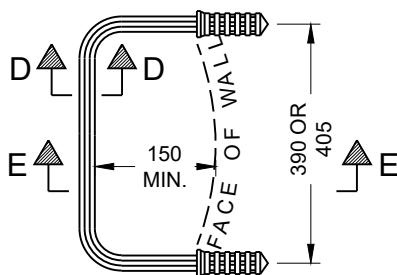

TYPE A - PLAN

SECTION D-D

FORMED ANCHOR LOCK
DETAIL

TYPE B - PLAN

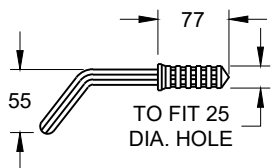

POLYETHYLENE ANCHOR
INSULATING SLEEVE, TYP

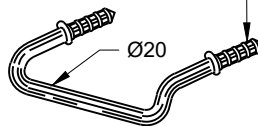

SEE FORMED ANCHOR
LOCK DETAIL

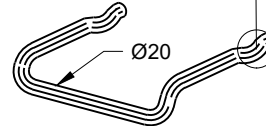

SECTION E-E

AUXILIARY VIEW

AUXILIARY VIEW

SECTION F-F

TYPE A

TYPE B

CIRCULAR ALUMINUM

NOTES:

1. ALL ALUMINUM COMPONENTS SHALL BE 6000 SERIES STRUCTURAL ALUMINUM.
2. ALL ALUMINUM IN CONTACT WITH CONCRETE SHALL BE THOROUGHLY COATED WITH ASPHALT PAINT.
3. STEPS CAN BE CAST IN PLACE DURING CASTING OF THE MAINTENANCE HOLE, OR MECHANICALLY FASTENED (CAN/CSA 257.4-03) AFTER MAINTENANCE HOLE IS CONSTRUCTED.
4. ALL DIMENSIONS ARE IN MILLIMETERS UNLESS OTHERWISE NOTED.