

PLAN

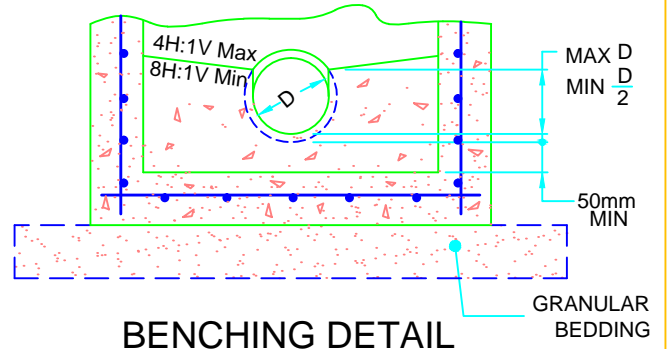

BENCHING DETAIL

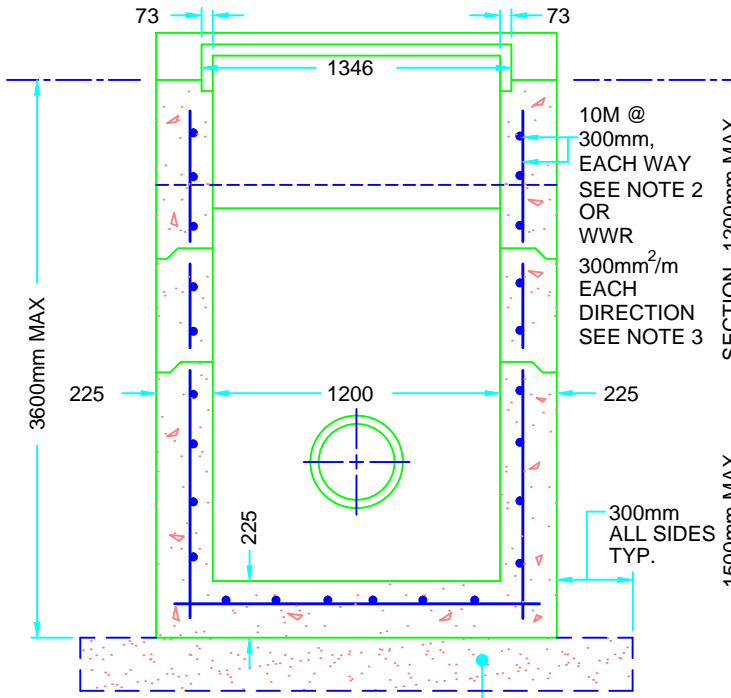

SECTION A-A

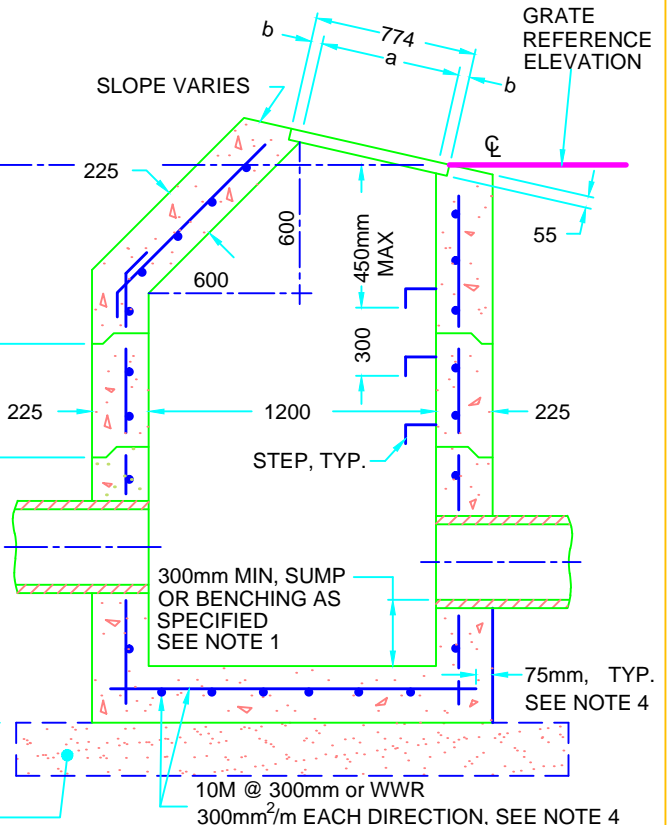

SECTION B-B

NOTES:

1. THE SUMP IS MEASURED FROM THE LOWEST INVERT. BENCHING AS SHOWN IN BENCHING DETAIL.
2. LAP HORIZONTAL 10M REBAR 300mm. LAPS SHALL BE PLACED AT CORNERS.
3. LAP HORIZONTAL WIRES 300mm OR WELD. WELDS TO DEVELOP 75% OF YIELD STRENGTH OF WIRE. LAPS OR WELDS SHALL BE PLACED AT CORNERS.
4. END REBAR OR WWR IN BASE 75mm FROM OUTSIDE FACE OF WALL.
5. WHERE INLET IS PLACED ACROSS DITCH AND IS ACCESSIBLE TO VEHICULAR TRAFFIC, GRATING SLOPE SHALL BE 6H:1V OR FLATTER.
6. GRANULAR BACKFILL SHALL BE PLACED A MINIMUM THICKNESS OF 300mm ALL AROUND THE DITCH INLET MANHOLE.
7. CONCRETE FOR BENCHING SHALL BE 30MPa.
8. BENCHING SLOPE AND HEIGHT SHALL BE AS SPECIFIED.
9. GRATING SHALL BE ACCORDING TO STANDARD DRAWING 04410.
10. STEPS SHALL BE ACCORDING TO STANDARD DRAWING 04280.
11. MAXIMUM PIPE SIZE: STRAIGHT THROUGH - 1200mm DIA; RIGHT ANGLE PIPES - 700mm DIA.
12. PIPE SUPPORT SHALL BE ACCORDING TO STANDARD DRAWING 04260.
13. CENTER REINFORCING IN WALLS ± 35 mm. ALL OTHER REINFORCING SHALL HAVE A MINIMUM COVER OF 25mm.
14. ALL DIMENSIONS ARE NOMINAL.
15. ALL DIMENSIONS ARE IN MILLIMETERS UNLESS OTHERWISE SHOWN.

OPENING DIMENSIONS			
TYPE	GRATE	a	b
	SLOPE		
B	2H:1V	670	52
	3H:1V	632	71
	4H:1V	618	78
	6H:1V	608	83
	HOR	600	87

MASTER SPECIFICATIONS

PRECAST CONCRETE DITCH INLET MAINTENANCE HOLE - TYPE A (1200 x 1200mm)

DRAWING NUMBER 04370

DATE: MARCH 2016
SCALE: N.T.S.